

Front Elevation

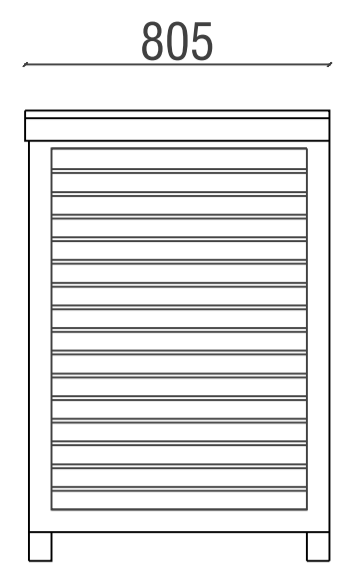

Side Elevation

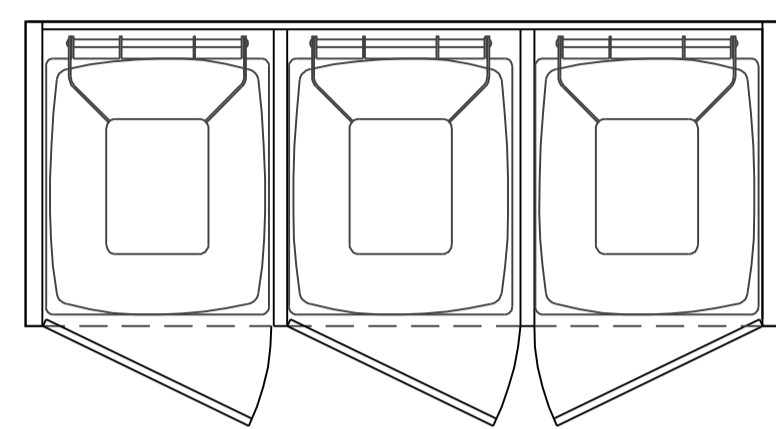

Floor Plan

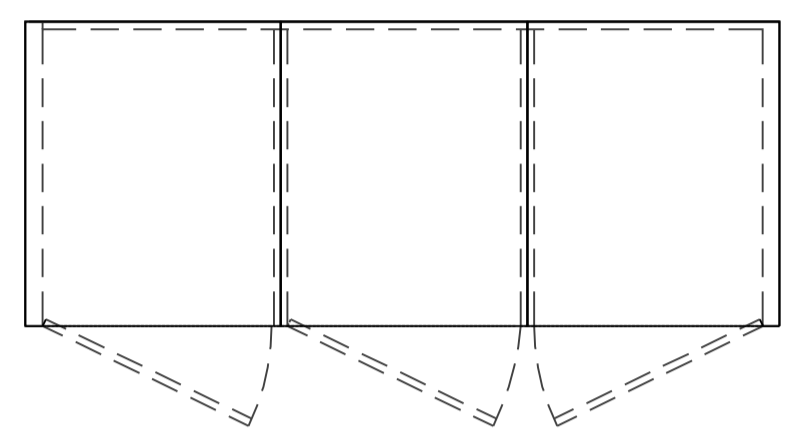

Roof Plan

BIN STORE

proposed | 1:20@A1

Treated timber bin store
Slatted design features gaps to provide ventilation.

Side hinged front doors included sliding bolts. Top hinged lids with securing chains included. Timber slats to the front and both sides with narrow gaps.

CYCLE STORE

proposed | 1:20@A1

Treated timber cycle store
can hold 2 x bikes and 2 kids bikes.
The roof is felted and the
timber cycle store has a fitted floor
with wide opening doors.

Cycle store to comply with the requirements set in the London Cycling Design Standards.

- The cycle stores will be:
- Provided with a secure lock and a rack allowing both the frame and at least one wheel to be secured
 - Well located: close to the entrance of the property and avoiding obstacles
 - Covered
 - Fully accessible, for parking all types of cycle
 - Adequately lit, with convenient access to the street, visible and fit for purpose.

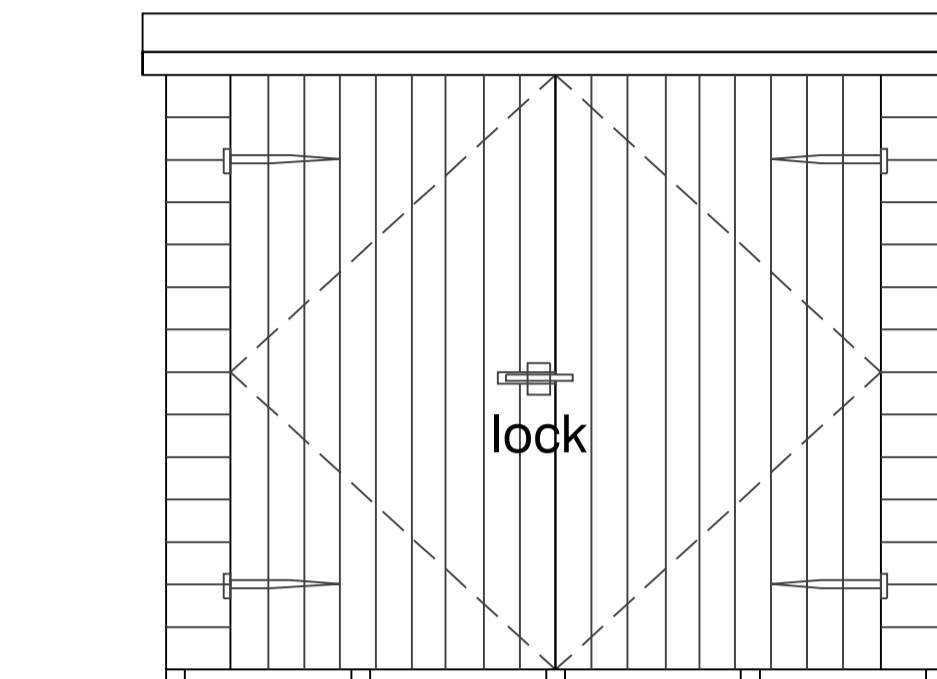

Front Elevation

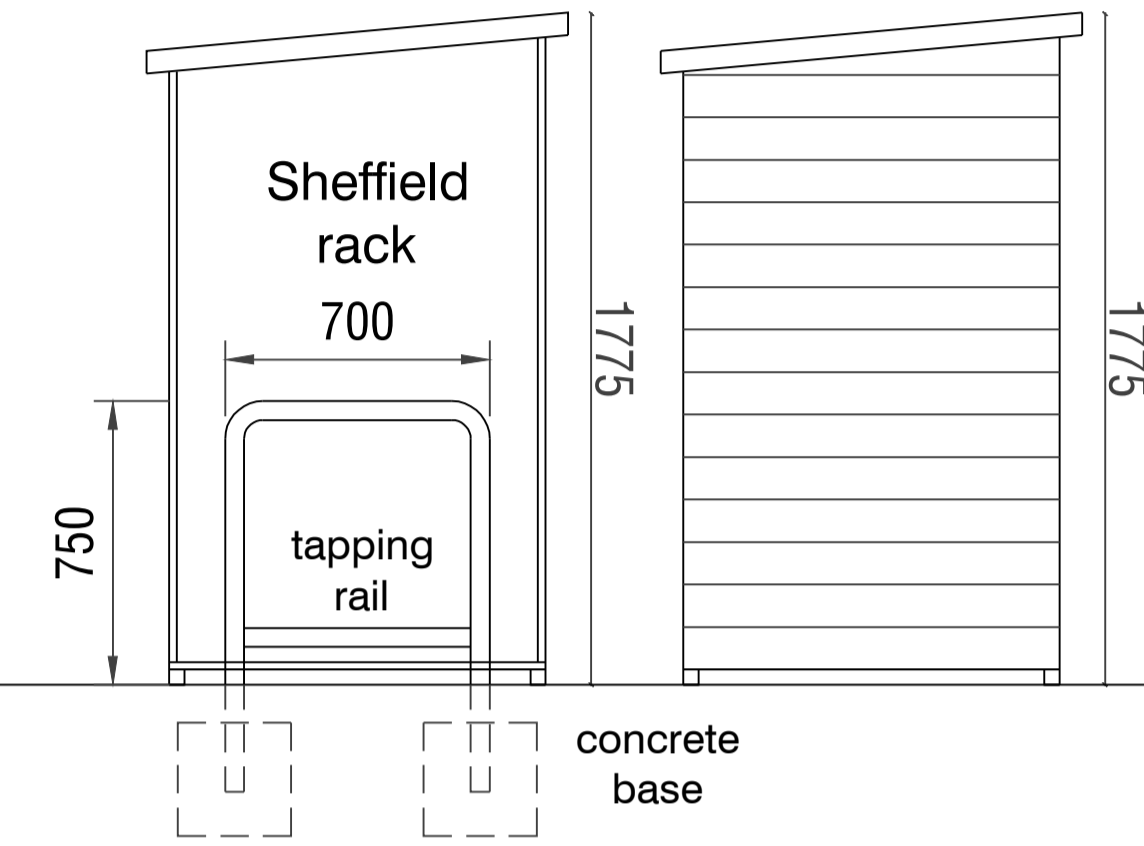

Section

Side Elevation

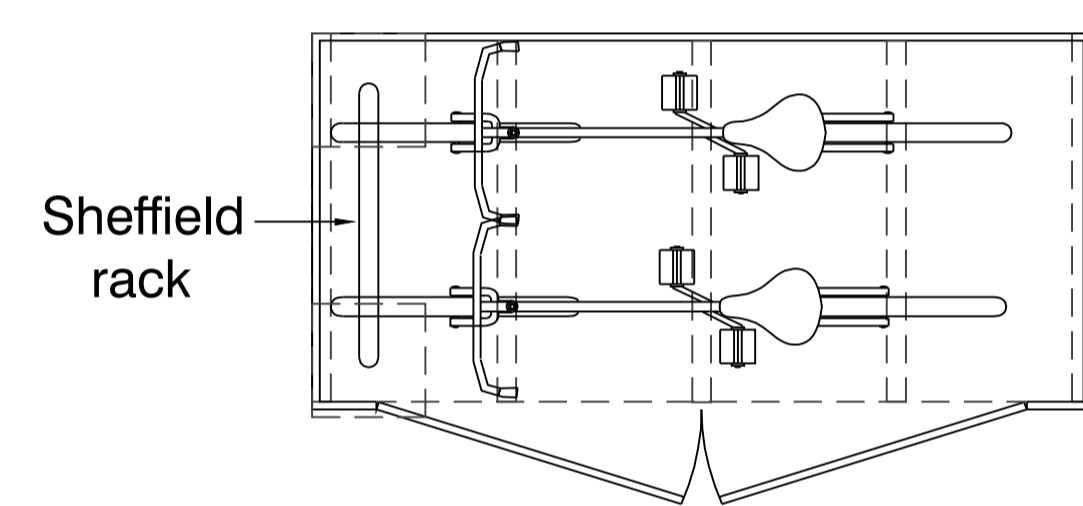

Floor Plan

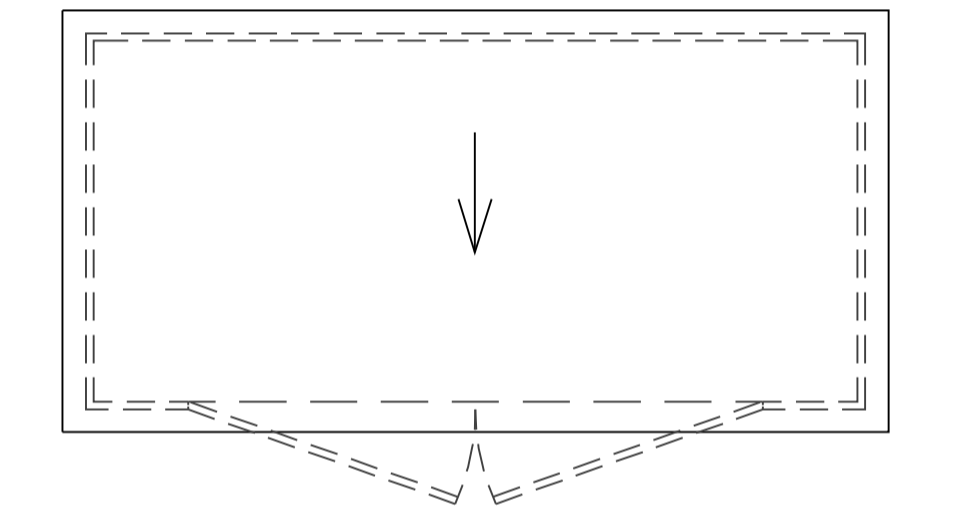

Roof Plan

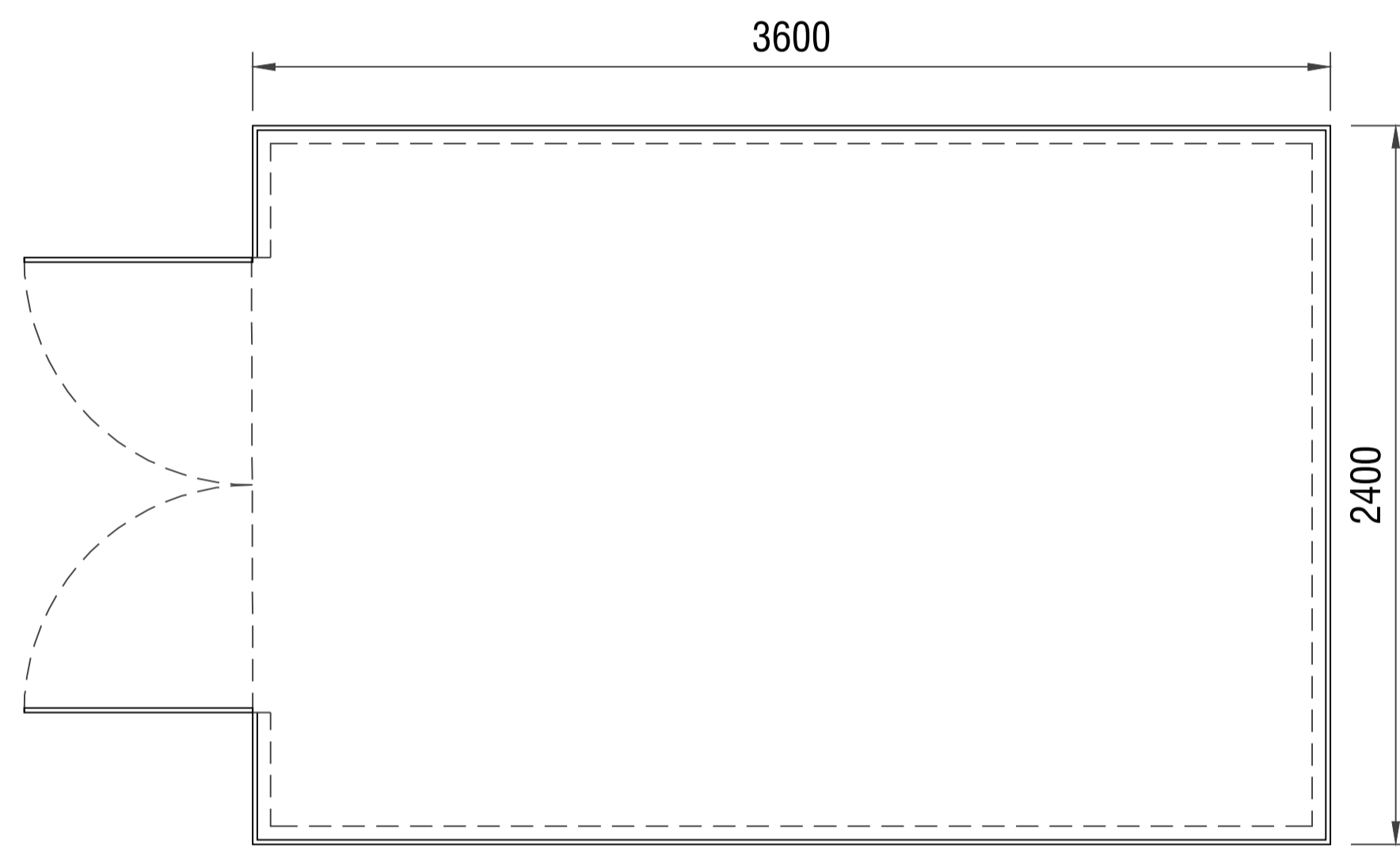

Floor Plan

STORAGE SHED

proposed | 1:20@A1

Cladding 15mm Tongue & Groove Shiplap
Frame 34mm x 45mm Timbers
Windows Fully framed with 3mm horticultural glass beaded from the outside.

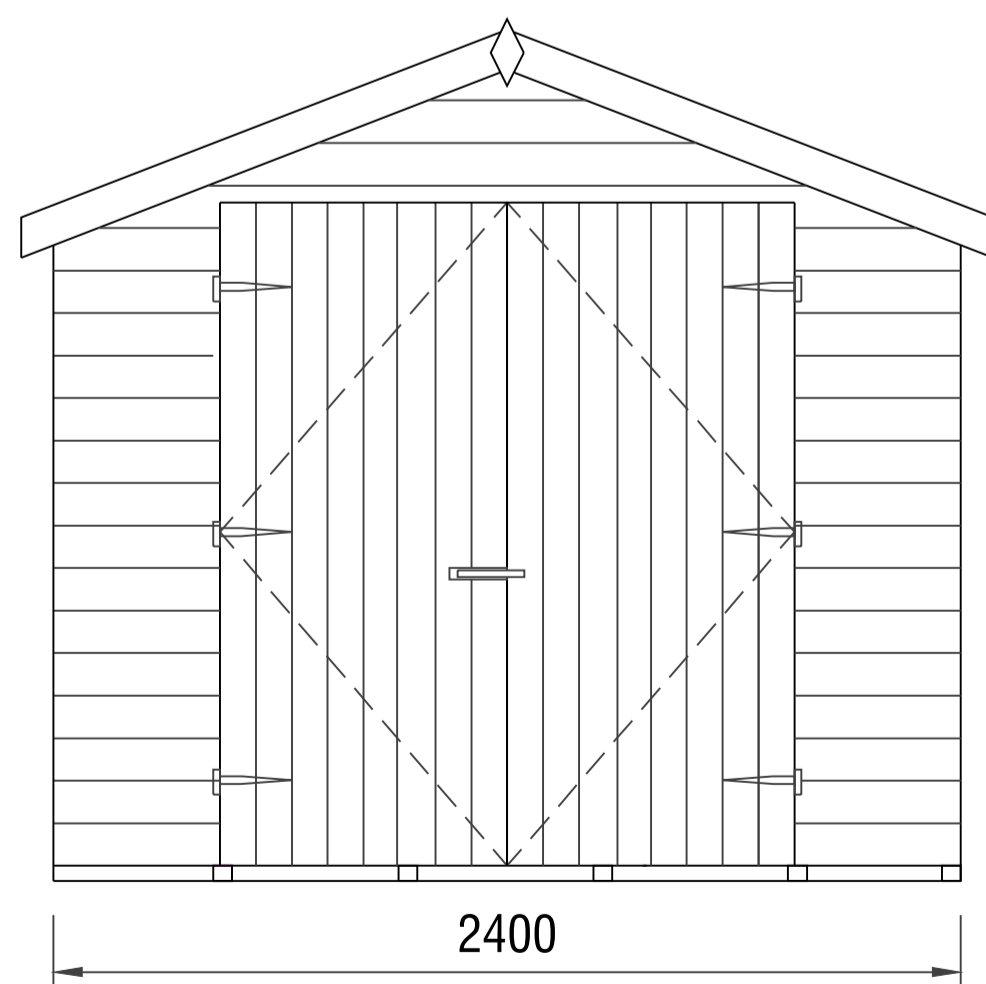

Front Elevation

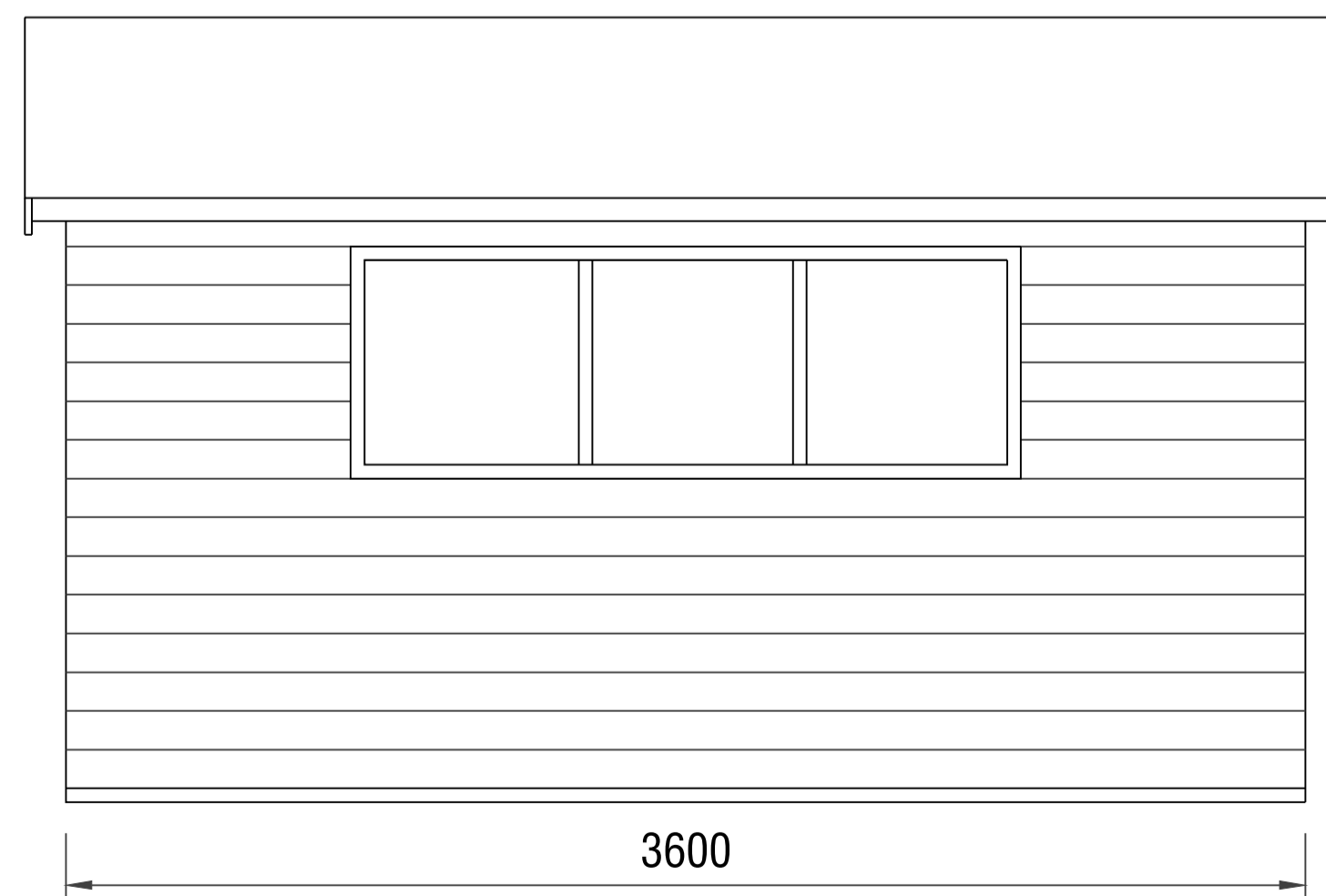

Side Elevation

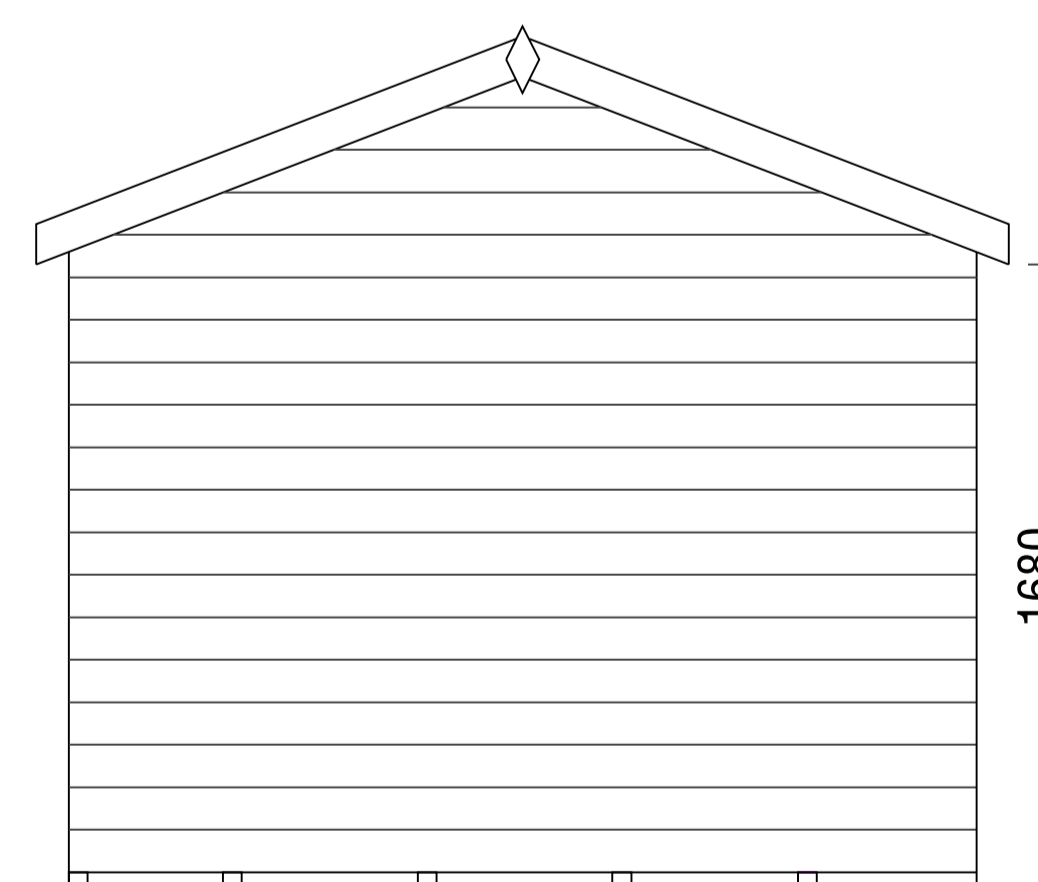

Rear Elevation

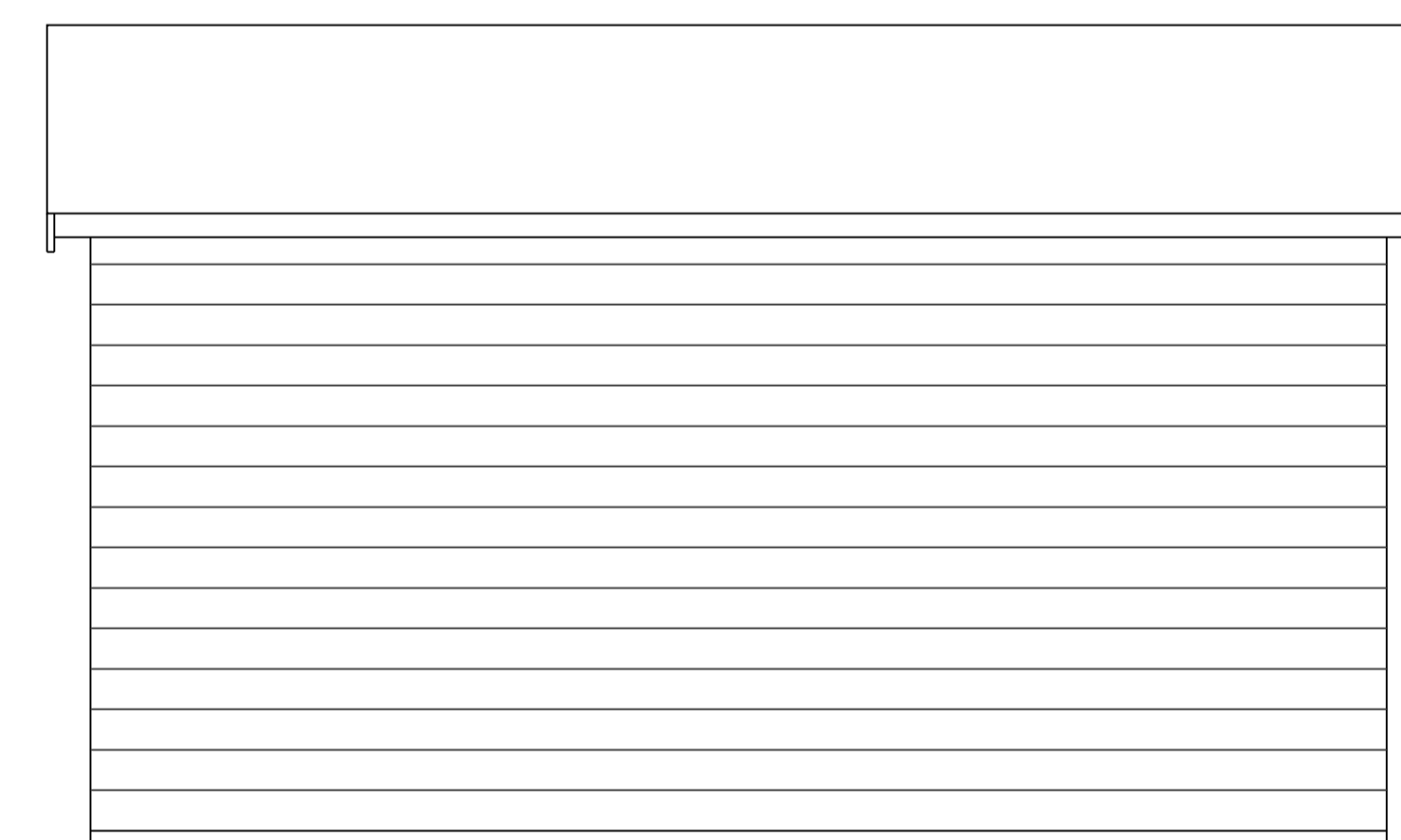

Side Elevation

notes:
any discrepancies should be reported immediately
all dimensions should be checked on site prior to commencement of work
site/survey based on ordnance survey information provided by prodact systems plc. (www.promap.co.uk) prodact does not guarantee that all past or current uses or features will be identified in the product
the product does not give details about the actual state or condition of the site nor should it be used or taken to indicate or exclude actual suitability or unsuitability of the site for any particular purpose, or relied upon for determining salability or value, or used as a substitute for any physical investigation or inspection.
drawings to be read in accordance with the dwelling emission rate (der/ter) calculation. the building must be built 'as designed' meeting the criteria set for air permeability.
© HERTFORD PLANNING SERVICE
note
when printing off pdfs.
it is the responsibility of the user to verify that the resulting prints are to scale on the appropriate sized sheet.
also that the scale bars on the plan measure correctly.

Date	Description	Rev



Westgate House, 37-41 Castle Street,
Hertford, Herts SG14 1HH
Tel: 01992 552173
Email: contact@hertfordplanning.co.uk
www.hertfordplanning.co.uk



Description
Project 12 Spring Court
Enfield
EN2 8JP
Drawing Shed, Bins and Cycle stores

Date 12/01/2024
Scale 1:50
Sheet size A1
Drawn mRn

20742-P308-1st

1:2500	0	1	50m	100m	200m
1:1250	0	5	25m	50m	100m
1:500	0	10	10m	20m	40m
1:200	0	20	4m	8m	16m
1:100	0	40	2m	4m	8m
1:50	0	80	1m	2m	4m