

Key

- Existing retained construction
- New construction / infill
- Existing foul drain run
- New foul drain run
See regs spec note 18.0
- New surface drain run
See regs spec note 19.0
- Demolitions

NB: Existing external cavity wall width TBC on site, currently assumed at 50mm.

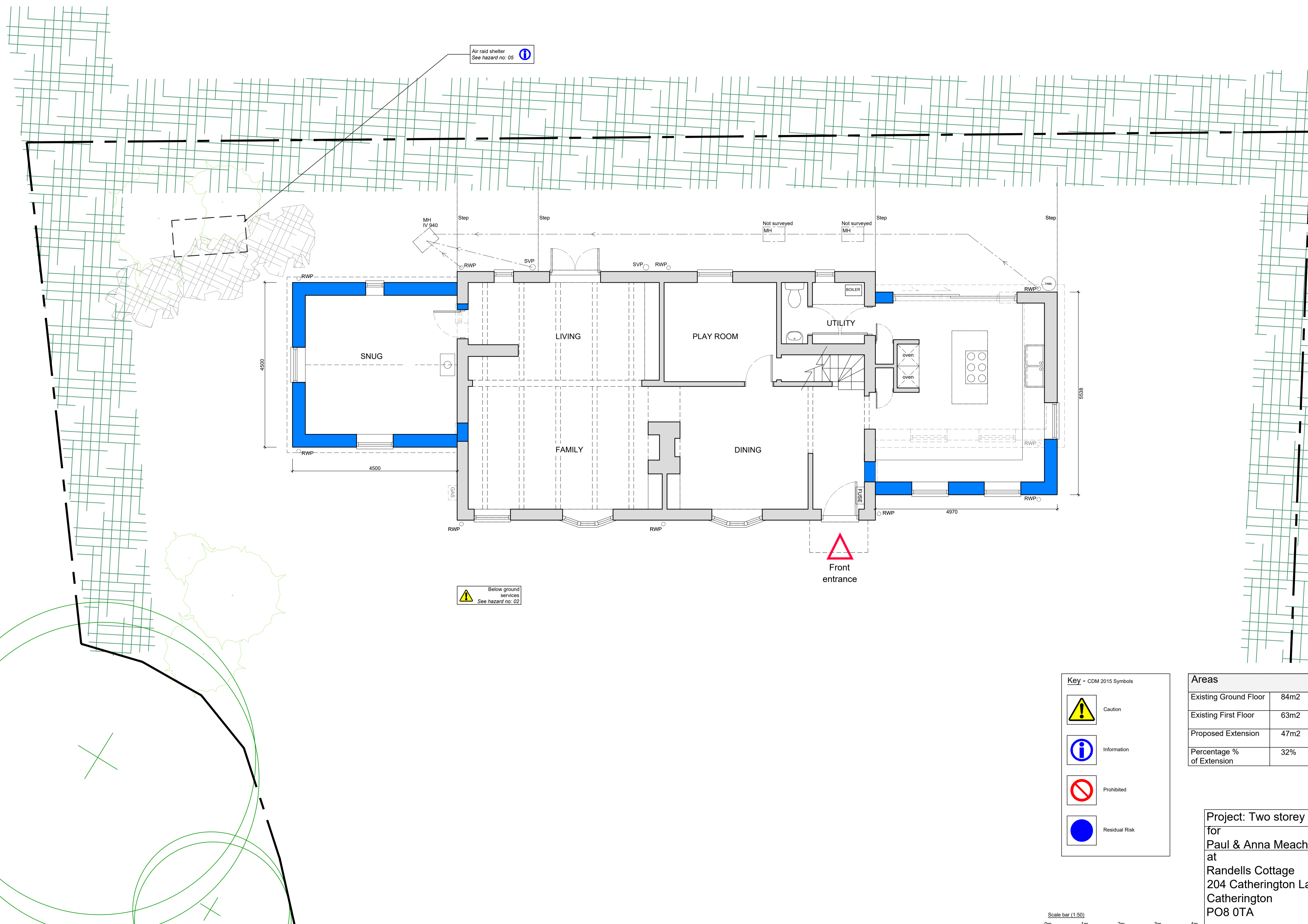

Below ground services
See hazard no: 02

Air raid shelter
See hazard no: 05

Key - CDM 2015 Symbols

- Caution
- Information
- Prohibited
- Residual Risk

Areas	
Existing Ground Floor	84m ²
Existing First Floor	63m ²
Proposed Extension	47m ²
Percentage % of Extension	32%

Rev.	Description	Date
Revisions		

Project: Two storey side extension
for
Paul & Anna Meacher
at
Randells Cottage
204 Catherington Lane
Catherington
PO8 0TA

Contact: [Michael Austin RIBA](mailto:Michael.Austin@riba.co.uk)
E-mail: project@austinlebbon.co.uk
Web: www.austinlebbon.co.uk
Phone: 01730 887559

Dwg Ref: 2248 [PL] 01 Rev: - Date: FEB 2024



Proposed Ground Floor Plan
Scale 1:50 @ A1