







| Key | |
|---|--|
|  | Existing retained construction |
|  | New construction / infill |
|  | Existing foul drain run |
|  | New foul drain run See regs spec note 18.0 |
|  | New surface drain run See regs spec note 19.0 |
|  | Demolitions |

NB: Existing external cavity wall width TBC on site, currently assumed at 50mm.

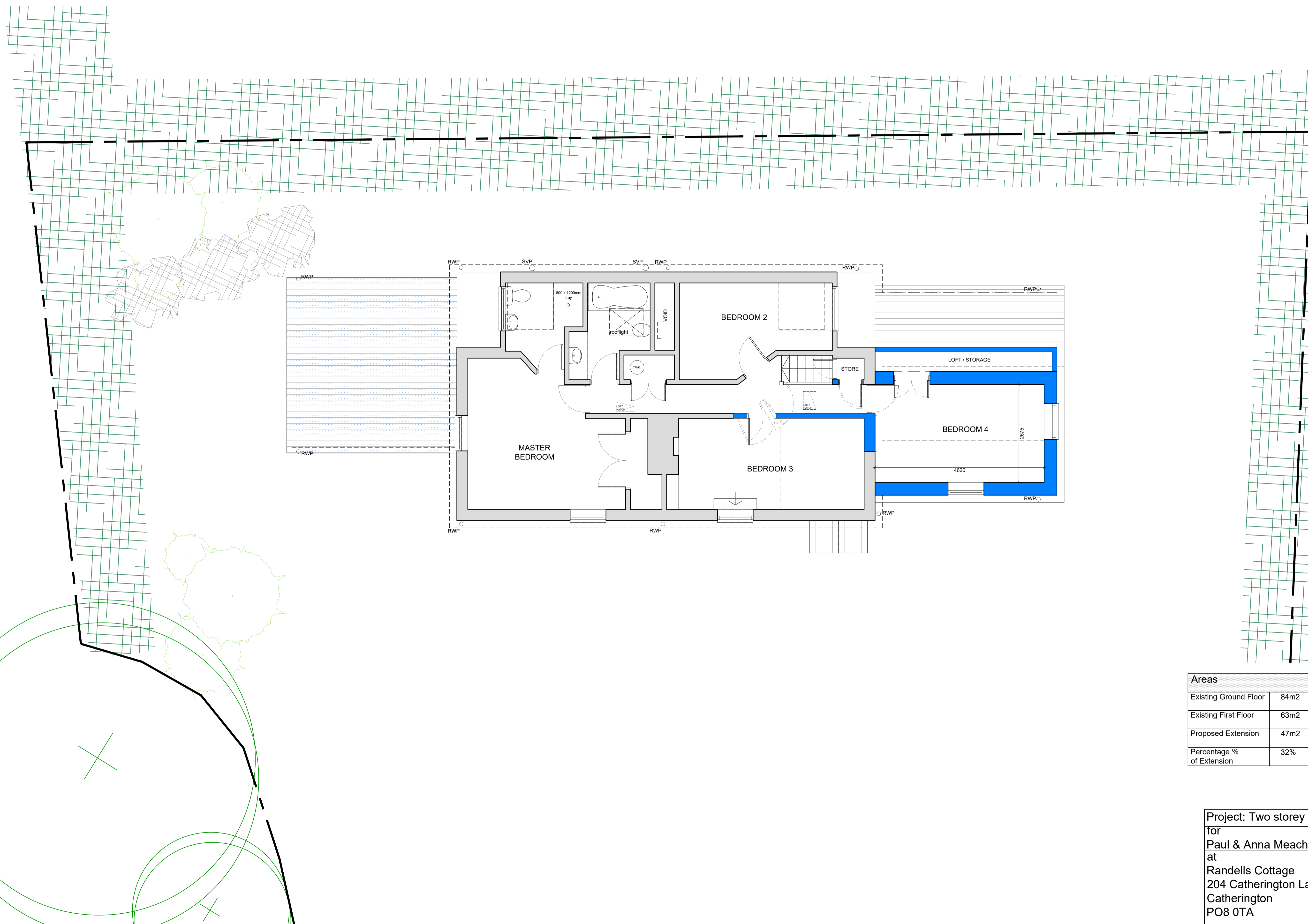

| Areas | |
|---------------------------|------------------|
| Existing Ground Floor | 84m ² |
| Existing First Floor | 63m ² |
| Proposed Extension | 47m ² |
| Percentage % of Extension | 32% |

| Rev. | Description | Date |
|-----------|-------------|------|
| Revisions | | |

Project: Two storey side extension
for
Paul & Anna Meacher
at
Randells Cottage
204 Catherington Lane
Catherington
PO8 0TA

Contact: [Michael Austin RIBA](mailto:Michael.Austin@RIBA.org)
E-mail: project@austinlebbon.co.uk
Web: www.austinlebbon.co.uk
Phone: 01730 887559

Dwg Ref: 2248 [PL] 02 Rev: - Date: FEB 2024

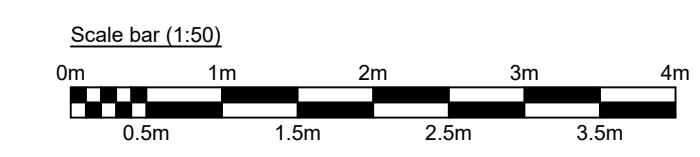

Proposed First Floor Plan
Scale 1:50 @ A1