

### Substructure Plan

**Note:** Width and depth of foundations to be in strict accordance with project engineers details and information

**Note:** Cavity tray and weep holes (max 450mm c/c) over telescopic vents

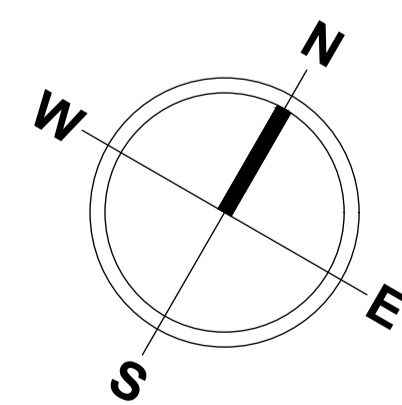
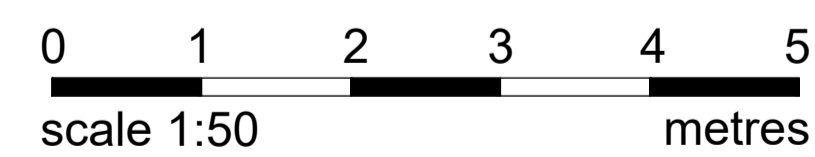

Adjacent outbuilding

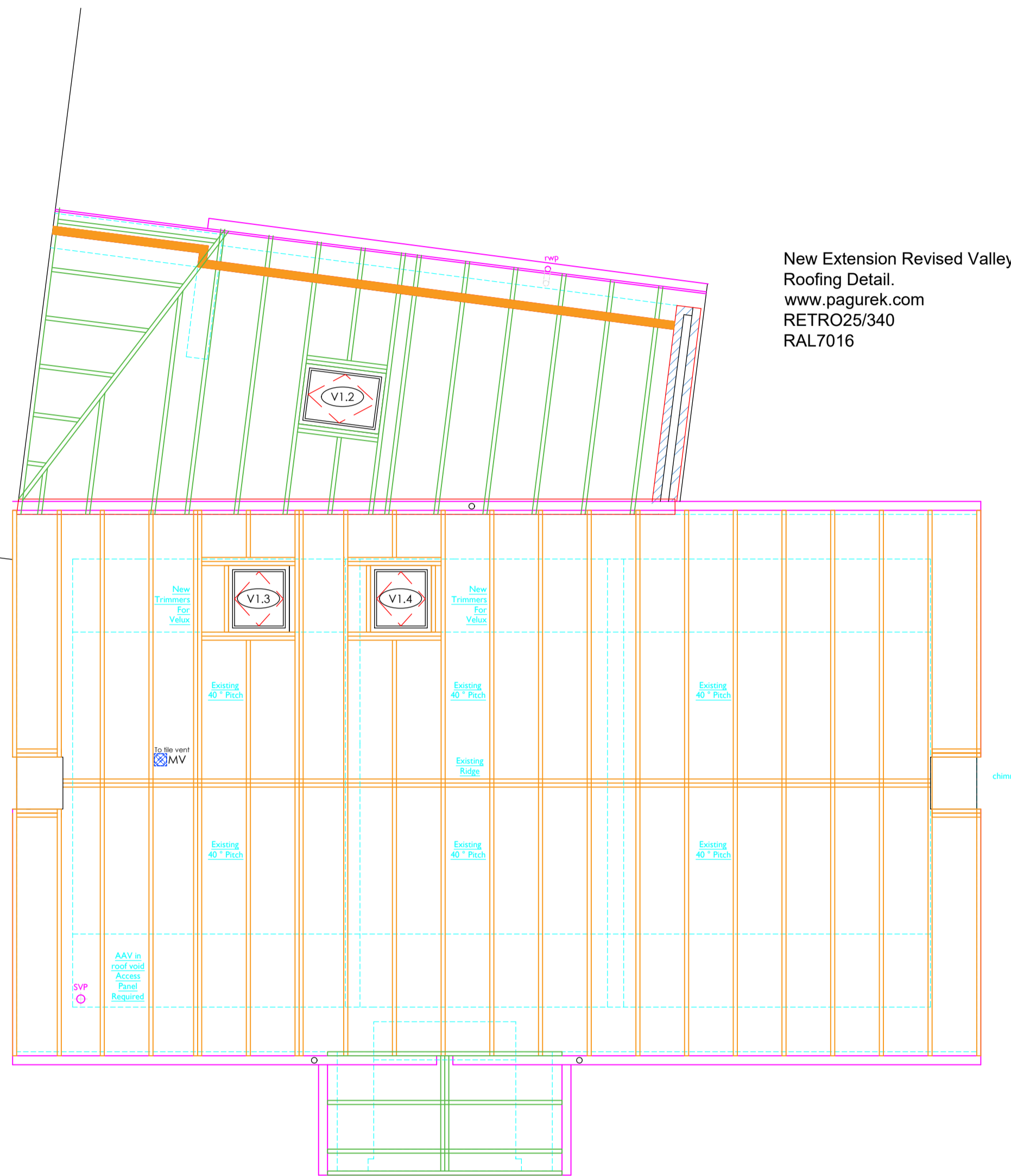

### Roof Plan

New Extension Revised Valley Roofing Detail.  
www.pagurek.com  
RETRO25/340  
RAL7016

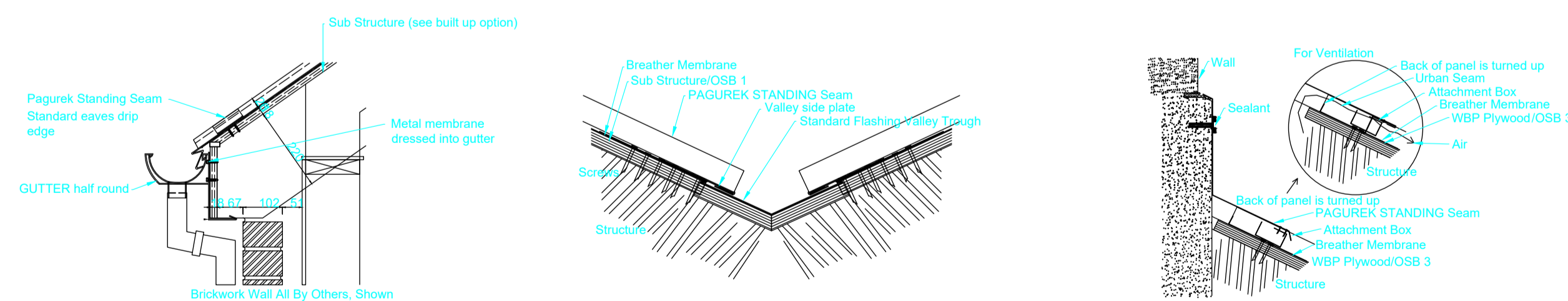

Project type	PLANNING	Drawing classification	RESIDENTIAL	Work stage	
DRAWING TITLE					
Quaker House					
High Street, Finedon, North Hants, NN9 5JN					
Substructure Plan & Roof Plan					
SCALE	SHEET SIZE	SHEET No. of	DRAWN	CHKD	DATE
1:50	A1		JR	JR	2022

Construction  
JRD22-025-001