

**Lighting key:**

- Red = Proposed
- Blue = Existing
- Downwards shielded wall light on motion sensors + override system for events
- Feestone light strings
- Bulkhead light fixed to ceiling
- Downwards facing bollards on timers + override system for events
- Downwards shielded wall lights on pods on PIR sensor with dawn/dusk sensor

NOTE\* External and internal lights (marked in blue) are as approved in consent (SDNP/21/00335/CND)

NOTE\*\* Lights are shown larger in this drawing for the key, not the actual light size

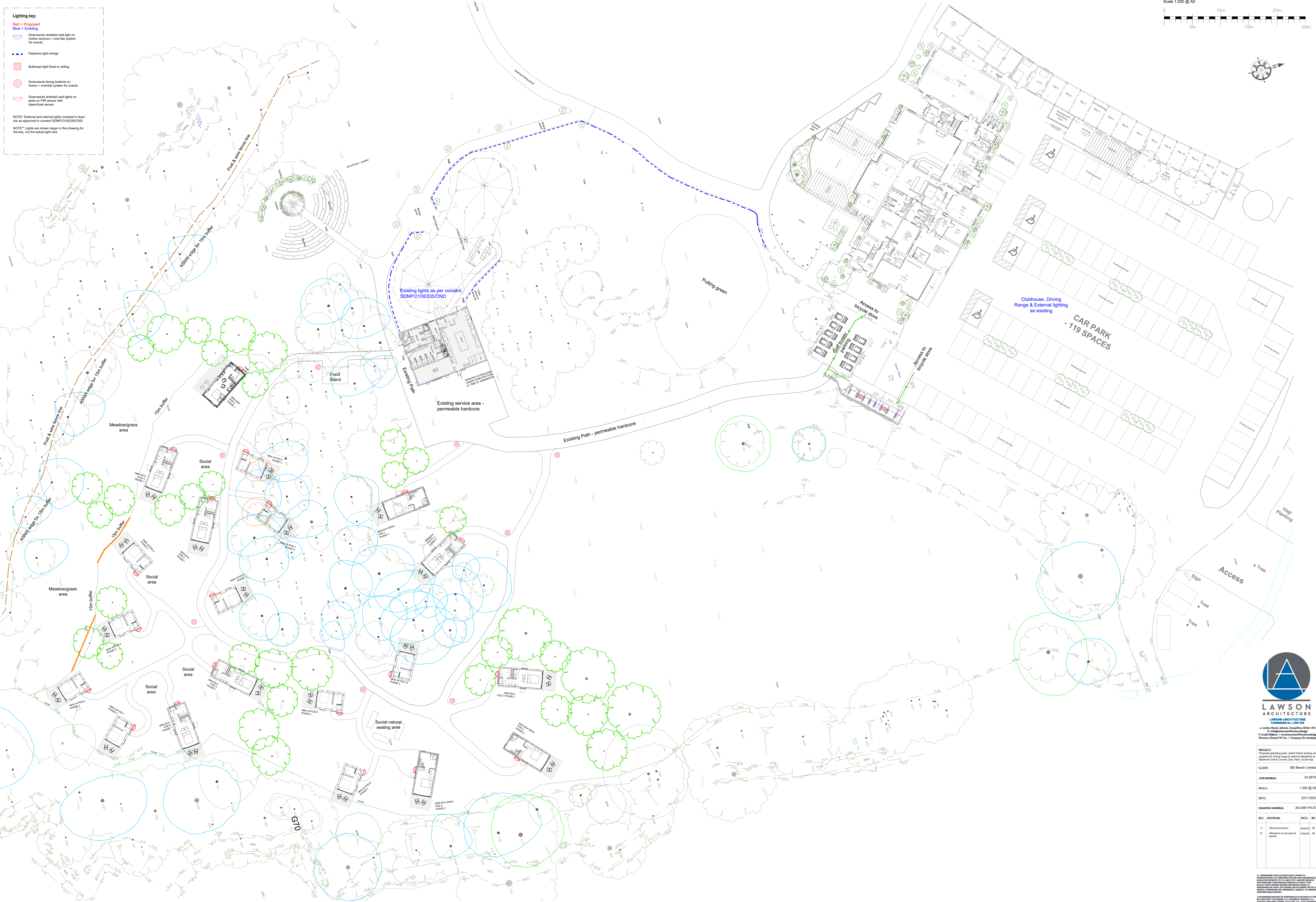

PROPOSED LIGHTING PLAN  
 - Scale 1:200 @ A0



**LAWSON ARCHITECTURE COMMERCIAL LIMITED**  
 1 London Road, Upper Marlborough, Oxfordshire, OX8 3JN  
 E: info@lawsonarchitect.co.uk  
 T: 01235 830000  
 D: 01235 830001  
 V: 01235 830002  
 W: www.lawsonarchitect.co.uk  
 C: 01235 830003  
 F: 01235 830004  
 D: 01235 830005  
 I: 01235 830006  
 O: 01235 830007  
 P: 01235 830008  
 R: 01235 830009  
 S: 01235 830010  
 T: 01235 830011  
 U: 01235 830012  
 V: 01235 830013  
 W: 01235 830014  
 X: 01235 830015  
 Y: 01235 830016  
 Z: 01235 830017

PROJECT:		Proposed lighting plan, raised timber decking and pergola for dining terrace at Beech Golf & Country Club, Alton, GU24 4GL	
CLIENT:		360 Beech Limited	
JOB NUMBER:		23-2075	
SCALE:		1:200 @ A0	
DATE:		22/11/2022	
DRAWING NUMBER:		20-2487-PX-03	
REV.	REVISION	DATE	BY
A	Amend pool area	24/01/23	JR
B	Alterations to pool space & layout	16/02/23	JR

All information on this drawing is the property of Lawson Architecture Commercial Limited. It is to be used only for the project and site specified. It is not to be used for any other purpose without the written consent of Lawson Architecture Commercial Limited. The client is responsible for ensuring that the drawing is used in accordance with the relevant regulations and standards. Lawson Architecture Commercial Limited is not responsible for any errors or omissions on this drawing. The client is responsible for ensuring that the drawing is used in accordance with the relevant regulations and standards. Lawson Architecture Commercial Limited is not responsible for any errors or omissions on this drawing.