

**Notes & Revisions**

Contractor must verify all dimensions on site before commencing work. Any discrepancies must be brought to the attention of the client.

**Structural Work**

All indications as to structure are for graphic purposes only. No structural analysis or design is provided. All structure and temporary propping to be confirmed by a suitably qualified engineer before beginning works.

A: 05/02/24 Planning Issue.

B: 10/02/24 Final Construction note removed.

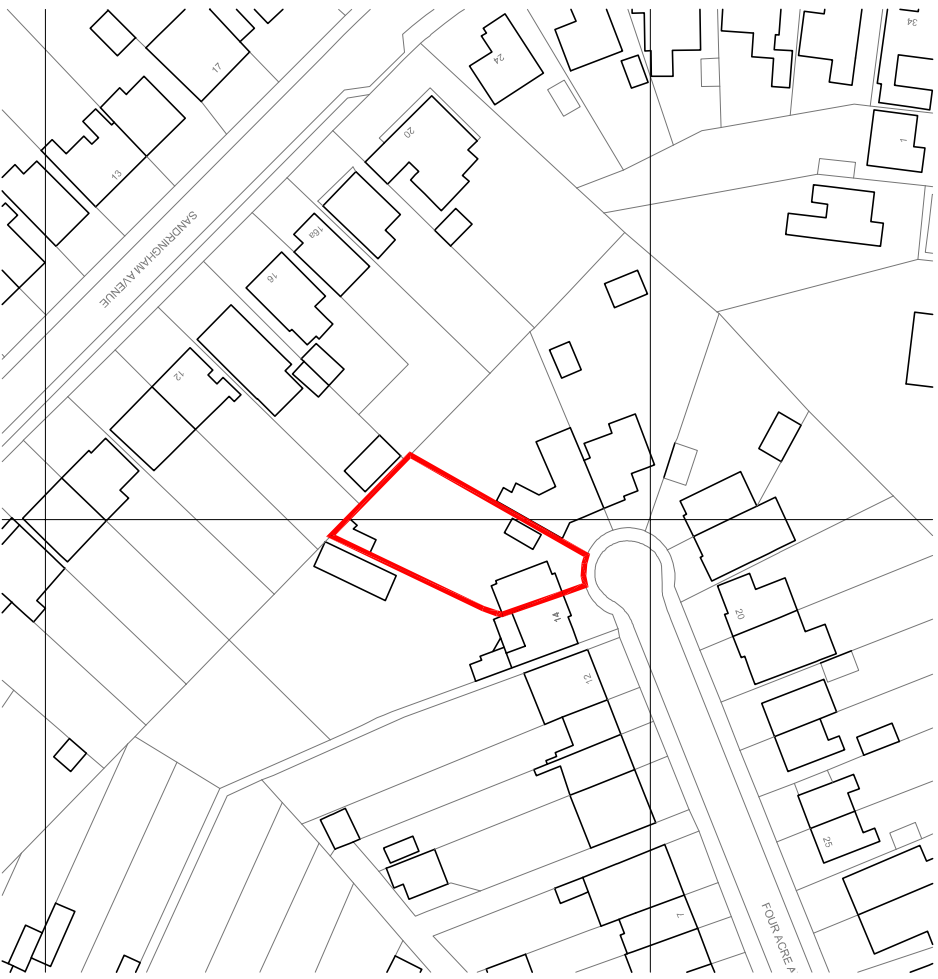

**15 Fouracre Avenue, Bristol**

Drawing: Site Location Plan  
Scale: 1:1250 @ A4  
Status: Planning  
Date: Oct 2023  
Revision: B

Drawn: HW

Date: Oct 2023

Revision: B

**SITE LOCATION PLAN**

**Clear Future : Architecture**

Mobile: +44 (0)1973283433  
E-Mail: markv.arch@gmail.com