

EXISTING

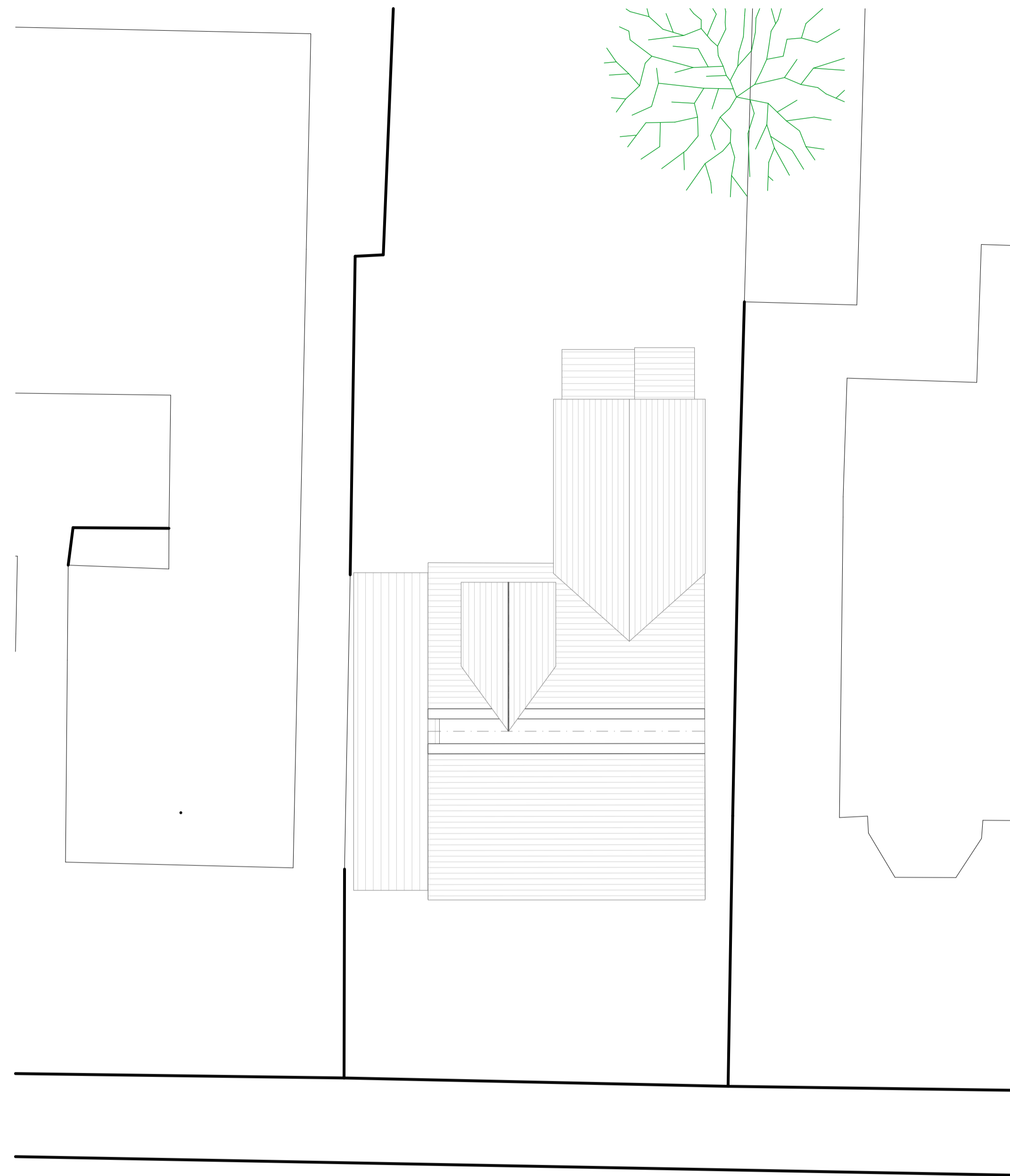

0. GROUND FLOOR PLAN

1:100



3. ROOF & LOCATION PLAN

1:100

KEY

	NEW WALL
	EXISTING WALL
	STRUCTURE REMOVED

		REVISION DATE JAN 24 TO LOCAL AUTHORITY	A
		DRAWING PROPOSED SINGLE STOREY REAR EXTENSIONS AND INTERNAL ALTERATIONS	
2-4c Jubilee House 3 The Drive Brentwood CM13 3FR Tel: +44 01277 725252 mail to: info@2-4c.co.uk http://www.2-4c.co.uk		EXISTING PLANS	
PROJECT ADDRESS 65 HEADLEY CHASE WARLEY BRENTWOOD		JOB NO. 23-641	DWG. NO. 06
CLIENT Mr & Mrs TOWNSEND		SCALE 1:100 @ A1	REV. NO. A
<small>IF THIS LINE MEASURES 100mm IT IS SCALED AS SHOWN</small> <small>Do not scale from this drawing. All dimensions & levels to be checked on site prior to commencement of any work. Check that this drawing is to the latest revision. If in doubt ASK. Refer any discrepancy to 2-4c. All dimensions in millimetres unless otherwise stated. This drawing is copyright © 2024 2-4c.</small>		DATE JAN 24	DRAWN BY / CHECKED BY SH / SH