

PARK LANE

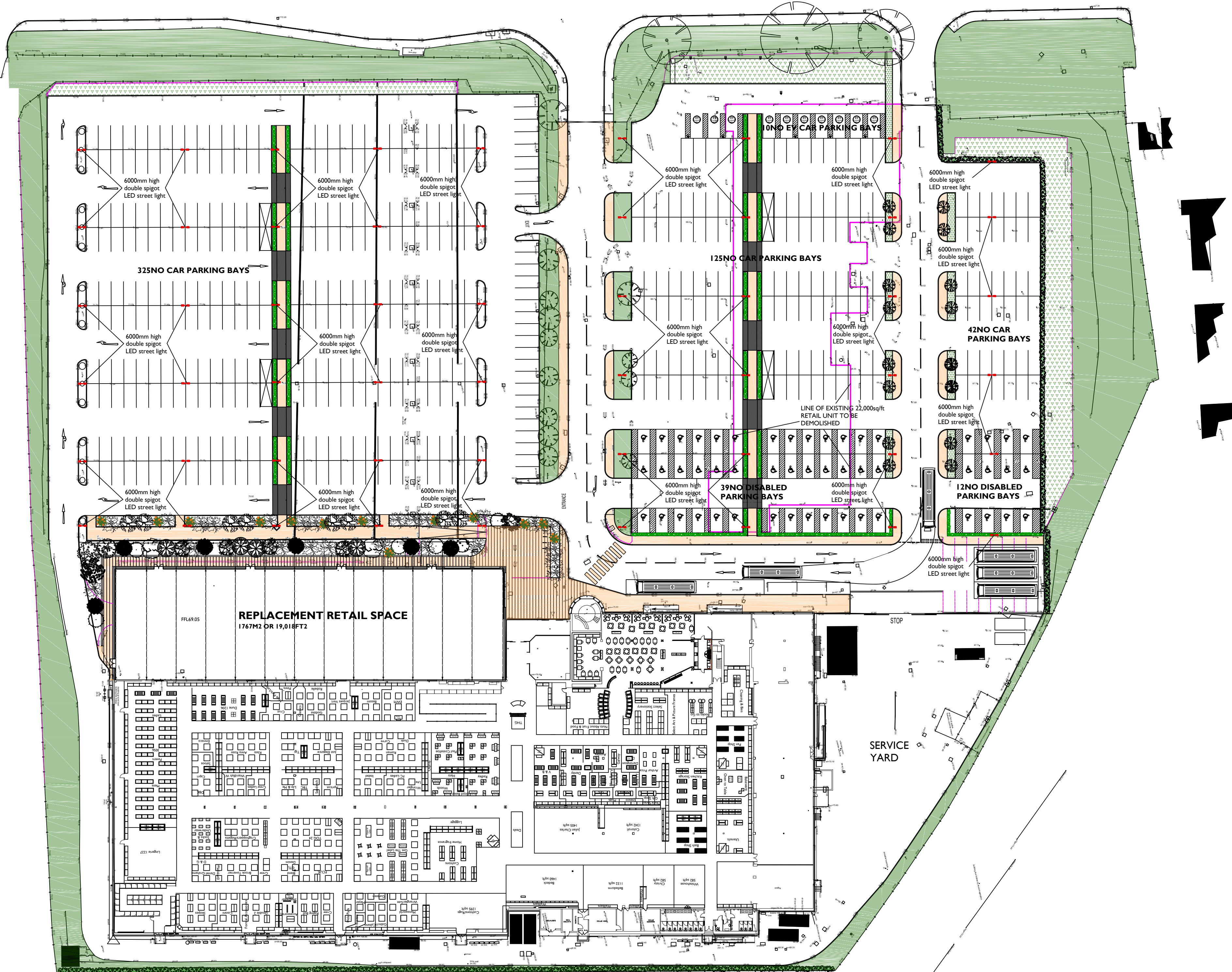

SITE PLAN - LIGHTING LAYOUT

xcite LED Lighting
Data Sheet

ROAD LANTERN
Road Lantern

Features

- Ideal for replacement of SON fixtures or Metal Halide fixtures
- Available in 3 different outputs
- Photocell option available
- Available in 2 sizes
- Mounted via side-entry 48mm (DOWNDOWN) or 60mm dia. spigot
- High quality toughened safety glass
- Aluminum body finished in grey (RAL 7031)
- Supplied as standard with 4000K (3000K) LED
- Up to 120 lumens per Watt efficacy

Order Code	Description	W	Im	lm/W
XCRL30DL	30W - Road Lantern - IP65 - 6500K	30	3600	120
XCRL60DL	60W - Road Lantern - IP65 - 6500K	60	6700	112
XCRL100DL	100W - Road Lantern - IP65 - 6500K	100	12000	120

Order Code	A (mm)	B (mm)	C (mm)
XCRL30DL	500	212	68
XCRL60DL	500	212	68
XCRL100DL	715	280	88

Technical Drawing Scale 1:1
T: +44 (0)1952 20444
E: sales@xciteledlighting.co.uk
173 182, Riverside
www.xciteledlighting.co.uk
© 2019 Xcite LED Lighting
Generated on 20/02/2024 11:40:00
© 2019 Xcite LED Lighting

CAR PARK LIGHT FITTINGS
MOUNTED ON 6000MM LIGHTING
POLES

Notes

All work to be carried out in accordance with the requirements of the current Building Regulations, all relevant BS Specifications, Codes of Practice, Local and Service Authority Byelaws, and in compliance with the Local Authority Approvals

Contractors must verify all dimensions on site before commencing any work, making any shop drawings or fabricating off site.

Written dimensions should be taken in preference to scaled-off dimensions.

If there are any discrepancies found between the drawing and site, the CRC Design should be notified immediately

PARTY WALL ACT 1996

PLEASE NOTE THAT IF YOU INTEND TO CARRY OUT WORKS ON A WALL SHARED WITH ANOTHER PROPERTY, OR BUILD ADJACENT TO THE BOUNDARY WITH A NEIGHBOURING PROPERTY, OR EXCAVATE NEAR A NEIGHBOURING BUILDING YOU MUST FIND OUT WHETHER THAT WORKS FALLS WITHIN THE SCOPE OF THE PARTY WALL ACT 1996. IF IT DOES YOU MUST SERVE THE STATUTORY NOTICE ON ALL AFFECTED OWNERS

revision _____ date _____

CRC DESIGN

ARCHITECTURAL SERVICES

5 WALLHURST CLOSE WORSTHORNE BURNLEY BB103AV

tel 01282 457956 mob 07857 552179 e arl@crcdesign.co.uk

project
PROPOSED EXTENSION
BOUNDARY OUTLET
PARK LANE
SHIRE MOOR
NEWCASTLE UPON TYNE
client
LIBRA TEXTILES

PROPOSED SITE PLAN
CAR PARK LIGHTING

date FEB 2024	scale 1: 500 @ A1	drawing no. 1514-17
------------------	----------------------	------------------------

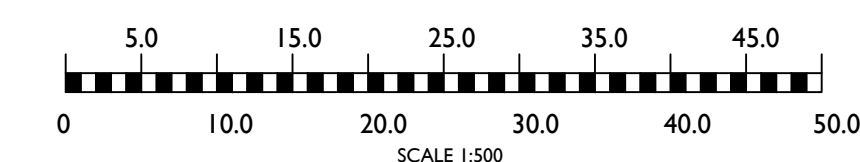

This drawing is copyright of CRC DESIGN Architectural Services. It shall not be used without permission for any purpose. Reproduction is only permitted by prior arrangement