

PARK LANE

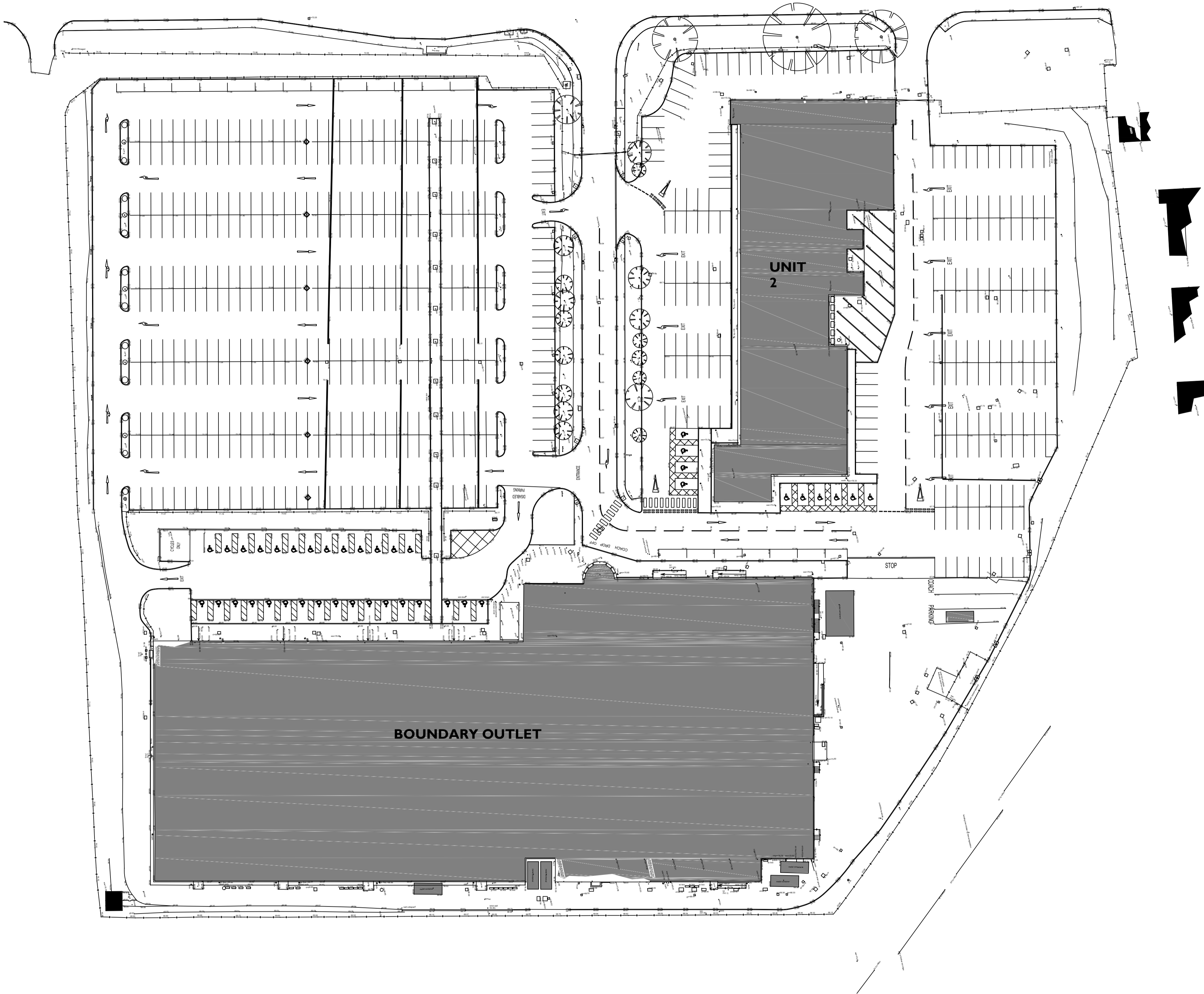

SITE PLAN 1:500

**GRID**  
To local grid based on osth15/osgm15

**control point**  
C1 1000 000  
N 1000 000  
E 100 000

**spot level**  
60.11

All linework described by layering system or nearby text

wall (see text for height / width / type)

fence (see text nearby for height / type)

gate

hedge scaled to width  
Canopy/Vegetation line

deciduous tree  
defined by trunk & one point on canopy  
d=5  
(girth size and position +/- 50mm)

conifer tree  
defined by trunk & one point on canopy  
(girth size and position +/- 50mm)

**GENERAL ABBREVIATIONS**

- ac box - air conditioning box
- av - air valve
- bb - belisha beacon
- bt - British Telecom
- conc. - concrete
- conc. boll. - concrete bollard
- conc. wall - concrete wall
- ctv - cable TV
- dk - drop kerb
- ds - down spout
- ds&g - down spout with gully
- earth - earth point
- edg cut grass - edge cut grass
- el - electric
- el.sub st. - elec. substation
- face conc. - face of concrete
- face clad. - face of cladding
- face tim. - face of timber
- f.hydr - fire hydrant
- guy - guy rope/stay
- lp - lamp post
- rod. eye - rodding eye
- ret. wall - retaining wall
- rsj - steel rsj
- salt - salt box
- sl - sign - with indicative text
- sur. drain - surface drain
- st.tap - stop tap
- sv - sluice valve
- trell - trellis
- ts - traffic signal
- utility - utility (unknown)

**LEVEL ABBREVIATIONS**

- cl=60.11 - cover level
- dpc=60.11 - dpc level
- ea=60.11 eaves level
- ff=60.11 finished floor level
- gu=60.11 - gully top level
- gutter=60.11 - gutter level
- hip=60.11 - hip level
- il=60.11 - invert level
- oh=60.11 - overhead level
- ramp=60.11 - ramp level
- rd=60.11 - ridge level
- silt tw=60.11 - silt level
- sill=60.11 - sill level
- top conc=60.11 - top of concrete
- tpi=60.11 dia. 10 - top of pipe
- 1.st=60.11 - top of step
- tw=60.11 - top of wall
- wal=60.11 - water level

**FENCE ABBREVIATIONS**

- b/w - barbed wire
- cl - chain link
- clb - close boarded
- cl - corrugated iron
- con/pan - concrete panel
- cr/ba - crash barrier
- hr - hand rail
- ir - iron rail
- pal - palisade
- panel - panel
- pb - public barrier
- pick - picket
- pr - post & rail
- p/w - post & wire
- sec. - security fence
- wood - wooden fence

**FLOOR PLAN ABBREVIATIONS**

- ff - finished floor level
- FC - floor to cill
- CH - cill to head
- CH - ceiling height
- LP - low point
- HP - high point
- BH - Beam height
- DH - Door height
- SKY - skylight
- AH - access hatch

**Notes**

All work to be carried out in accordance with the requirements of the current Building Regulations, all relevant BS Specifications, Codes of Practice, Local and Service Authority Byelaws, and in compliance with the Local Authority Approvals

Contractors must verify all dimensions on site before commencing any work, making any shop drawings or fabricating off site.

Written dimensions should be taken in preference to scaled-off dimensions.

If there are any discrepancies found between the drawing and site, the CRC Design should be notified immediately

**PARTY WALL ACT 1996**

PLEASE NOTE THAT IF YOU INTEND TO CARRY OUT WORKS ON A WALL SHARED WITH ANOTHER PROPERTY, OR BUILD ADJACENT TO THE BOUNDARY WITH A NEIGHBOURING PROPERTY, OR EXCAVATE NEAR A NEIGHBOURING BUILDING YOU MUST FIND OUT WHETHER THAT WORKS FALLS WITHIN THE SCOPE OF THE PARTY WALL ACT 1996. IF IT DOES YOU MUST SERVE THE STATUTORY NOTICE ON ALL AFFECTED OWNERS

Unit 1 Arden Business Centre  
Horsfield Way  
Bredbury Ind. Estate  
Bredbury  
SK6 2SU  
T: 0161 427 0348  
E: www.thecadroom.com

**Disclaimer**

Only manholes that were accessible on site during survey other manholes may be present but covered all invert levels taken where possible at main channel Main Entry to sewers has not been undertaken. Depths, Pipelines etc are measured from the ground. All sewers and inverts to be checked prior to any works commencing on site. The CAD Room Ltd are not responsible for manholes, services, information not surveyed which may have an impact on site development. Boundaries shown are physical and may not represent legally conveyed

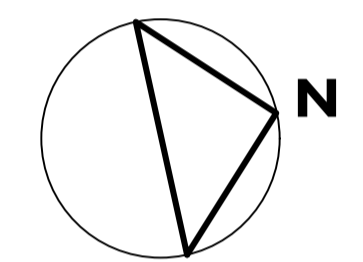

revision \_\_\_\_\_ date \_\_\_\_\_

**CRC DESIGN**  
**ARCHITECTURAL SERVICES**

5 WALLHURST CLOSE WORSTHORNE BURNLEY BB103NY  
tel 01282 457956 mob 07857 352179 e carl@crdesign.co.uk

project  
PROPOSED EXTENSION  
BOUNDARY OUTLET  
PARK LANE  
SHIREMOOR  
NEWCASTLE UPON TYNE  
client  
LIBRA TEXTILES

drawing title  
EXISTING SITE PLAN (SURVEY)  
PLANNING SUBMISSION

date	scale	drawing no.
JAN 2024	1: 500 @ A1	1514-5

