

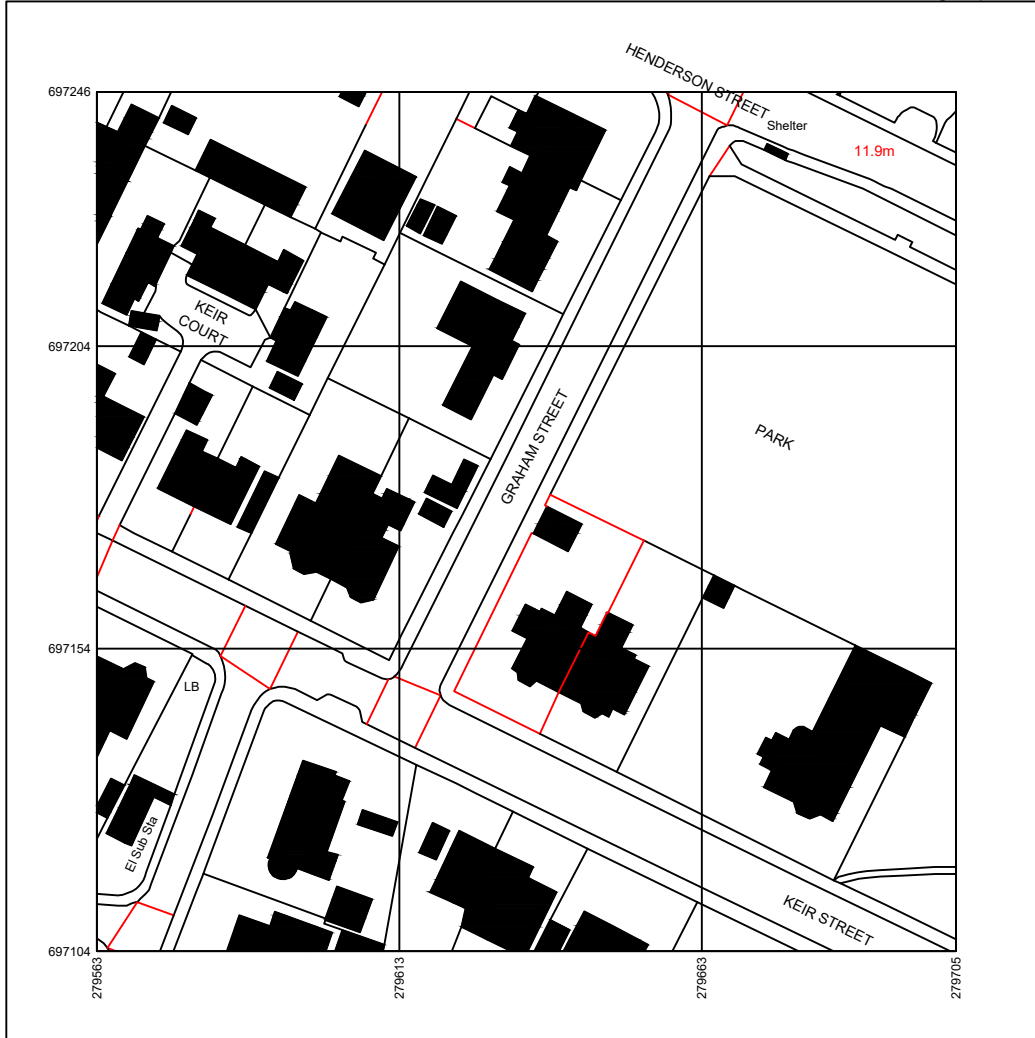

**UK
Planning
Maps**

01856 898 022
www.UKPlanningMaps.com



Produced on 04 March 2024 from the Ordnance Survey National Geographic Database and incorporating surveyed revision available at this date.
This map shows the area bounded by 279563 697104, 279705 697104, 279705 697246, 279563 697246, 279563 697104.
Crown copyright and database rights 2024 OS 100054135. Supplied by copla ltd trading as UKPlanningMaps.com a licensed Ordnance Survey partner (OS 100054135).
Data licence expires 04 March 2025. Unique plan reference: v2e/1068561/1439082



MR WADSWORTH

PROPOSED REPLACEMENT GARAGE

AT 51 KIER STREET

BRIDGE OF ALLAN

LOCATION PLAN

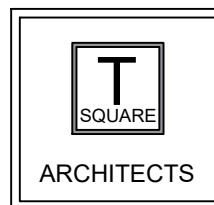

Architecture - Design - Planning

Castle View, Steuart Road,
Bridge of Allan
Stirling
FK9 4JX

Mob: 07596906412

E-mail: daire.gibbons@tsquare-architects.co.uk Web: www.tsquare-architects.co.uk

scale 1:1250	date 26.02.24	drawn: CG	status: P
proj. no. 2024-1052	Dwg. no. T-101c	REV -	