

THIS DRAWING IS TO BE READ IN CONJUNCTION WITH ALL RELATED DRAWINGS. ALL DIMENSIONS MUST BE CHECKED AND VERIFIED ON SITE BEFORE COMMENCING ANY WORK OR PRODUCING SHOP DRAWINGS. THE ORIGINATOR SHOULD BE NOTIFIED IMMEDIATELY OF ANY DISCREPANCY. THIS DRAWING IS COPYRIGHT AND REMAINS THE PROPERTY ROGER PARRY & PARTNERS.

Rev	Description	Date	By
-	-	year/mm/dd	--

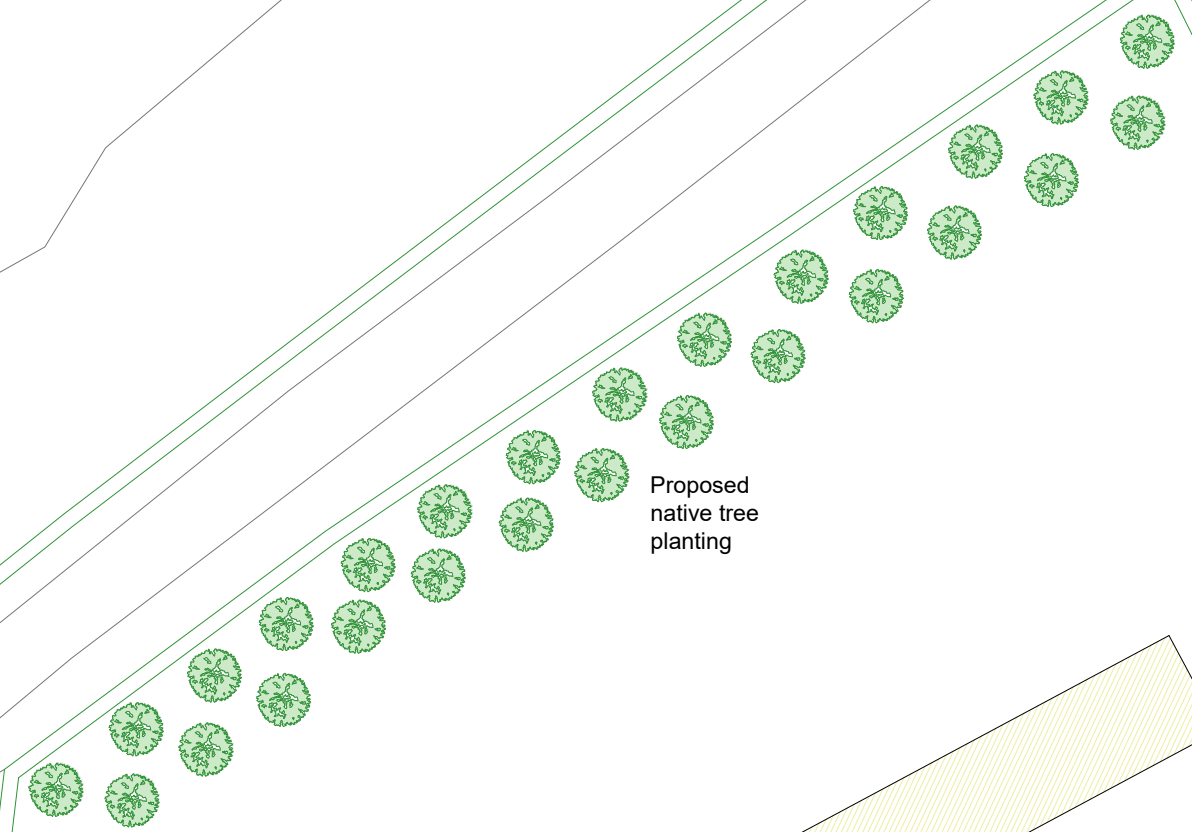
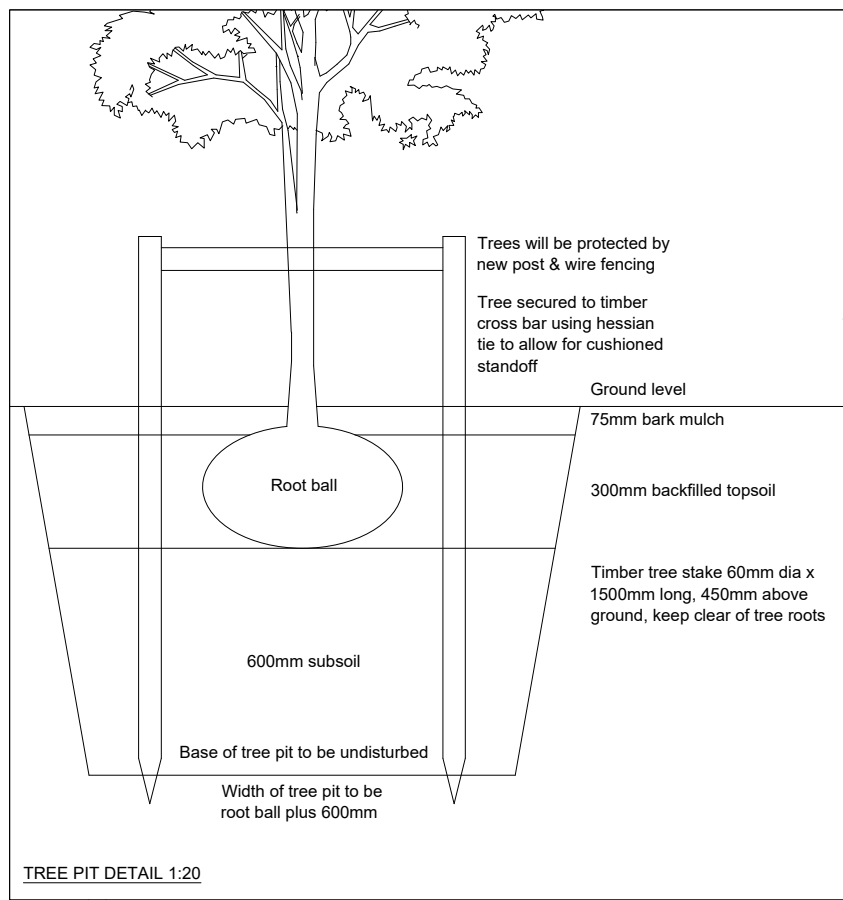

**PROPOSED NATIVE TREE PLANTING**

New trees are proposed to be planted within the development area. The trees will be staggered and will be Heavy Standard. Refer to Tree Pit detail on this sheet. The newly planted trees will be protected by post and wire stock proof fencing.

New native trees will be a mixture of the following:

- Birch (*Betula Pubescens*)
- Hazel (*Corylus Avallana*)
- Oak (*Quercus Robur*)
- Alder (*Alnus Glutinosa*)
- Maple (*Acer Campestre*)

New trees are to be planted in line with the following:

- BS 4428:1989 Code of Practice for general landscaping operations (excluding hard surfaces).
- BS 8545:2014 Trees from nursery to independence in the landscape: Recommendations.

All planting will be carried out in the first planting season following first occupation of the development. Any trees or plants which die, are removed or become diseased or seriously damaged within the first five years will be replaced in the next planting season with others of similar size and species.



Residential - Agricultural - Commercial

Project	Proposed Calf Pens		
Drawing Title	Biodiversity Enhancement Plan		
Location	Stonehouse Farm, Welshpool, Powys, SY21 9DB		
Client	A & D Evans & Son		
Scale	1:500 @ A3		
Drawing No	78567 / RJC / 004	Rev	-
Drawn By	NB	Date	2024/01/10

MERCIAN HOUSE, 9 DARWIN COURT, OXON  
BUSINESS PARK, SHREWSBURY, SY3 5HJ  
Tel: 01743 791336  
E-mail: mail@rogerparry.net  
Web address: www.rogerparry.net  
Roger Parry & Partners LLP partnership no. OC312203  
Registered in England and Wales.  
A list of members of the LLP is available at the above address.