

# 2 MACAULAY ROAD

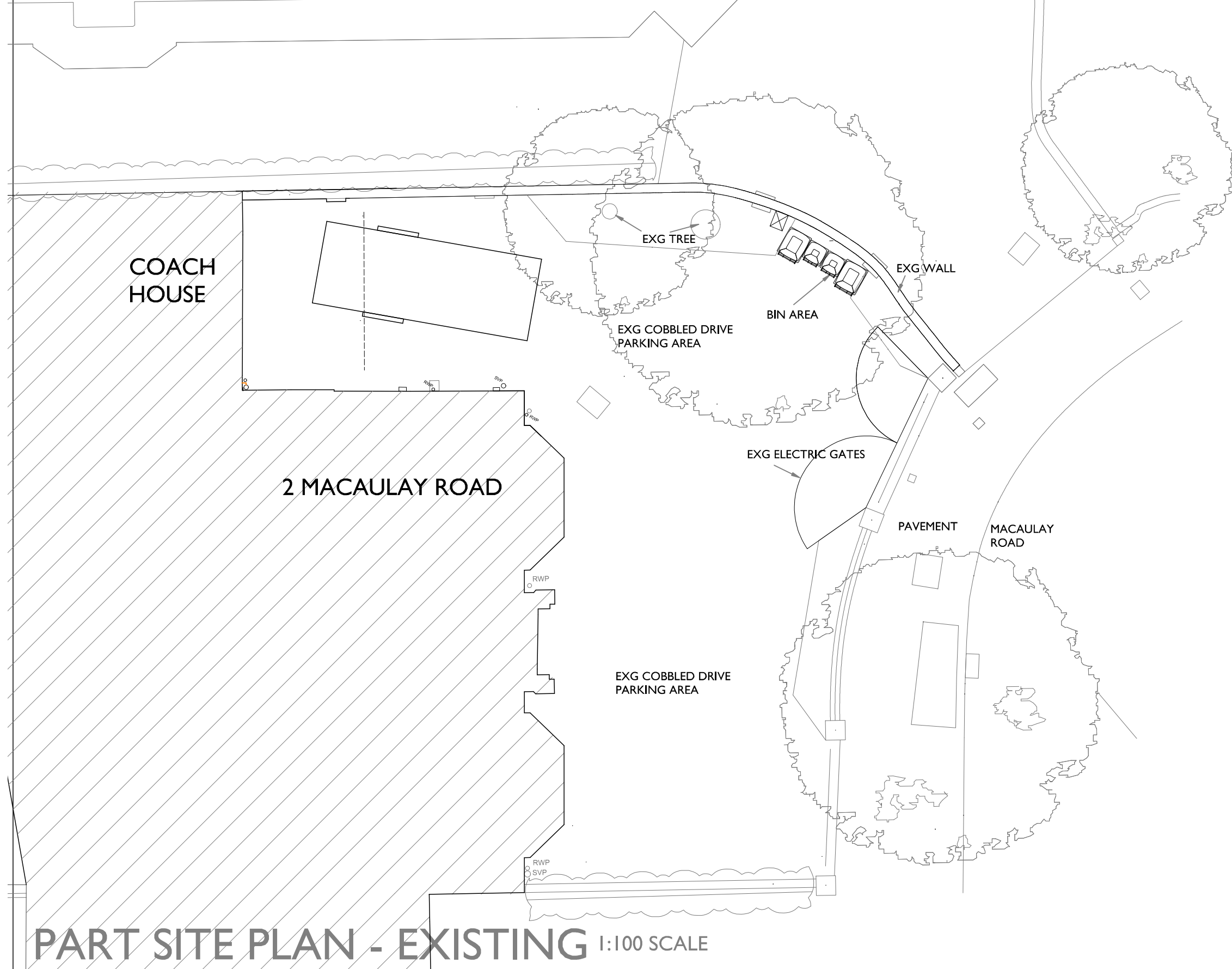

**PART SITE PLAN - EXISTING** 1:100 SCALE

Notes:

**A3**

THIS DRAWING IS THE COPYRIGHT OF FAVONIUS ARCHITECTS IT MAY NOT BE COPIED ALTERED OR REPRODUCED IN ANY WAY WITHOUT THEIR WRITTEN AUTHORITY. DIMENSIONS MUST BE CHECKED ON SITE AND NOT SCALED FROM THIS DRAWING.

**2 MACAULAY ROAD  
CLAPHAM  
PROPOSED BIKE AND BIN STORE  
AND PARCEL DROP BOX  
EXISTING PART SITE PLAN**

**DWG No: 1132-20-03**

DATE MARCH 24

SCALE: 1:1250/500



Tel: 01722 412 391

www.favonius.co.uk  
Wyndham House, 65 The Close, Salisbury, Wiltshire SP1 2EN

**PLANNING APPLICATION**