

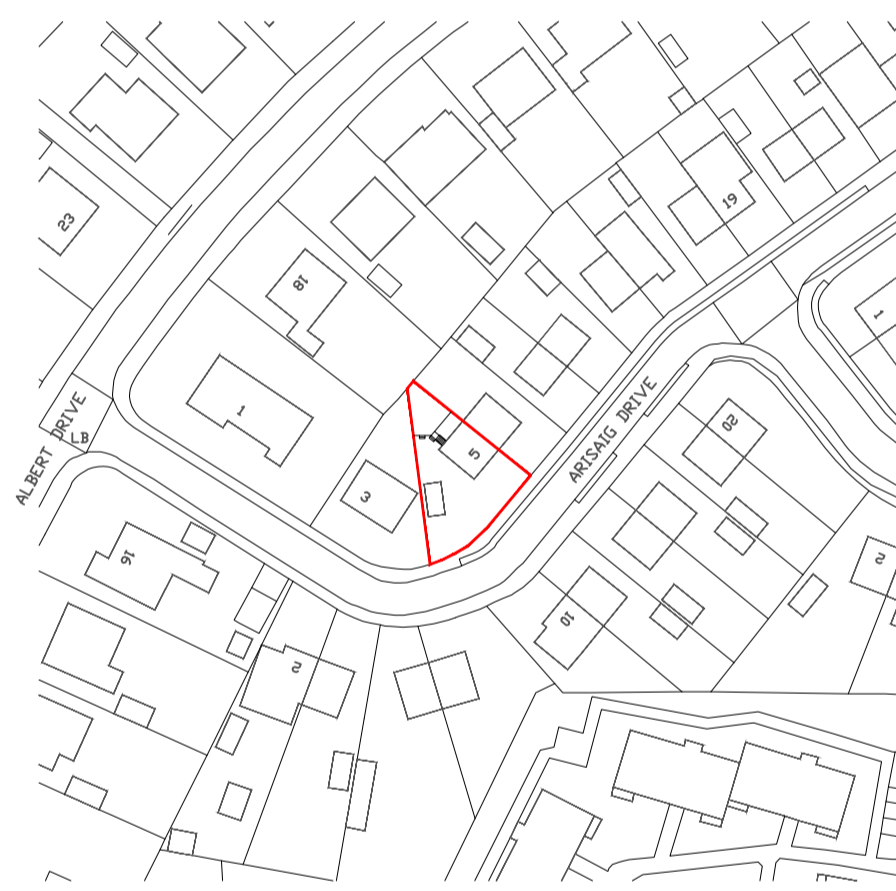

01856 898 022
www.UKPlanningMaps.com

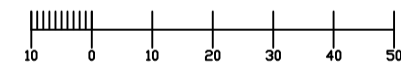

Produced on 29 February 2024 from the Ordnance Survey National Geographic Database and incorporating surveyed revision available at 192 date.
This map shows the area bounded by E55800 671115, E55962 671115, E55980 671115, E55980 671115, E55980 671115, E55980 671115.
Crown copyright and database rights 2024 OS 100054120. Supplied by code for trading as UKPlanningMaps.com a licensed Ordnance Survey partner OS 100054120.
Data licence expires 29 February 2025. Unique plan reference: v8r/106640/1436256



LOCATION PLAN @ 1.1250

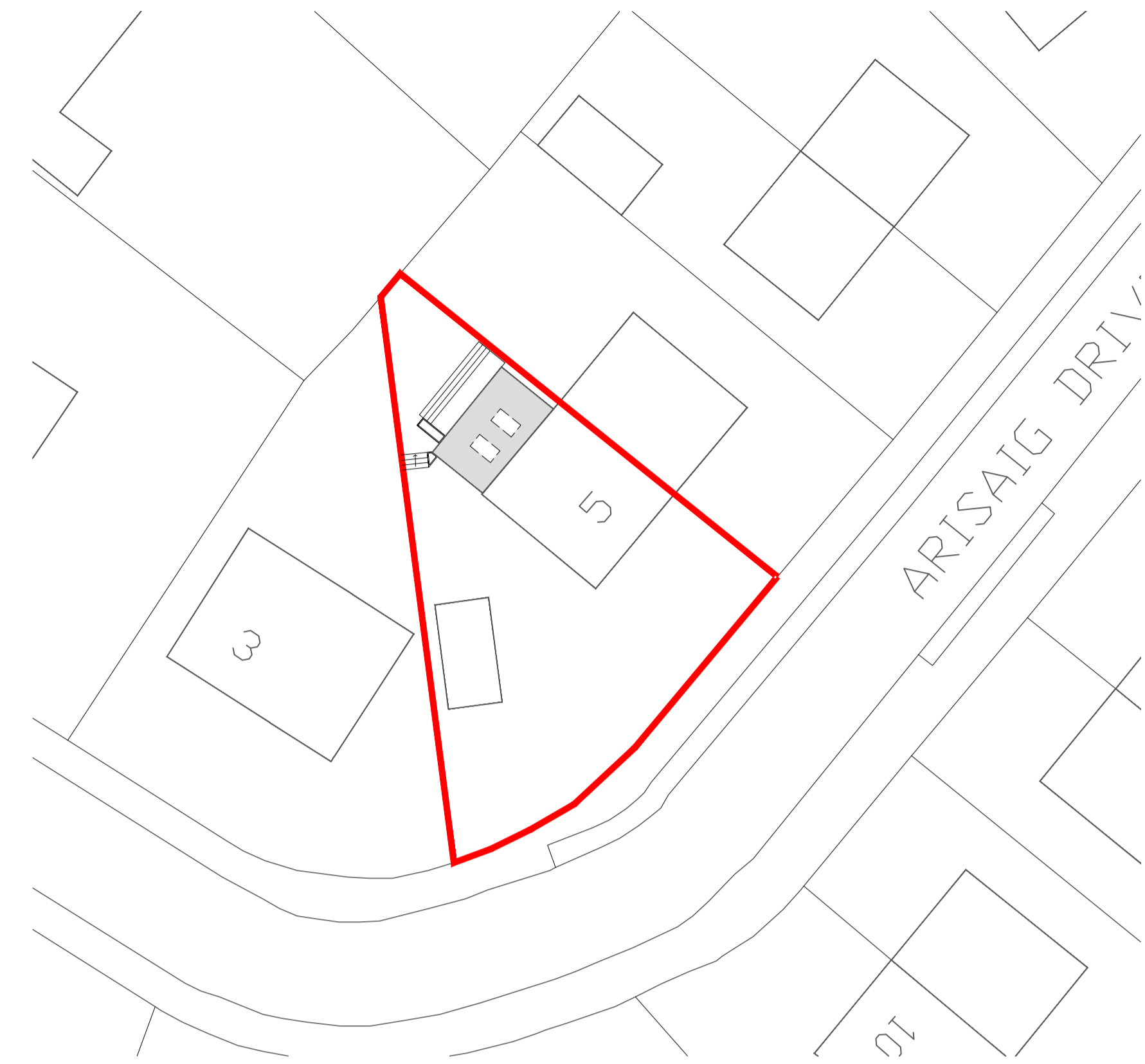

PROPOSED BLOCK PLAN @ 1.250

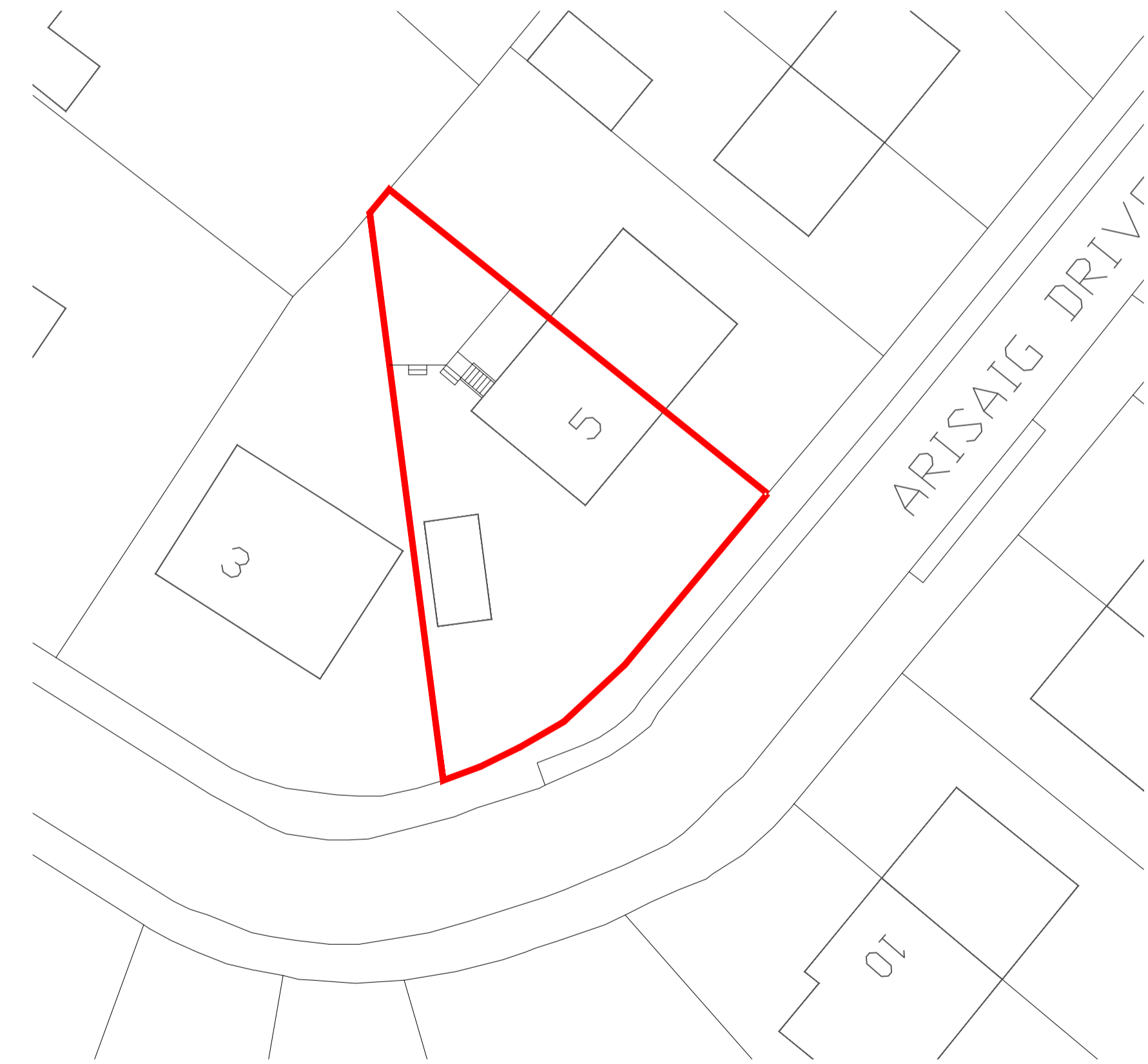

EXISTING BLOCK PLAN @ 1.250

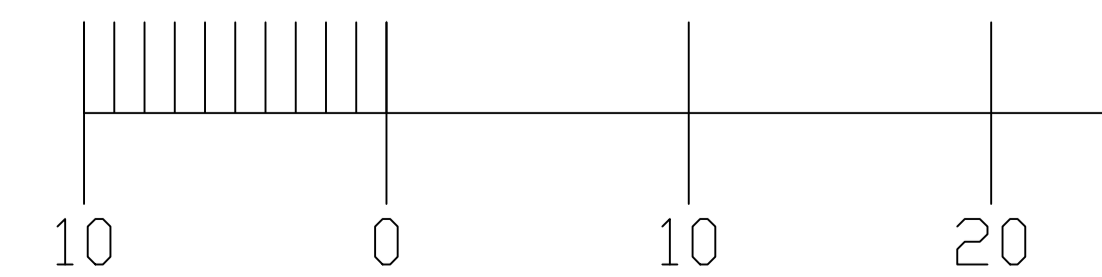

ALL DIMENSIONS TO BE CHECKED ON SITE
DO NOT SCALE FROM THIS DRAWING.
USE FIGURED DIMENSIONS ONLY.
IF IN DOUBT ASK.
THIS DRAWING IS THE COPYRIGHT OF THE ARCHITECT, AND SHOULD NOT BE
REPRODUCED IN ANY FORMAT WITHOUT PRIOR APPROVAL.

CONNOR MCGINLEY
ARCHITECT Bsc (Hons) March Arb RIBA

CLIENT
MACMILLAN

PROJECT
**5_ARISAIG_DRIVE
BEARSDEN_G61_2PE**

DRG. TITLE
LOCATION_PLAN

STATUS
PLANNING

DRAWN **CMG** SCALE **AS INDICATED**
CHECKED **CHKD** ORIGINAL **A1**
JOB NO. **MCG001** DATE **FEB'24**

DRG. NO.-REV.
L100B