

GROUND FLOOR

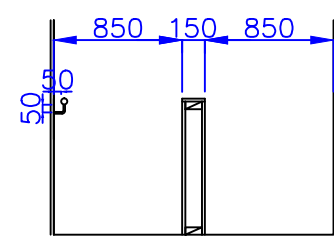

STAIR SECTION 1:50

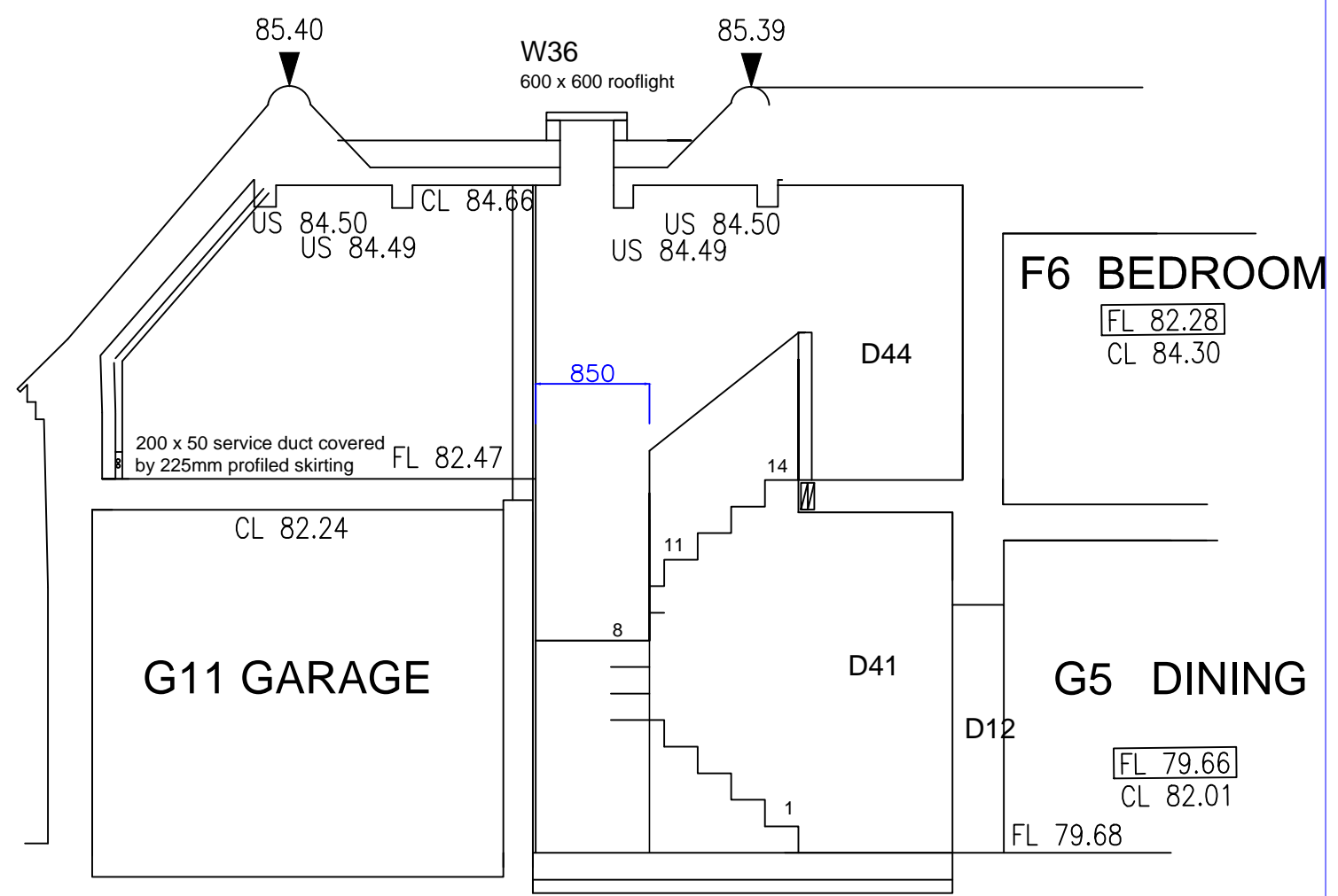
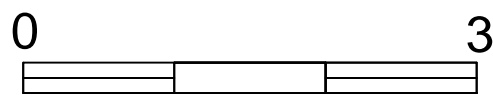
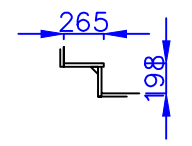

TREAD SECTION 1:50

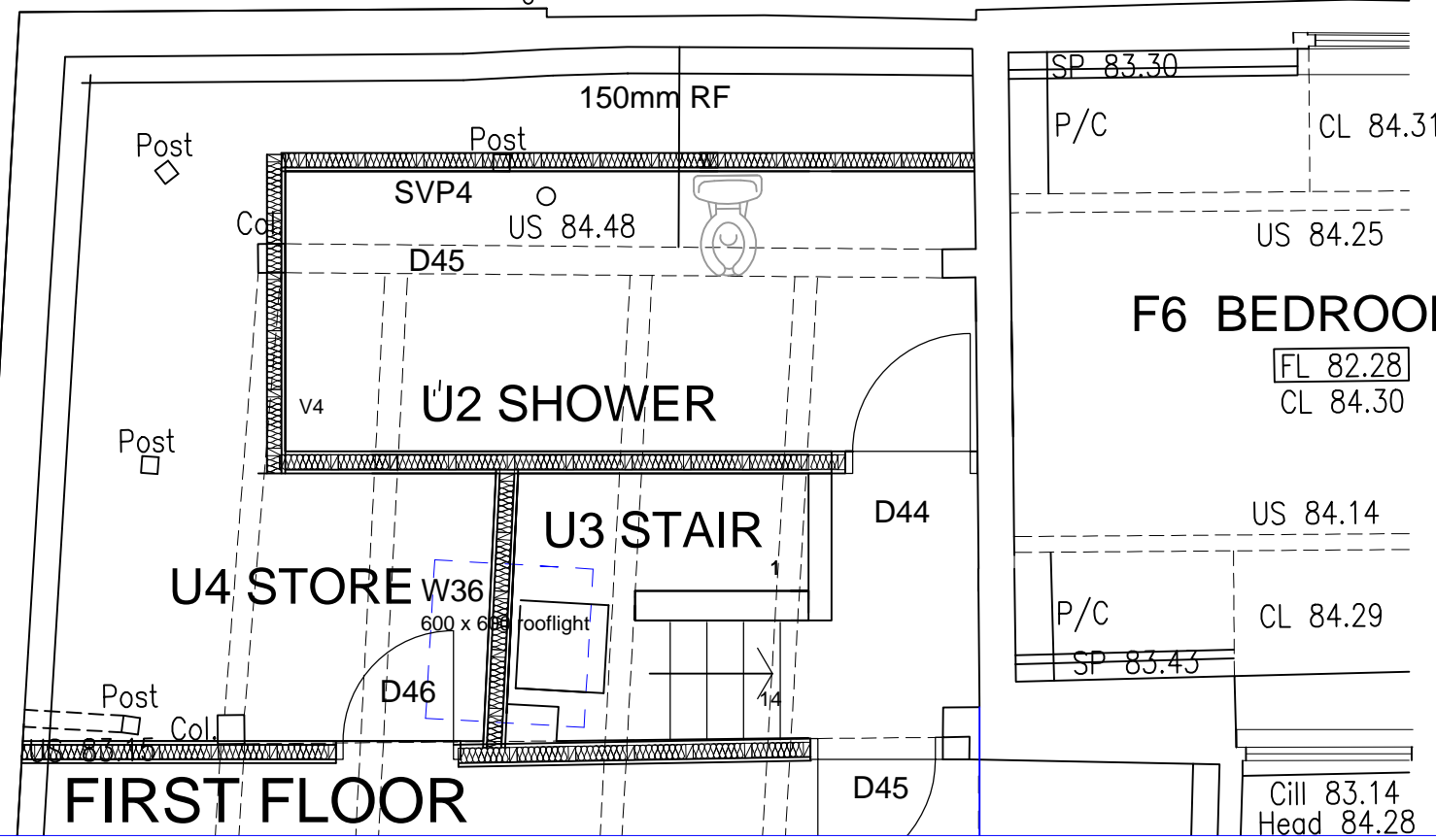

FIRST FLOOR

- U3 NEW STAIRWAY**
- U3.1 Existing floor to be opened up and 2nr 195 x 50mm trimmers inserted across stairway.
 - U3.2 New stair: total rise 2770mm
14nr risers @ 198mm Minimum goings 250mm
Maximum pitch 40° 850mm width treads
Single 40mm handrail to outside edge at 900mm above pitch. Set 50mm off wall and 50mm above brackets
 - U3.3 Central solid balustrade with raked top to match pitch.
100 x 50mm studwork centrewith 20mm strings
Stair formed with 25mm MDF treads and risers
 - U3.4 All joints connected with 50 x 50 glue blocks screwed
 - U3.5 New rooflight W36: TUFFX Infinity rooflight, fixed glazing unit 600 x 600 set on minimum 150mm upstand

NOTICE

- 1) This drawing is copyright property of Pegley D'Arcy Limited and may not be copied, transmitted or otherwise used without express, written permission.
- 2) Any dimensions and levels are to be checked on site prior to any works.
- 3) Any discrepancies or queries are to be resolved before progressing any works on site.
- 4) All works to conform to approved drawings and specification
- 5) Errors and omissions excepted

27 December 2023
6580-142
STAIR U3 1:50 @ A3

55 WELL STREET
BUCKINGHAM MK18 1EP

ROYAL INSTITUTE OF BRITISH ARCHITECTS CHARTERED PRACTICE

