

# AMETHYST HOMES THE PEARL - AS HANDING

All drawings are to be read in conjunction with specification.



PROPERTY MISDESCRIPTIONS ACT 1991  
(Warning to House Purchasers)  
These drawings, and their contents, are for 'Construction' purposes only and may be subject to change at any time.  
Alterations and Variations may occur during the construction process, and therefore the layout, form, content, and dimensions of the completed construction may vary from that shown on these drawings.  
Every effort is made to constantly update the information shown however there may be situations of unavoidable delay due to changes in Statutory Regulations and/or re-planning. Purchasers are advised to check with the Sales Team to ascertain whether there have been any alterations to the printed information.

ELECTRICAL SYMBOLS KEY:	
	Twin / single tube luminaire, 58W daylight tubes.
	Basin pelmet light with integrated switch.
	Pendant ceiling lightfitting; energy efficient lamp.
	Batten lightfitting; energy efficient lamp.
	Recessed downlighter fitting:
	Water proof recessed downlighter fitting.
	Wall light.
	External lightfitting.
	Location of Tri-lights below kitchen wall units.
	Single light switch.
	Two-way light switch.
	Immersion Switch.
	Cooker Outlet
	Single switched socket outlet.
	13 amp double switched socket outlet. 400 above floor unless indicated; H - High level / above worktop.
	Fused indicator spur.
	Extract Fan isolator switch with 'FAN' label/symbol @ H.L. above door.
	Covered weather proof double socket outlet for external application.
	Junction Box.
	Cooker Control Point
	Multi gang switch
	Shaver Socket.
	Volex Consumer Unit.
	T.V. aerial socket with coaxial cable to roof void / aerial.
	Telephone point.
	4 Plate Media Unit (TV Aerial / Telephone / SKY)
	Fibre Entry point - Optional (development specific item).
	Smoke detectors.
	Carbon Monoxide detectors.
	Radiators Single / double radiators, high output, thermostatic valves.
	Radiator: Combination towel rail / radiator to Bathrooms & En-suites.
	Heating control panel.
	Shower Controls
	Alarm Key Pad
	Mechanical air extract fan linked to light switch, Ventilation grill and duct to external wall extract point / Roof vent tile as indicated.
	Gas Point.
	External water tap.
	Doorbell.
	Door Chime.
	Car Charging Point

Extract duct to run through floor void above; Extract through external wall; Terminate with ventilation grille.

Single Sockets for appliance - Wired to Multi-gang switch under unit.

Optional external water tap

Cooker control point.  
Socket above wall unit for Cooker Hood.

Extract duct to run through floor void above; Extract through external wall; Terminate with ventilation grille.

Multi Gang switch for F/F, DW, Oven and Cooker Hood

Kitchen waste connections to suit Kitchen Layout.

Single Socket(s) for Appliance(s).

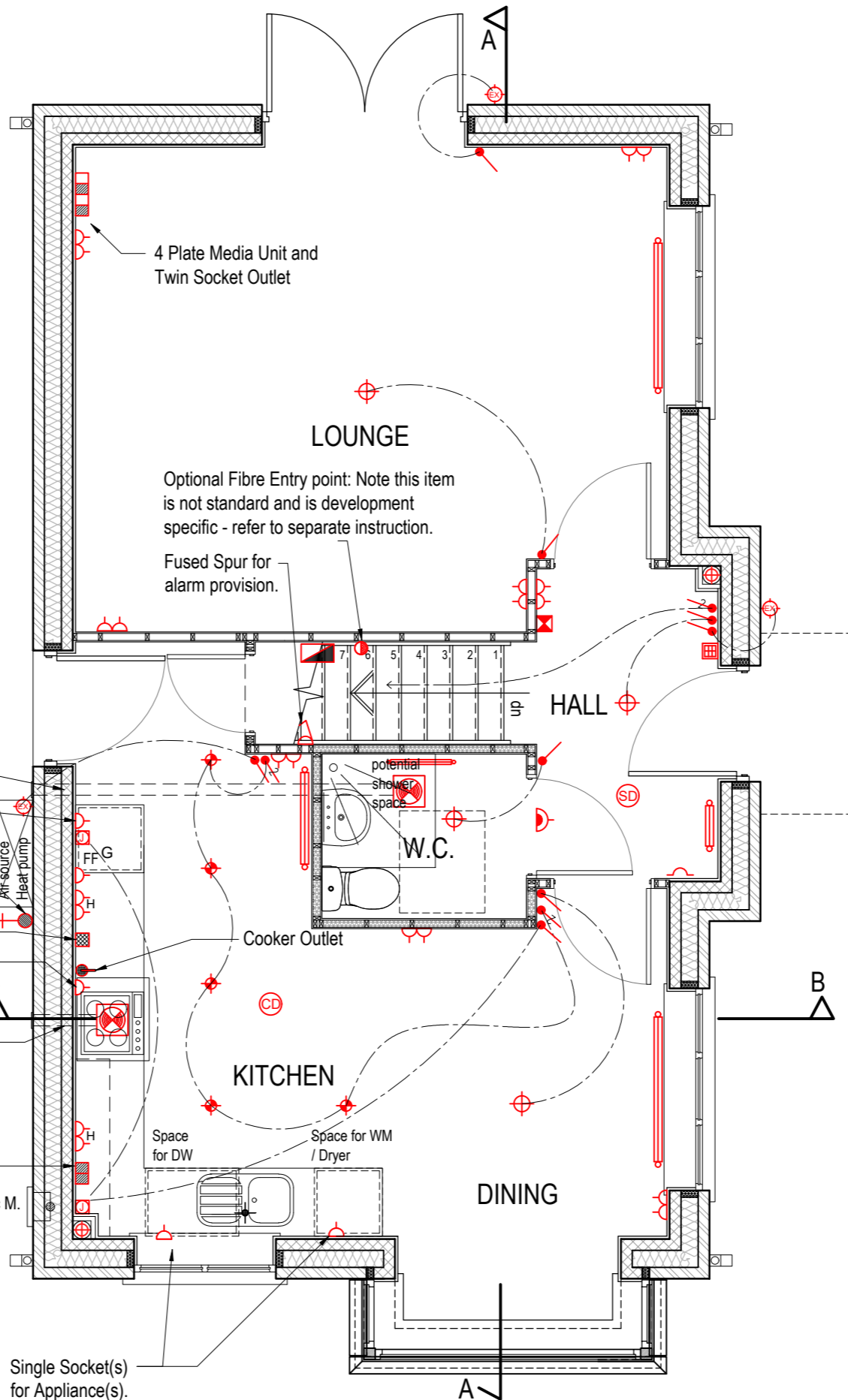

**Important:** This drawing is to be read in strict conjunction with Amethyst Homes Standard Specification and heat output drawings prepared by specialist. For radiator sizes and specification please refer to specialist drawings.

## GROUND FLOOR M&E LAYOUT - 1-50 Scale @ A3

REV	DATE	DESCRIPTION	BY	CHK
		<p><b>MWE</b> Mauchlen Weightman &amp; Elphick Architects</p> <p>Chartered Architects Town Planning Consultants Planning Supervisors Project Managers</p> <p>Heriot House 12 Summerhill Terrace Newcastle Upon Tyne NE4 6EB</p> <p>Telephone: (0191) 260 2299 Fax: (0191) 260 3340 Email: enquiries@mwearchitects.co.uk</p>		
		<p>Client <b>Amethyst Homes</b></p>		
		<p>Project <b>STANDARD HOUSE TYPES</b></p>		
		<p>Description <b>The Pearl GROUND FLOOR - M&amp;E LAYOUT</b></p>		
Project Ref.	<b>12009</b>	Dwg No.	<b>PRL-013</b>	
Scale:	1:50 @ A3	Rev.		
Date:	07.08.2023			
Drawn by:	TSP			
Checked by:		Date:		

THIS DRAWING IS COPYRIGHT. CONTRACTORS MUST CHECK ALL DIMENSIONS ON SITE. ONLY FIGURED DIMENSIONS ARE TO BE WORKED FROM. DISCREPANCIES MUST BE REPORTED IMMEDIATELY TO THE ARCHITECTS BEFORE PROCEEDING.