

# AMETHYST HOMES THE OPAL- AS HANDING

All drawings are to be read in conjunction with specification.

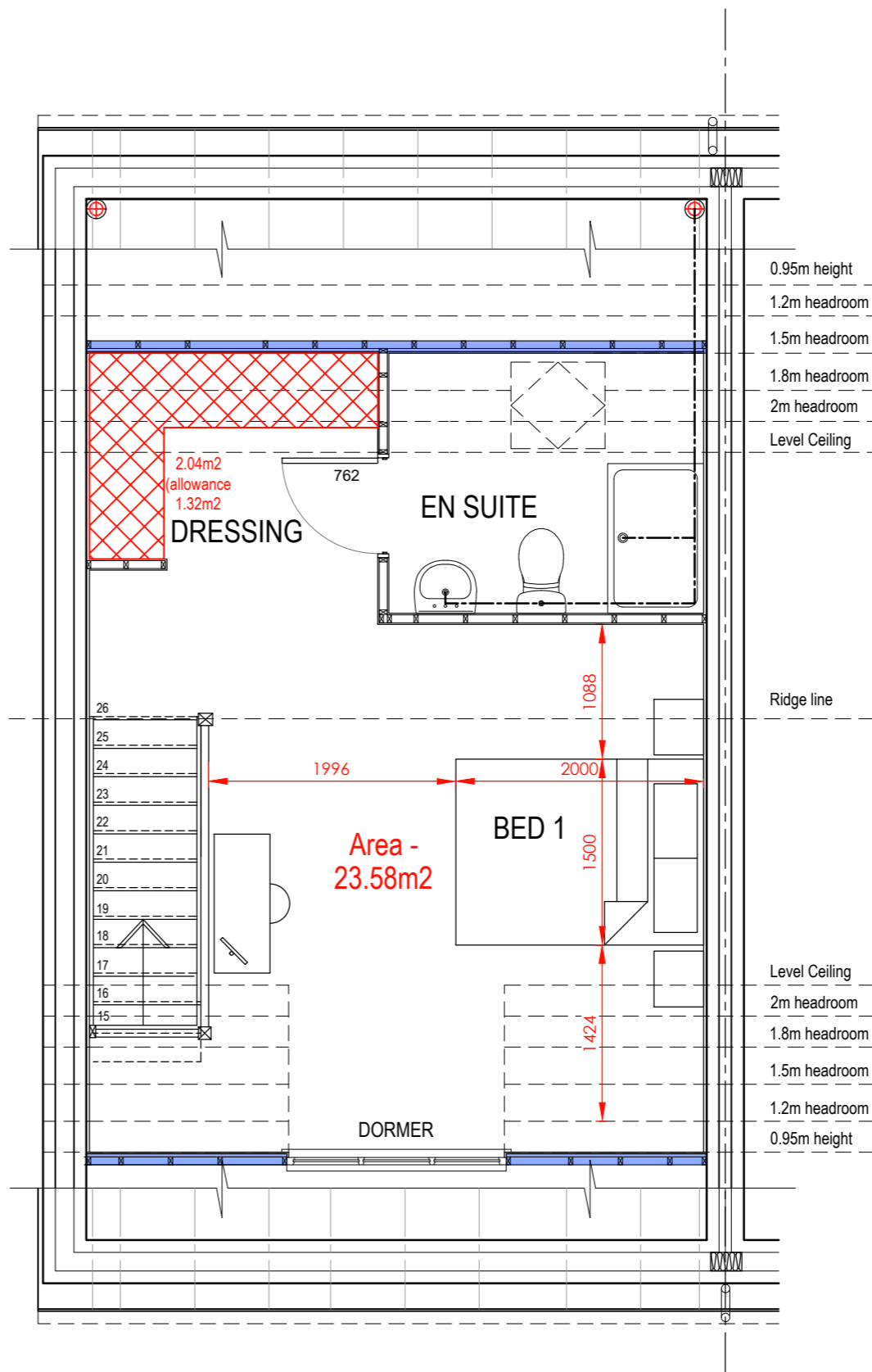

PROPERTY MISDESCRIPTIONS ACT 1991  
(Warning to House Purchasers)  
These drawings, and their contents, are for 'Construction' purposes only and may be subject to change at any time.  
Alterations and Variations may occur during the construction process, and therefore the layout, form, content, and dimensions of the completed construction may vary from that shown on these drawings.  
Every effort is made to constantly update the information shown however there may be situations of unavoidable delay due to changes in Statutory Regulations and/or re-planning. Purchasers are advised to check with the Sales Team to ascertain whether there have been any alterations to the printed information.

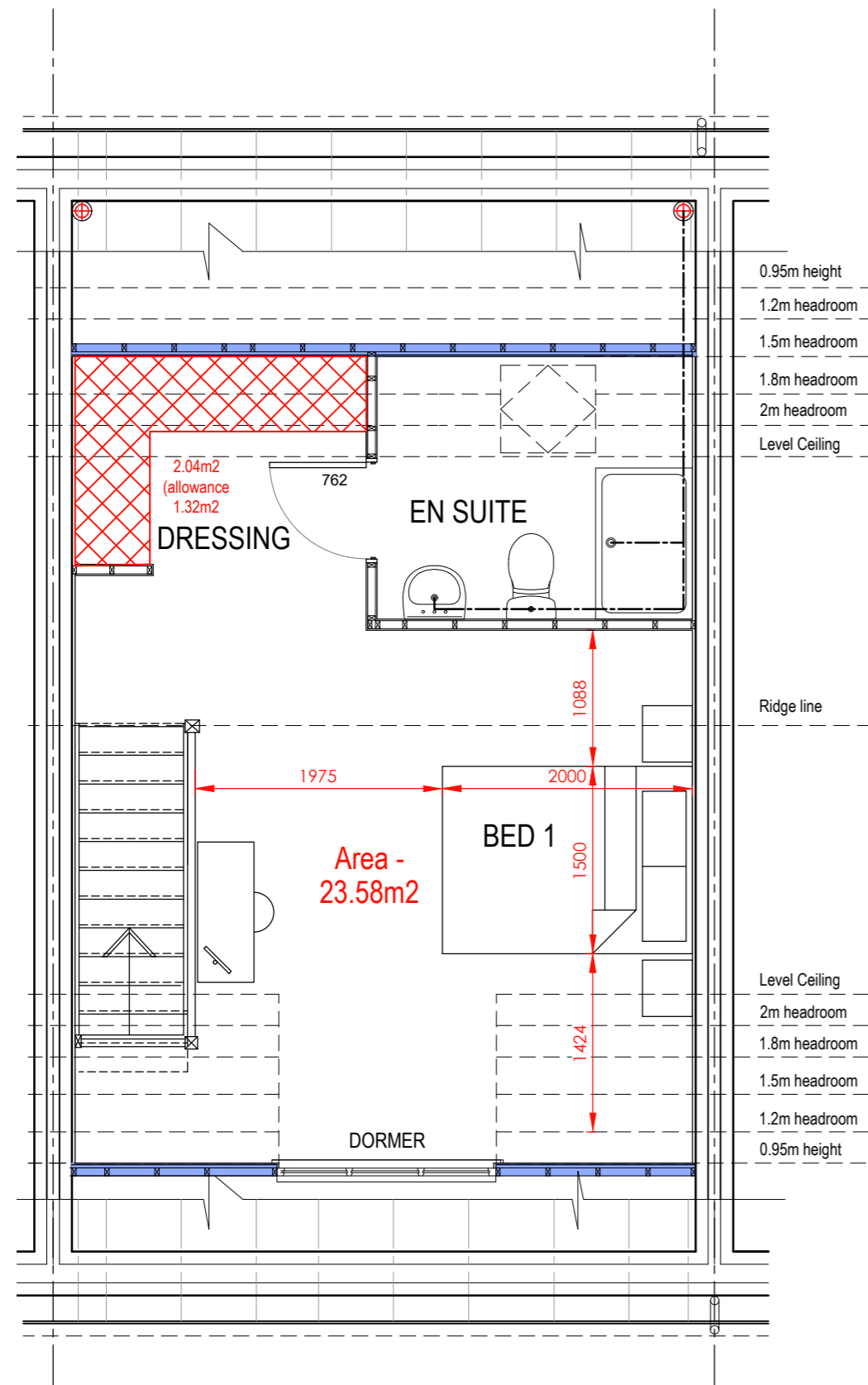

## PLANNING DRAWING - NDSS/M4(2) - 1-100 Scale @ A3

REV	DATE	DESCRIPTION	BY	CHK

**MWE**  
Mauchlen Weightman & Elphick  
Architects  
Chartered Architects  
Town Planning Consultants  
Planning Supervisors  
Project Managers  
Heriot House  
12 Summerhill Terrace  
Newcastle Upon Tyne  
NE4 6EB  
Telephone: (0191) 260 2299  
Fax: (0191) 260 3340  
Email: enquiries@mwearchitects.co.uk

Client  
**Amethyst Homes**

Project  
**STANDARD HOUSE TYPES**

Description  
**The Opal  
PLANNING - NDSS/M4(2) - SECOND FLOOR**

Project Ref.	<b>12009</b>	Dwg No.	<b>OPL-028</b>
Scale:	1:50 @ A3	Rev.	
Date:	July 2023		
Drawn by:	TSP		
Checked by:		Date:	

THIS DRAWING IS COPYRIGHT: CONTRACTORS MUST CHECK ALL DIMENSIONS ON SITE. ONLY FIGURED DIMENSIONS ARE TO BE WORKED FROM. DISCREPANCIES MUST BE REPORTED IMMEDIATELY TO THE ARCHITECTS BEFORE PROCEEDING.