

AMETHYST HOMES

THE OPAL - AS HANDING

All drawings are to be read in conjunction with specification.

Important: This drawing is to be read in strict conjunction with Amethyst Homes Standard Specification and heat output drawings prepared by specialist. For radiator sizes and specification please refer to specialist drawings.

M4(2) Specific notes-
Consumer units to be mounted so that the switches are between 1350mm and 1450mm above floor level.
Switches, sockets, stopcocks, and controls have their centre line between 450mm and 1200mm above floor level, and a minimum of 300mm (measured horizontally) from an inside corner.
Either
• All controls and thermostats are mounted between 900mm and 1200mm above finished floor level on the boiler or
• separate controllers (wired or wireless) are mounted elsewhere in an accessible location within the same height range.
Power supply required to ASHP to manufacturers requirements.



PROPERTY MISDESCRIPTIONS ACT 1991
(Warning to House Purchasers)
These drawings, and their contents, are for 'Construction' purposes only and may be subject to change at any time.
Alterations and Variations may occur during the construction process, and therefore the layout, form, content, and dimensions of the completed construction may vary from that shown on these drawings.
Every effort is made to constantly update the information shown however there may be situations of unavoidable delay due to changes in Statutory Regulations and/or re-planning. Purchasers are advised to check with the Sales Team to ascertain whether there have been any alterations to the printed information.

ELECTRICAL SYMBOLS KEY:	
	Twin / single tube luminaire, 58W daylight tubes.
	Basin pelmet light with integrated switch.
	Pendant ceiling lighting, energy efficient lamp.
	Batten lighting, energy efficient lamp.
	Recessed downlighter fitting.
	Water proof recessed downlighter fitting.
	Wall light.
	External lighting fitting.
	Location of Tri-lights below kitchen wall units.
	Single light switch.
	Two-way light switch.
	Immersion Switch.
	Cooker Outlet.
	Single switched socket outlet.
	13 amp double switched socket outlet, 400 above floor unless indicated.
	Fused indicator spur.
	Extract Fan isolator switch with 'FAN' label/symbol @ H.L. above door.
	Covered weather proof double socket outlet for external application.
	Junction Box.
	Cooker Control Point.
	Multi gang switch.
	Shaver Socket.
	Volex Consumer Unit.
	T.V. aerial socket with coaxial cable to roof void / aerial.
	Telephone point.
	4 Plate Media Unit (TV Aerial / Telephone / SKY).
	Fibre Entry point - Optional (development specific item).
	Smoke detectors.
	Carbon Monoxide detectors.
	Radiators Single / double radiators, high output, thermostatic valves.
	Radiator: Combination towel rail / radiator to Bathrooms & En-suites.
	Heating control panel.
	Shower Controls.
	Alarm Key Pad.
	Mechanical air extract fan linked to light switch, Ventilation grill and duct to external wall extract point / Roof vent tile as indicated.
	Gas Point.
	External water tap.
	Doorbell.
	Door Chime.
	Car Charging Point.

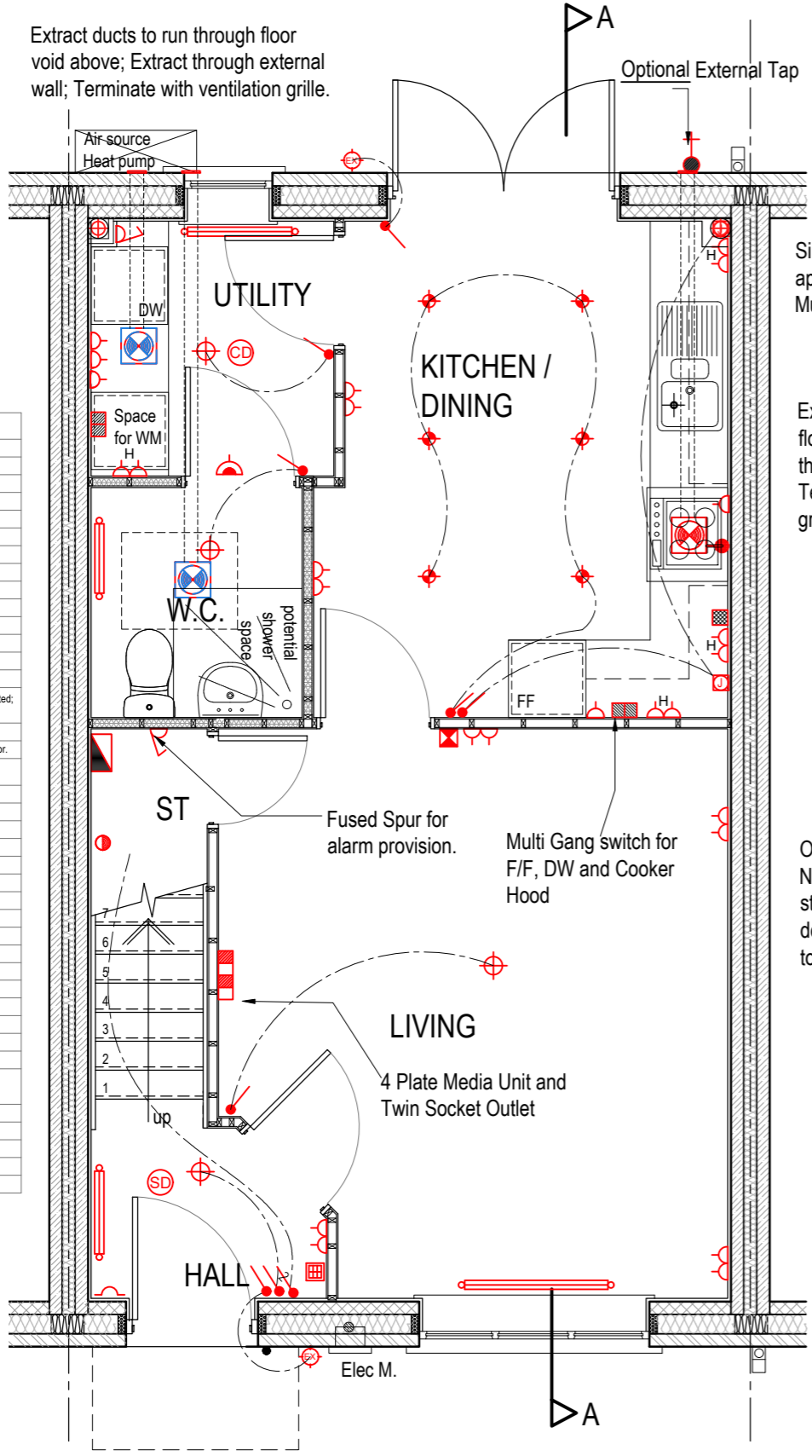

Mid Terrace Plot Layout

Single Sockets for appliances - Wired to Multi-gang switch under unit.

Extract ducts to run through floor void above; Extract through external wall; Terminate with ventilation grille.

Optional Fibre Entry point: Note this item is not standard and is development specific - refer to separate instruction.

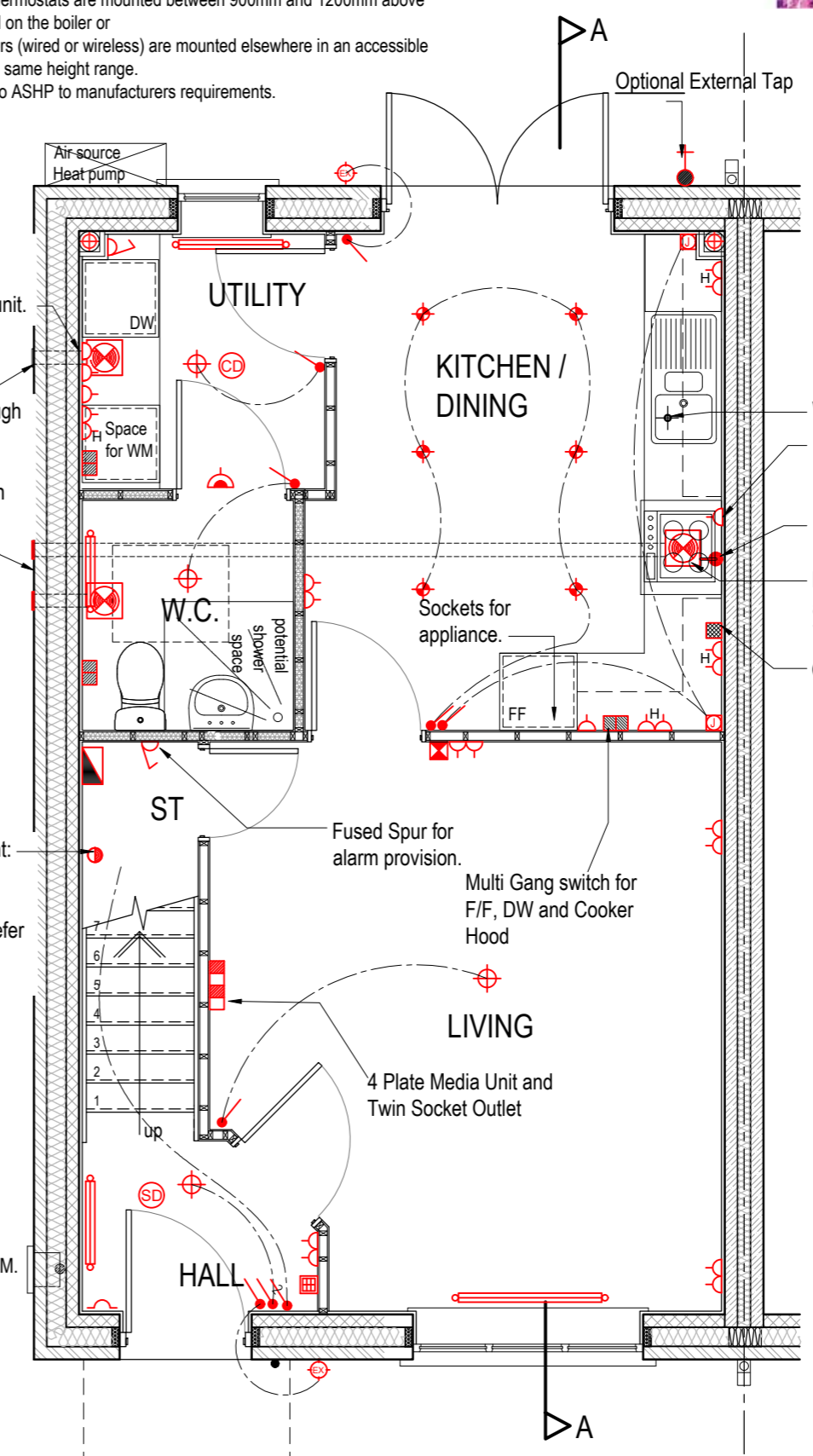

Semi-Detached Plot Layout

Optional Electric Vehicle Charging Points - Refer to Site Specific drawings and Amethyst Homes Specification.

REV	DATE	DESCRIPTION	BY	CHK

MWE Architects
Mauchlen Weightman & Elphick
Heriot House
12 Summerhill Terrace
Newcastle Upon Tyne
NE4 6EB
Telephone: (0191) 260 2299
Fax: (0191) 260 3340
Email: enquiries@mwearchitects.co.uk

Client
Amethyst Homes

Project
STANDARD HOUSE TYPES

Description
**The Opal
GROUND FLOOR - M&E LAYOUT**

Project Ref.	12009	Dwg No.	OPL-015
Scale:	1:50 @ A3	Rev.	
Date:	July 2023		
Drawn by:	TSP		
Checked by:		Date:	

THIS DRAWING IS COPYRIGHT: CONTRACTORS MUST CHECK ALL DIMENSIONS ON SITE. ONLY FIGURED DIMENSIONS ARE TO BE WORKED FROM. DISCREPANCIES MUST BE REPORTED IMMEDIATELY TO THE ARCHITECTS BEFORE PROCEEDING.

GROUND FLOOR M&E LAYOUT - 1-50 Scale @ A3