

W O O D

T H E

B Y

M A R C E N

S 3 7 0

63'0"

103'0"

179'0"

30'0"

128'0"

30'0"

126'0"

30'0"

125'0"

30'0"

123'0"

30'0"

122'0"

30'0"

120'0"

30'0"

118'0"

30'0"

116'0"

30'0"

114'0"

30'0"

112'0"

30'0"

110'0"

30'0"

DEVELOPMENT.

EXING

DEVELOPMENT.

MEASUREMENTS ARE APPROXIMATE ONLY

SCALE 1:500 H



O P E N

S P A C E .

H.M. LAND REGISTRY

TITLE No. HD 31054

PHOTOGRAPHIC COPY (liable to distortion in scale)

of PLAN to transfer dated 9/3/62

of PLAN to transfer dated 9/3/62

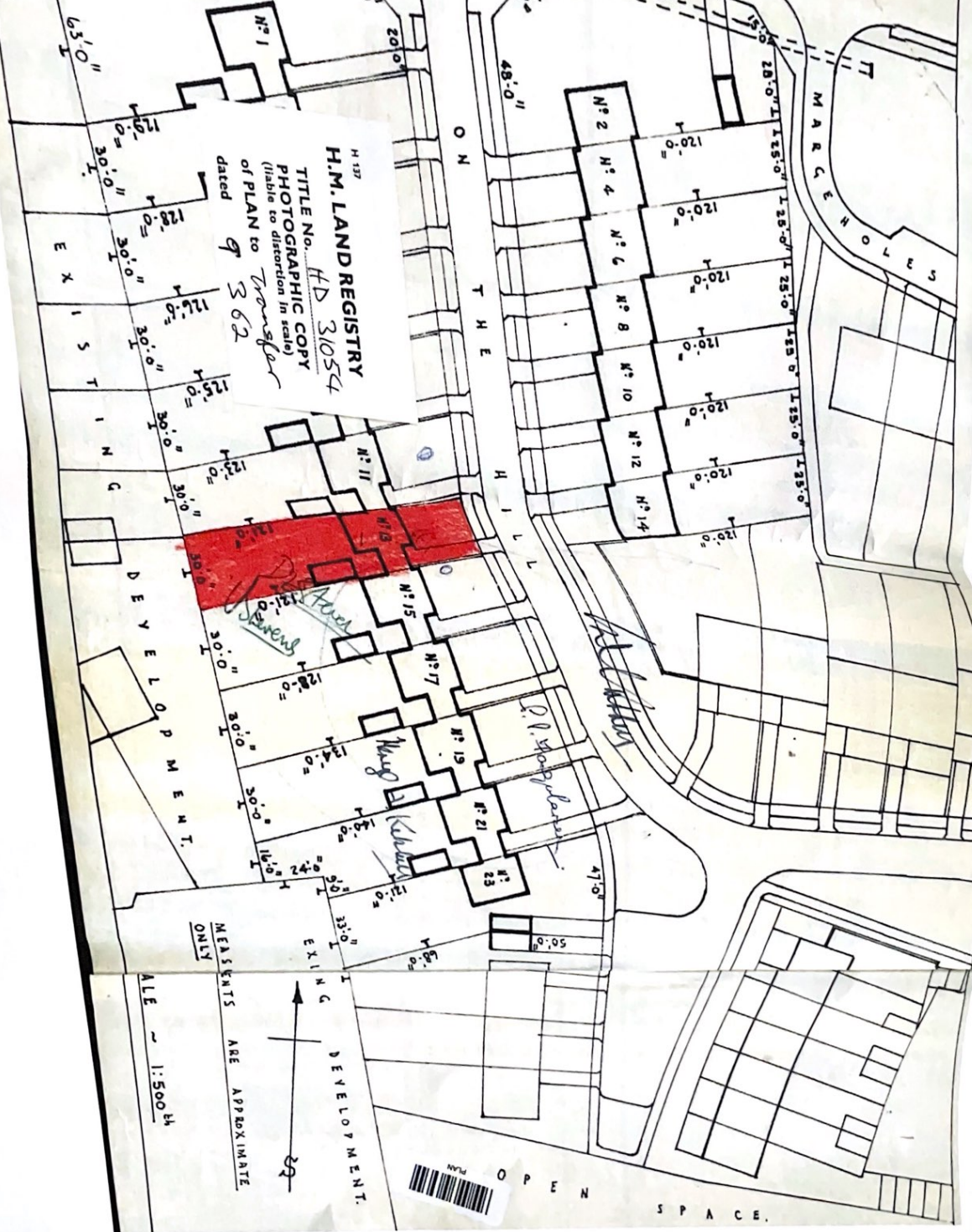
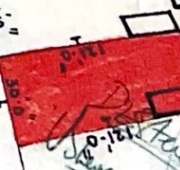

EXISTING

DEVELOPMENT.

DEVELOPMENT.

H. M. LAND REGISTRY

HERTFORDSHIRE SHEET XLIV 10

Scale 1/1250
Enlarged from 1/2500

WATFORD RURAL PARISH



Made and printed by the Director
General of the Ordnance Survey,
Chessington, Surrey, 1962 for HMLR
Crown Copyright 1962



Filed Plan of Title No. **HD 31054**