

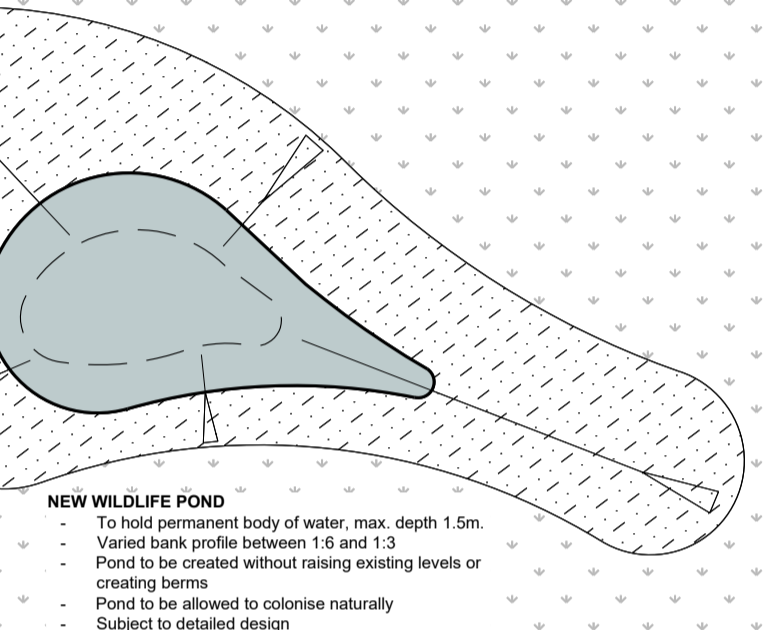

Refer to D3296-FAB-00-XX-DR-L-1002

Refer to D3296-FAB-00-XX-DR-L-1004

Refer to D3296-FAB-00-XX-DR-L-1007



NEW WILDLIFE POND
 To hold permanent body of water, max. depth 1.5m.
 Varied bank profile between 1:6 and 1:3
 Pond to be created without raising existing levels or creating berms
 Pond to be allowed to colonise naturally
 Subject to detailed design

EXISTING WATERCOURSE
 - Existing hedgerow, vegetation and grassland sward margin to be retained

Existing post and rail fence retained

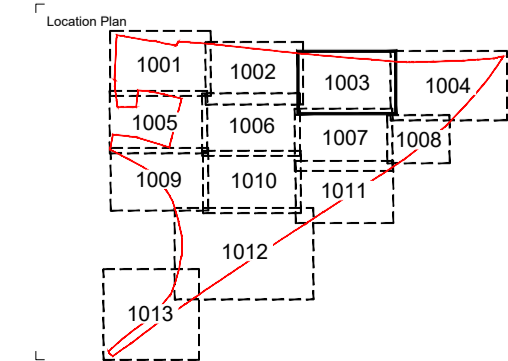
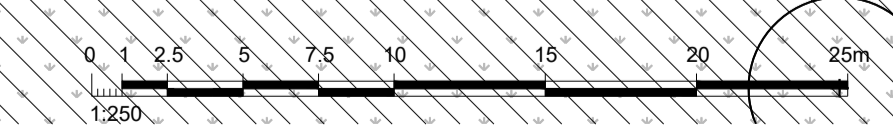

fabik landscape architects
 Lenton House | 15 Lenton Street | Abingdon | Hampshire | GU24 1HG
 T: 01245 932350 | E: alton@fabrik.com | W: www.fabrik.com

Project: **The One Murphy Orlerton Hub** Client: **J. Murphy**
 Drawing Title: **Soft Landscape General Arrangement Plan - Sheet 3 of 13**
 Issued For: **ISSUED FOR PLANNING APPROVAL** Drawn By: **sw** Checked By: **sg** Drawn Scale: **1:250 @ A1** Date of First Issue: **dec 2023**

Project Number	Client	Zone	Level	File Type	Issue	Number	Revision
D3296	FAB	00	XX	DR	L	1003	PL02

PL02	08.02.24	Issued For Planning	Drawn By	Checked By	sw	sg
PL01	01.12.23	First Issue	Drawn	Checked		

Disclaimer:
 1. This drawing is copyright of fabrik ltd. It must not be copied or reproduced without written consent from the owner.
 2. Do not scale from this drawing. Only figured dimensions are to be taken from this drawing.
 3. All contractors must read and be responsible for taking and checking all dimensions related to the works shown on the drawing prior to fabrication or setting out.
 4. This drawing uses coloured lines. Please do not rely on a monochrome copy.

External References: