

Historical Mapping Legends

Ordnance Survey County Series and Ordnance Survey Plan 1:2,500

Quarry **Gravel Pit** **Sand Pit**
Clay Pit **Shingle** **Refuse Heap**
Sloping Masonry **Flat Rock**
Marsh **Reeds** **Osiers**
Rough Pasture **Furze** **Wood**
Mixed Wood **Brushwood** **Orchard**
Fir **Ford** **Stepping Stones**
Ferry **Waterfall** **Lock**
Trig. Station **Altitude at Trig. Station**
B.M. 325.9 **Bench Mark** **Surface Level**
Arrow denotes flow of water **Antiquities (site of)**
Cutting **Embankment**
Railway crossing Road **Level Crossing** **Road crossing Railway**
Railway crossing River or Canal **Road over single stream** **Road over River or Canal**
County Boundary (Geographical)
County & Civil Parish Boundary
Administrative County & Civil Parish Boundary
County Borough Boundary (England)
Co. Boro. Bdy.
County Burgh Boundary (Scotland)
Boundary Post or Stone **Police Call Box**
B.R. **Bridle Road** **P** **Pump**
E.P. **Electricity Pylon** **S.P.** **Signal Post**
F.B. **Foot Bridge** **Sl.** **Sluice**
F.P. **Foot Path** **Sp.** **Spring**
G.P. **Guide Post or Board** **T.C.B.** **Telephone Call Box**
M.S. **Mile Stone** **Tr.** **Trough**
M.P. M.R. **Mooring Post or Ring** **W** **Well**

Ordnance Survey Plan, Additional SIMs and Supply of Unpublished Survey Information 1:2,500 and 1:1,250

Inactive Quarry, Chalk Pit or Clay Pit **Active Quarry, Chalk Pit or Clay Pit**
Rock **Boulders**
Cliff **Slopes** **Top**
Roofed Building **Glazed Roof Building**
Sloping Masonry **Archway**
Non-Coniferous Tree (surveyed) **Coniferous Tree (surveyed)**
Non-Coniferous Trees (not surveyed) **Coniferous Trees (not surveyed)**
Orchard Tree **Scrub** **Bracken**
Coppice, Osier **Reeds** **Marsh, Saltings**
Rough Grassland **Heath** **Culvert**
Direction of water flow **Bench Mark** **Antiquity (site of)**
Cave Entrance **Triangulation Station** **Electricity Pylon**
Electricity Transmission Line
County Boundary (Geographical)
County & Civil Parish Boundary
Civil Parish Boundary
Admin. County or County Bor. Boundary
London Borough Boundary
Symbol marking point where boundary mereing changes
BH **Beer House** **P** **Pillar, Pole or Post**
BP, BS **Boundary Post or Stone** **PO** **Post Office**
Cn, C **Capstan, Crane** **PC** **Public Convenience**
Chy **Chimney** **PH** **Public House**
D Fn **Drinking Fountain** **Pp** **Pump**
EI P **Electricity Pillar or Post** **SB, S Br** **Signal Box or Bridge**
FAP **Fire Alarm Pillar** **SP, SL** **Signal Post or Light**
FB **Foot Bridge** **Spr** **Spring**
GP **Guide Post** **Tk** **Tank or Track**
H **Hydrant or Hydraulic** **TCB** **Telephone Call Box**
LC **Level Crossing** **TCP** **Telephone Call Post**
MH **Manhole** **Tr** **Trough**
MP **Mile Post or Mooring Post** **Wr Pt, Wr T** **Water Point, Water Tap**
MS **Mile Stone** **W** **Well**
NTL **Normal Tidal Limit** **Wd Pp** **Wind Pump**

Large-Scale National Grid Data 1:2,500 and 1:1,250

Cliff **Slopes** **Top**
Rock **Rock (scattered)**
Boulders **Boulders (scattered)**
Positioned Boulder **Scree**
Non-Coniferous Tree (surveyed) **Coniferous Tree (surveyed)**
Non-Coniferous Trees (not surveyed) **Coniferous Trees (not surveyed)**
Orchard Tree **Scrub** **Bracken**
Coppice, Osier **Reeds** **Marsh, Saltings**
Rough Grassland **Heath** **Culvert**
Direction of water flow **Triangulation Station** **Antiquity (site of)**
Electricity Transmission Line **Electricity Pylon**
B.M. 231.60m **Bench Mark** **Buildings with Building Seed**
Roofed Building **Glazed Roof Building**
Civil parish/community boundary
District boundary
County boundary
Boundary post/stone
Boundary mereing symbol (note: these always appear in opposed pairs or groups of three)
Bks **Barracks** **P** **Pillar, Pole or Post**
Bty **Battery** **PO** **Post Office**
Cemy **Cemetery** **PC** **Public Convenience**
Chy **Chimney** **Pp** **Pump**
Cis **Cistern** **Ppg Sta** **Pumping Station**
Dismtd Rly **Dismantled Railway** **PW** **Place of Worship**
EI Gen Sta **Electricity Generating Station** **Sewage Ppg Sta** **Sewage Pumping Station**
EI P **Electricity Pole, Pillar** **SB, S Br** **Signal Box or Bridge**
EI Sub Sta **Electricity Sub Station** **SP, SL** **Signal Post or Light**
FB **Filter Bed** **Spr** **Spring**
Fn / D Fn **Fountain / Drinking Ftn.** **Tk** **Tank or Track**
Gas Gov **Gas Valve Compound** **Tr** **Trough**
GVC **Gas Governor** **Wd Pp** **Wind Pump**
GP **Guide Post** **Wr Pt, Wr T** **Water Point, Water Tap**
MH **Manhole** **Wks** **Works (building or area)**
MP, MS **Mile Post or Mile Stone** **W** **Well**



Historical Mapping & Photography included:

Mapping Type	Scale	Date	Pg
Nottinghamshire	1:2,500	1885	2
Nottinghamshire	1:2,500	1899 - 1900	3
Nottinghamshire	1:2,500	1919 - 1920	4
Nottinghamshire	1:2,500	1938	5
Ordnance Survey Plan	1:2,500	1960	6
Ordnance Survey Plan	1:2,500	1973 - 1990	7
Additional SIMs	1:2,500	1988	8
Large-Scale National Grid Data	1:2,500	1994	9
Large-Scale National Grid Data	1:2,500	1996	10
Historical Aerial Photography	1:2,500	1999	11

Historical Map - Segment A11

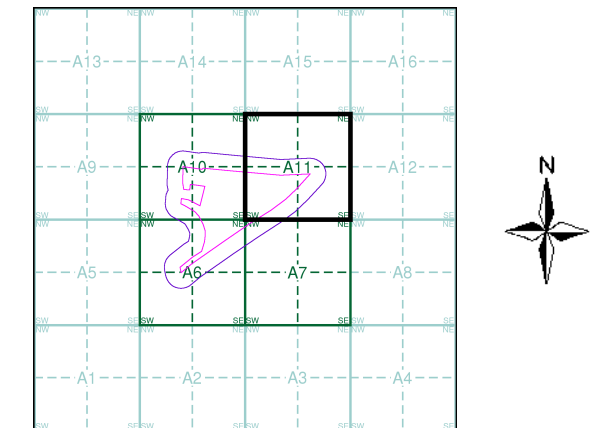

Order Details

Order Number: 303045175_1_1
 Customer Ref: DS70791
 National Grid Reference: 467040, 367010
 Slice: A
 Site Area (Ha): 23.
 Search Buffer (m): 100

Site Details

Site located at 335200,671890



Tel: 0844 844 9952
 Fax: 0844 844 9951
 Web: www.envirocheck.co.uk

Nottinghamshire

Published 1885

Source map scale - 1:2,500

The historical maps shown were reproduced from maps predominantly held at the scale adopted for England, Wales and Scotland in the 1840's. In 1854 the 1:2,500 scale was adopted for mapping urban areas and by 1896 it covered the whole of what were considered to be the cultivated parts of Great Britain. The published date given below is often some years later than the surveyed date. Before 1938, all OS maps were based on the Cassini Projection, with independent surveys of a single county or group of counties, giving rise to significant inaccuracies in outlying areas.

Map Name(s) and Date(s)

019_14	1885	1:2,500
024_02	1885	1:2,500

Historical Map - Segment A11

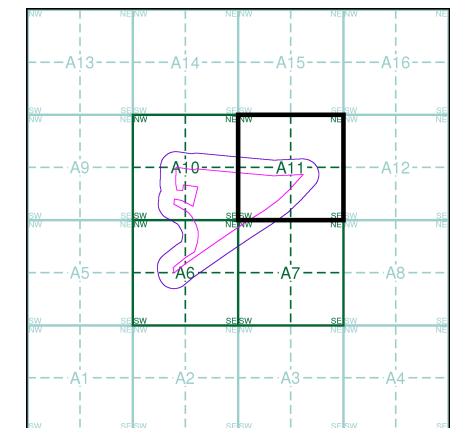

Order Details

Order Number: 303045175_1_1
 Customer Ref: DS70791
 National Grid Reference: 467040, 367010
 Slice: A
 Site Area (Ha): 23.
 Search Buffer (m): 100

Site Details

Site located at 335200,671890

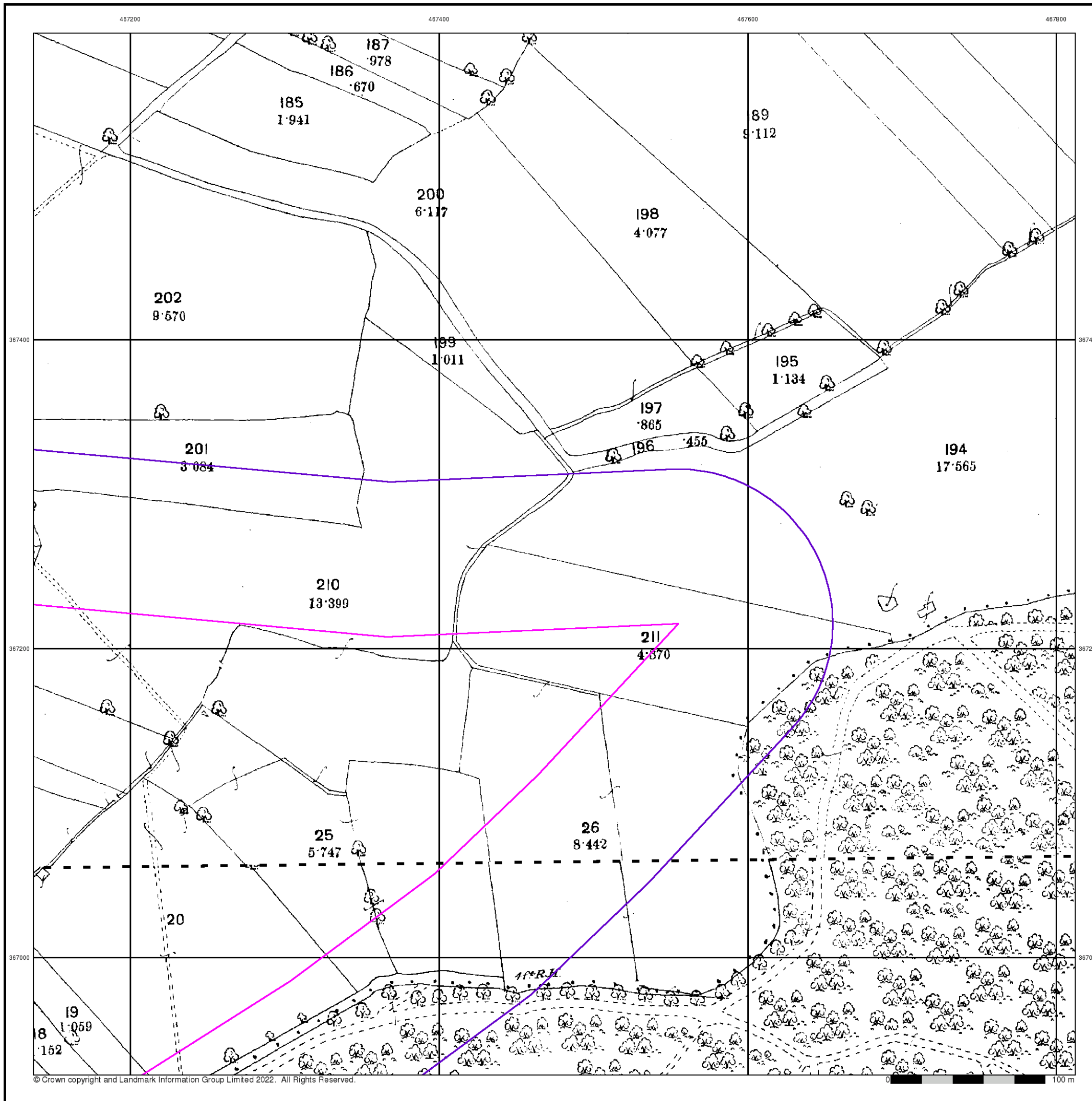

Nottinghamshire

Published 1899 - 1900

Source map scale - 1:2,500

The historical maps shown were reproduced from maps predominantly held at the scale adopted for England, Wales and Scotland in the 1840's. In 1854 the 1:2,500 scale was adopted for mapping urban areas and by 1896 it covered the whole of what were considered to be the cultivated parts of Great Britain. The published date given below is often some years later than the surveyed date. Before 1938, all OS maps were based on the Cassini Projection, with independent surveys of a single county or group of counties, giving rise to significant inaccuracies in outlying areas.

Map Name(s) and Date(s)

019_14	1899	1:2,500
024_02	1900	1:2,500

Historical Map - Segment A11

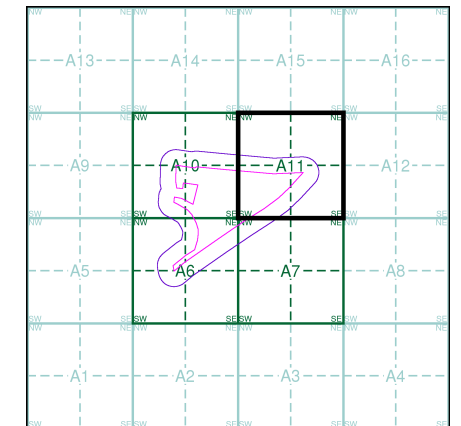

Order Details

Order Number: 303045175_1_1
 Customer Ref: DS70791
 National Grid Reference: 467040, 367010
 Slice: A
 Site Area (Ha): 23.
 Search Buffer (m): 100

Site Details

Site located at 335200,671890

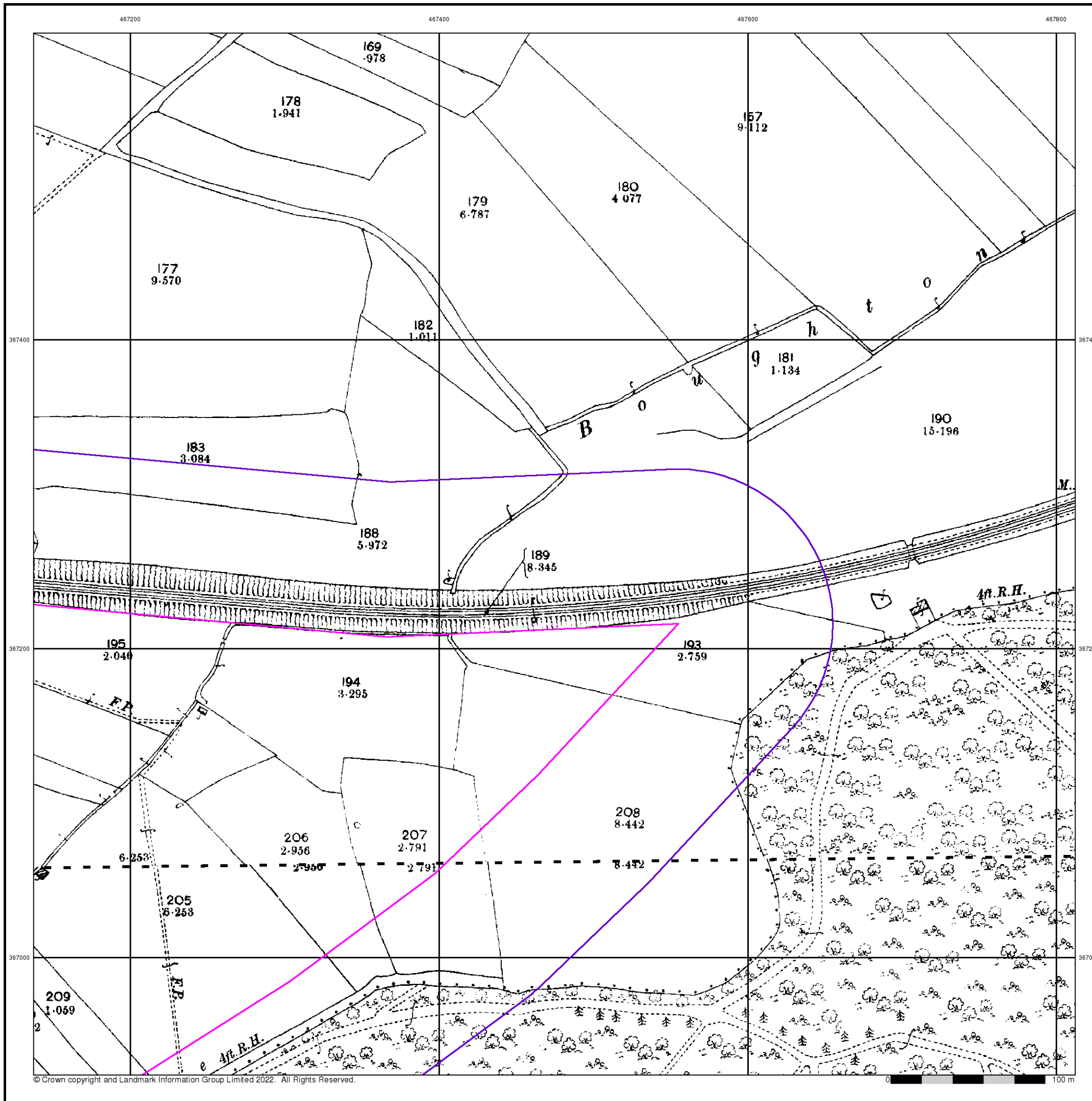

Nottinghamshire

Published 1919 - 1920

Source map scale - 1:2,500

The historical maps shown were reproduced from maps predominantly held at the scale adopted for England, Wales and Scotland in the 1840's. In 1854 the 1:2,500 scale was adopted for mapping urban areas and by 1896 it covered the whole of what were considered to be the cultivated parts of Great Britain. The published date given below is often some years later than the surveyed date. Before 1938, all OS maps were based on the Cassini Projection, with independent surveys of a single county or group of counties, giving rise to significant inaccuracies in outlying areas.

Map Name(s) and Date(s)

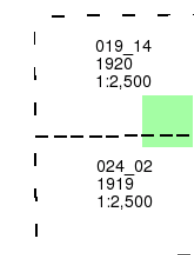

Historical Map - Segment A11

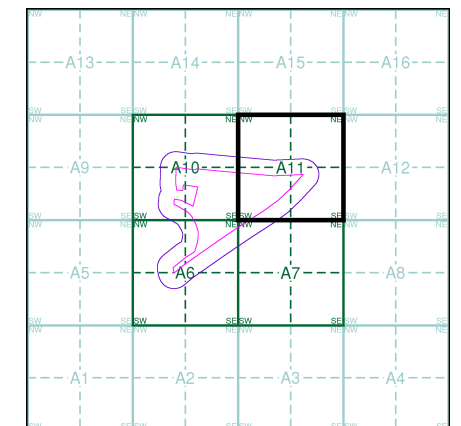

Order Details

Order Number: 303045175_1_1
 Customer Ref: DS70791
 National Grid Reference: 467040, 367010
 Slice: A
 Site Area (Ha): 23.
 Search Buffer (m): 100

Site Details

Site located at 335200,671890

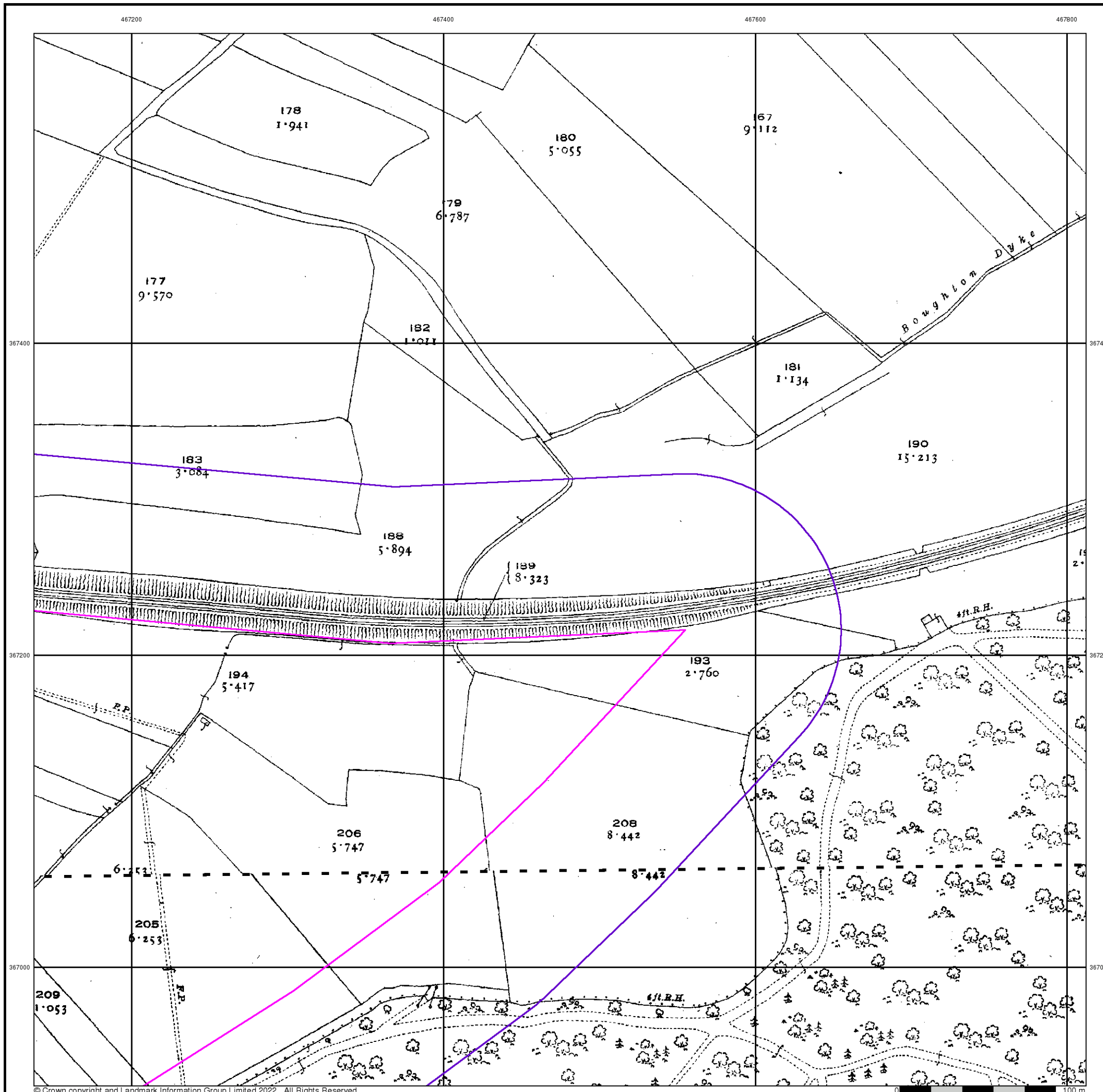

Nottinghamshire

Published 1938

Source map scale - 1:2,500

The historical maps shown were reproduced from maps predominantly held at the scale adopted for England, Wales and Scotland in the 1840's. In 1854 the 1:2,500 scale was adopted for mapping urban areas and by 1896 it covered the whole of what were considered to be the cultivated parts of Great Britain. The published date given below is often some years later than the surveyed date. Before 1938, all OS maps were based on the Cassini Projection, with independent surveys of a single county or group of counties, giving rise to significant inaccuracies in outlying areas.

Map Name(s) and Date(s)

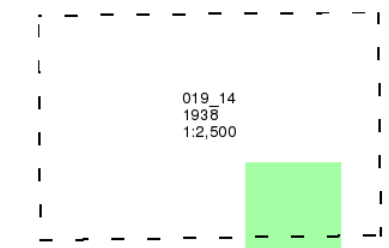

Historical Map - Segment A11

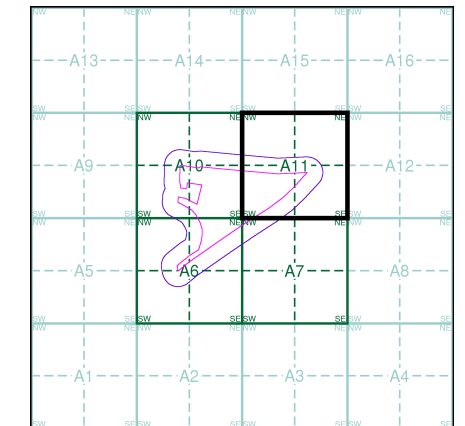

Order Details

Order Number: 303045175_1_1
 Customer Ref: DS70791
 National Grid Reference: 467040, 367010
 Slice: A
 Site Area (Ha): 23.
 Search Buffer (m): 100

Site Details

Site located at 335200,671890

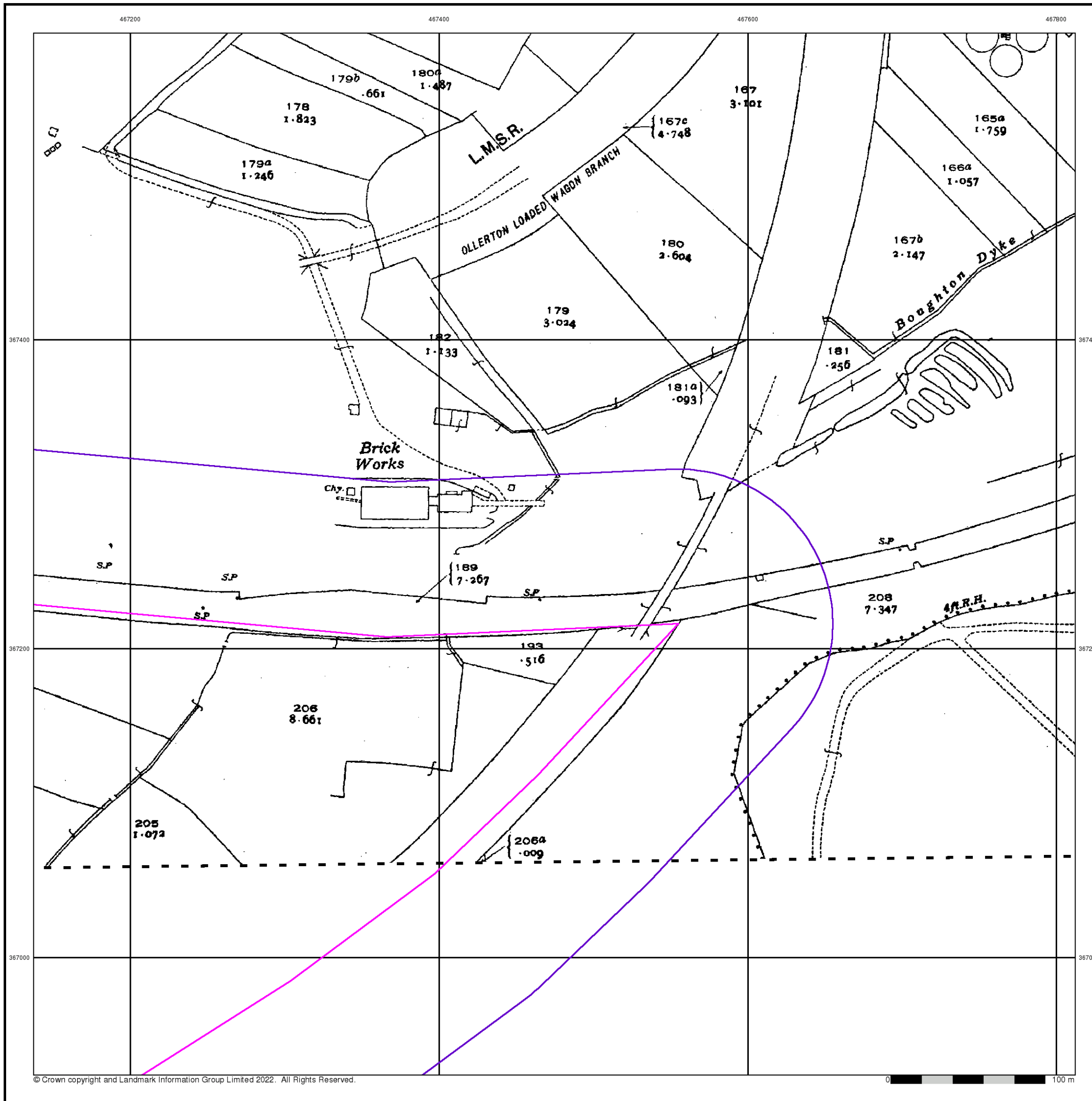

Ordnance Survey Plan

Published 1960

Source map scale - 1:2,500

The historical maps shown were reproduced from maps predominantly held at the scale adopted for England, Wales and Scotland in the 1840's. In 1854 the 1:2,500 scale was adopted for mapping urban areas and by 1896 it covered the whole of what were considered to be the cultivated parts of Great Britain. The published date given below is often some years later than the surveyed date. Before 1938, all OS maps were based on the Cassini Projection, with independent surveys of a single county or group of counties, giving rise to significant inaccuracies in outlying areas.

Map Name(s) and Date(s)

SK6767	1960	1:2,500
SK6766	1960	1:2,500

Historical Map - Segment A11

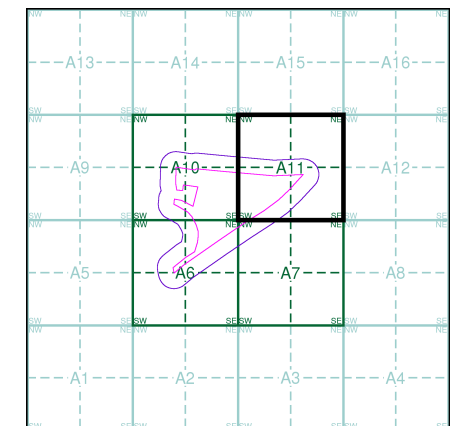

Order Details

Order Number: 303045175_1_1
 Customer Ref: DS70791
 National Grid Reference: 467040, 367010
 Slice: A
 Site Area (Ha): 23.
 Search Buffer (m): 100

Site Details

Site located at 335200,671890

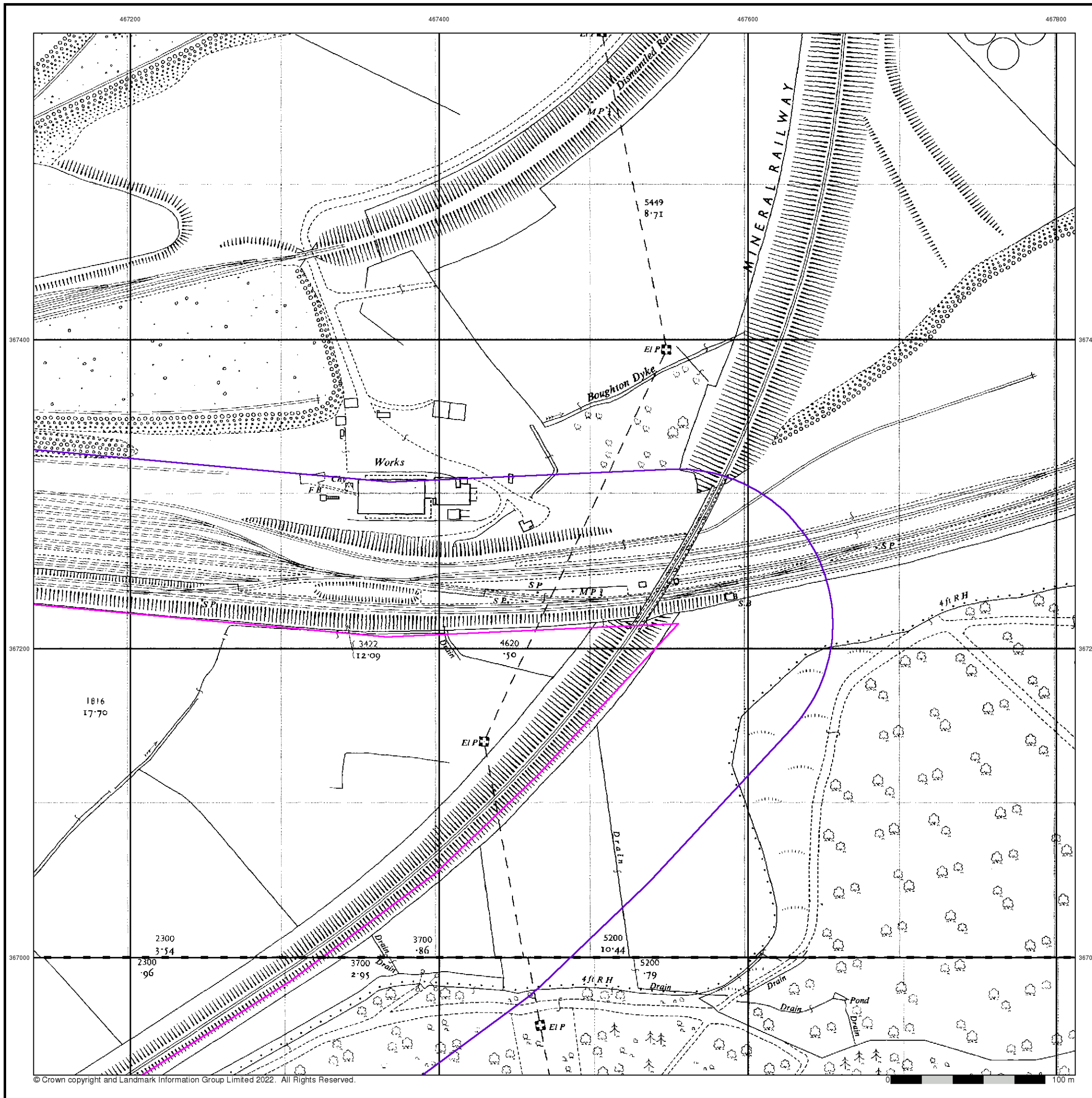

Ordnance Survey Plan
Published 1973 - 1990
Source map scale - 1:2,500

The historical maps shown were reproduced from maps predominantly held at the scale adopted for England, Wales and Scotland in the 1840's. In 1854 the 1:2,500 scale was adopted for mapping urban areas and by 1896 it covered the whole of what were considered to be the cultivated parts of Great Britain. The published date given below is often some years later than the surveyed date. Before 1938, all OS maps were based on the Cassini Projection, with independent surveys of a single county or group of counties, giving rise to significant inaccuracies in outlying areas.

Map Name(s) and Date(s)

SK6767	1973	1:2,500
SK6766	1990	1:2,500

Historical Map - Segment A11

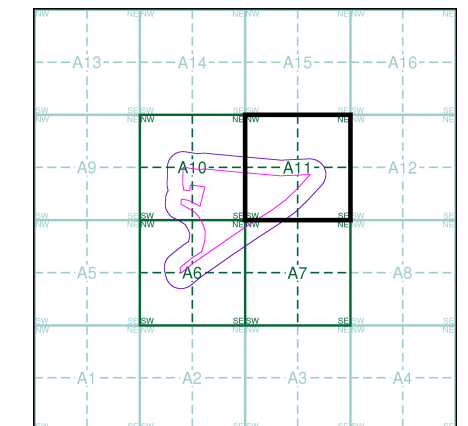

Order Details

Order Number: 303045175_1_1
 Customer Ref: DS70791
 National Grid Reference: 467040, 367010
 Slice: A
 Site Area (Ha): 23.
 Search Buffer (m): 100

Site Details

Site located at 335200,671890

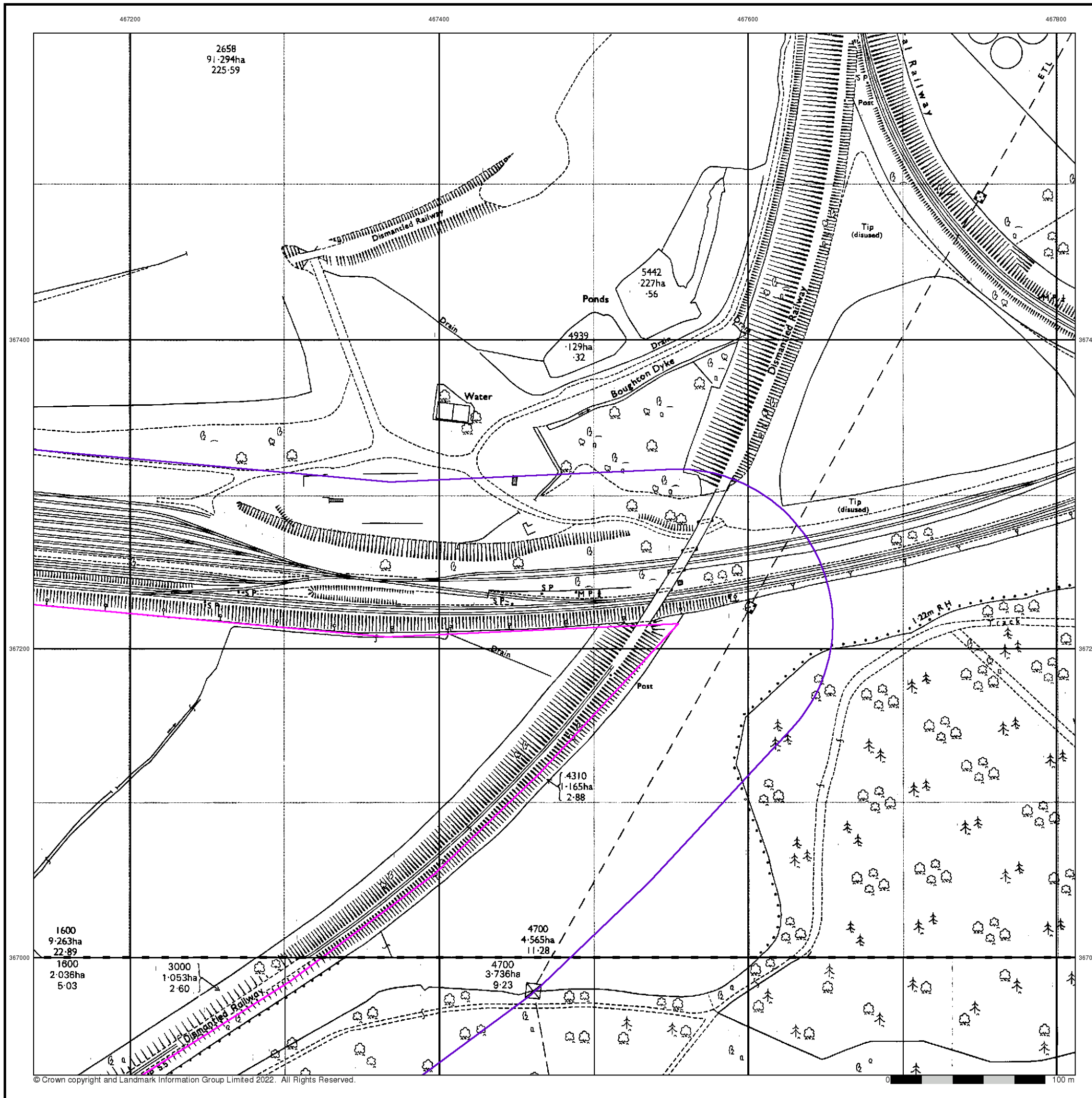

Additional SIMs

Published 1988

Source map scale - 1:2,500

The SIM cards (Ordnance Survey's 'Survey of Information on Microfilm') are further, minor editions of mapping which were produced and published in between the main editions as an area was updated. They date from 1947 to 1994, and contain detailed information on buildings, roads and land-use. These maps were produced at both 1:2,500 and 1:1,250 scales.

Map Name(s) and Date(s)

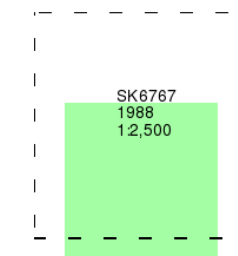

Historical Map - Segment A11

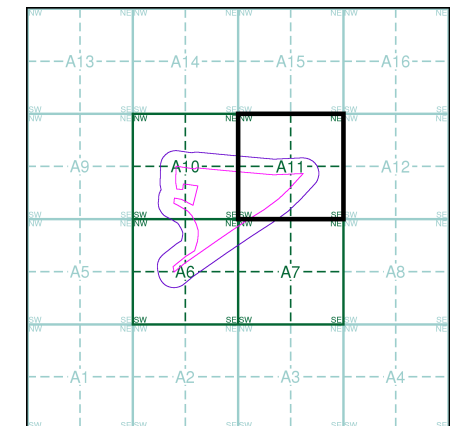

Order Details

Order Number: 303045175_1_1
 Customer Ref: DS70791
 National Grid Reference: 467040, 367010
 Slice: A
 Site Area (Ha): 23.
 Search Buffer (m): 100

Site Details

Site located at 335200,671890

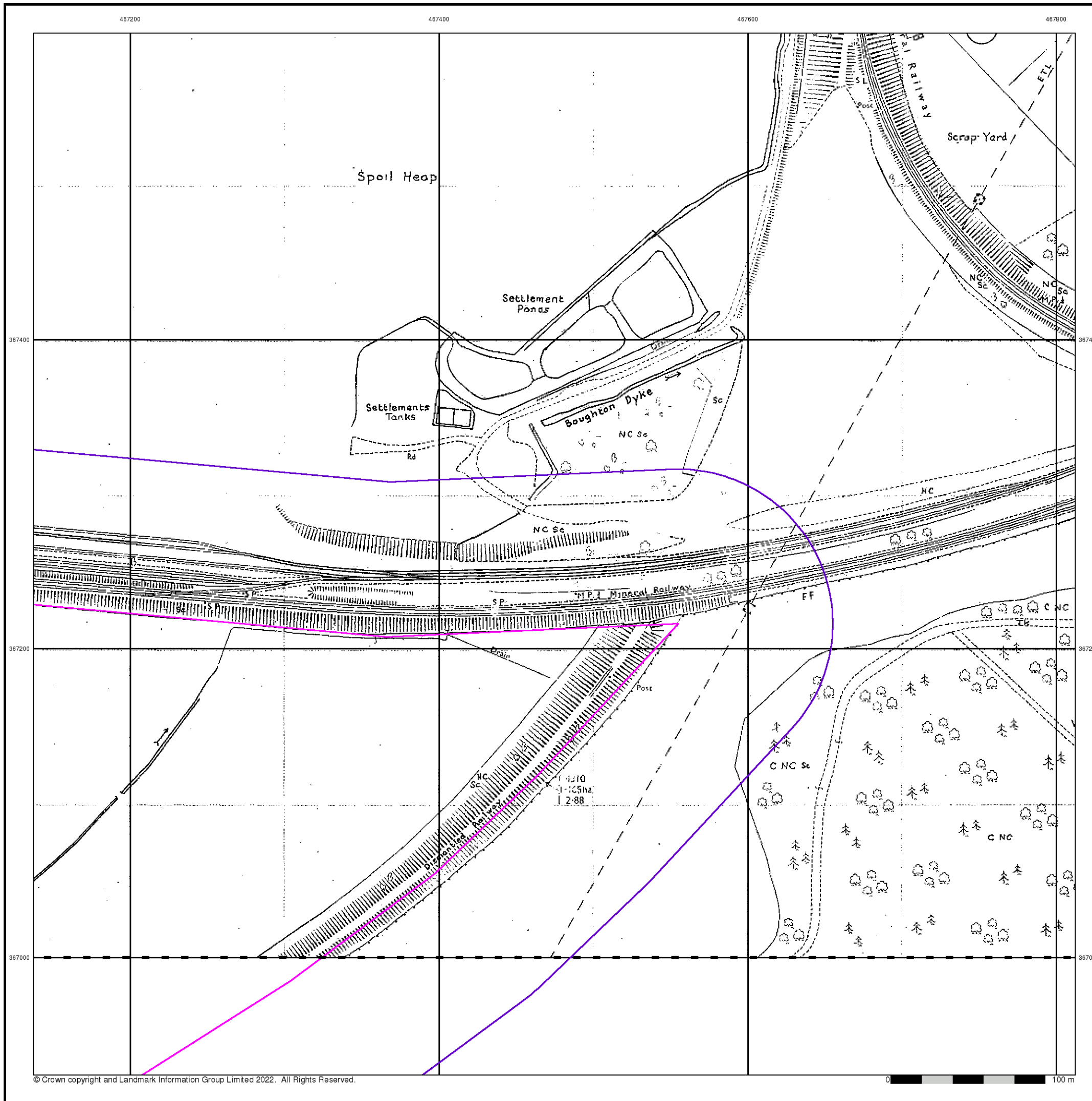

Large-Scale National Grid Data
Published 1994
Source map scale - 1:2,500

'Large Scale National Grid Data' superseded SIM cards (Ordnance Survey's 'Survey of Information on Microfilm') in 1992, and continued to be produced until 1999. These maps were the fore-runners of digital mapping and so provide detailed information on houses and roads, but tend to show less topographic features such as vegetation. These maps were produced at both 1:2,500 and 1:1,250 scales.

Map Name(s) and Date(s)

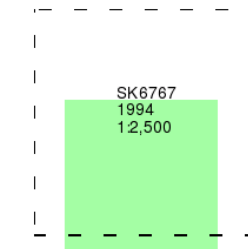

Historical Map - Segment A11

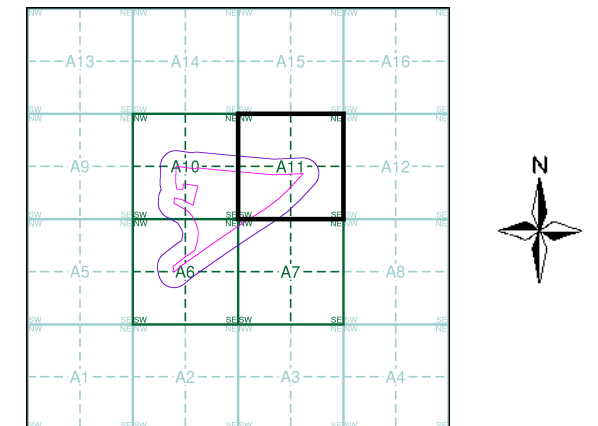

Order Details

Order Number: 303045175_1_1
 Customer Ref: DS70791
 National Grid Reference: 467040, 367010
 Slice: A
 Site Area (Ha): 23.
 Search Buffer (m): 100

Site Details

Site located at 335200,671890

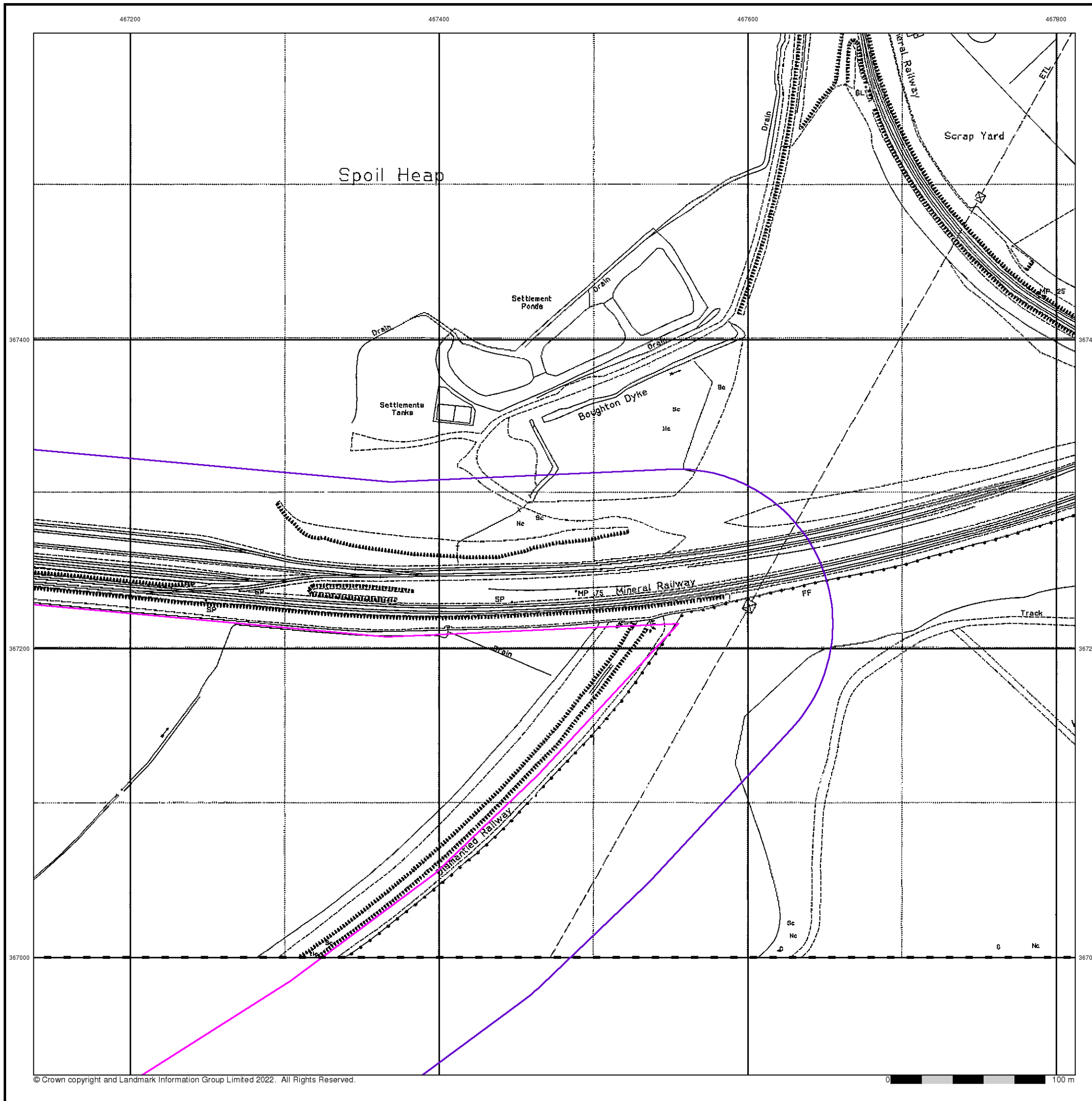

Large-Scale National Grid Data

Published 1996

Source map scale - 1:2,500

'Large Scale National Grid Data' superseded SIM cards (Ordnance Survey's 'Survey of Information on Microfilm') in 1992, and continued to be produced until 1999. These maps were the fore-runners of digital mapping and so provide detailed information on houses and roads, but tend to show less topographic features such as vegetation. These maps were produced at both 1:2,500 and 1:1,250 scales.

Map Name(s) and Date(s)

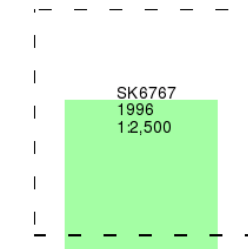

Historical Map - Segment A11

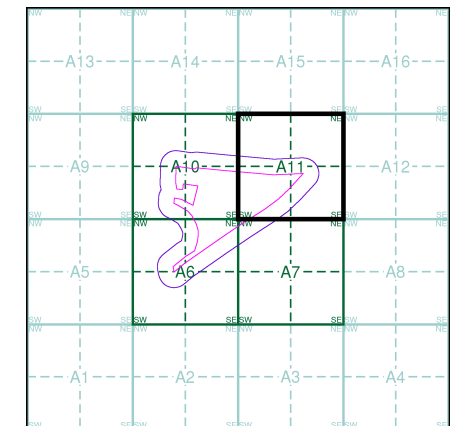

Order Details

Order Number: 303045175_1_1
 Customer Ref: DS70791
 National Grid Reference: 467040, 367010
 Slice: A
 Site Area (Ha): 23.
 Search Buffer (m): 100

Site Details

Site located at 335200,671890

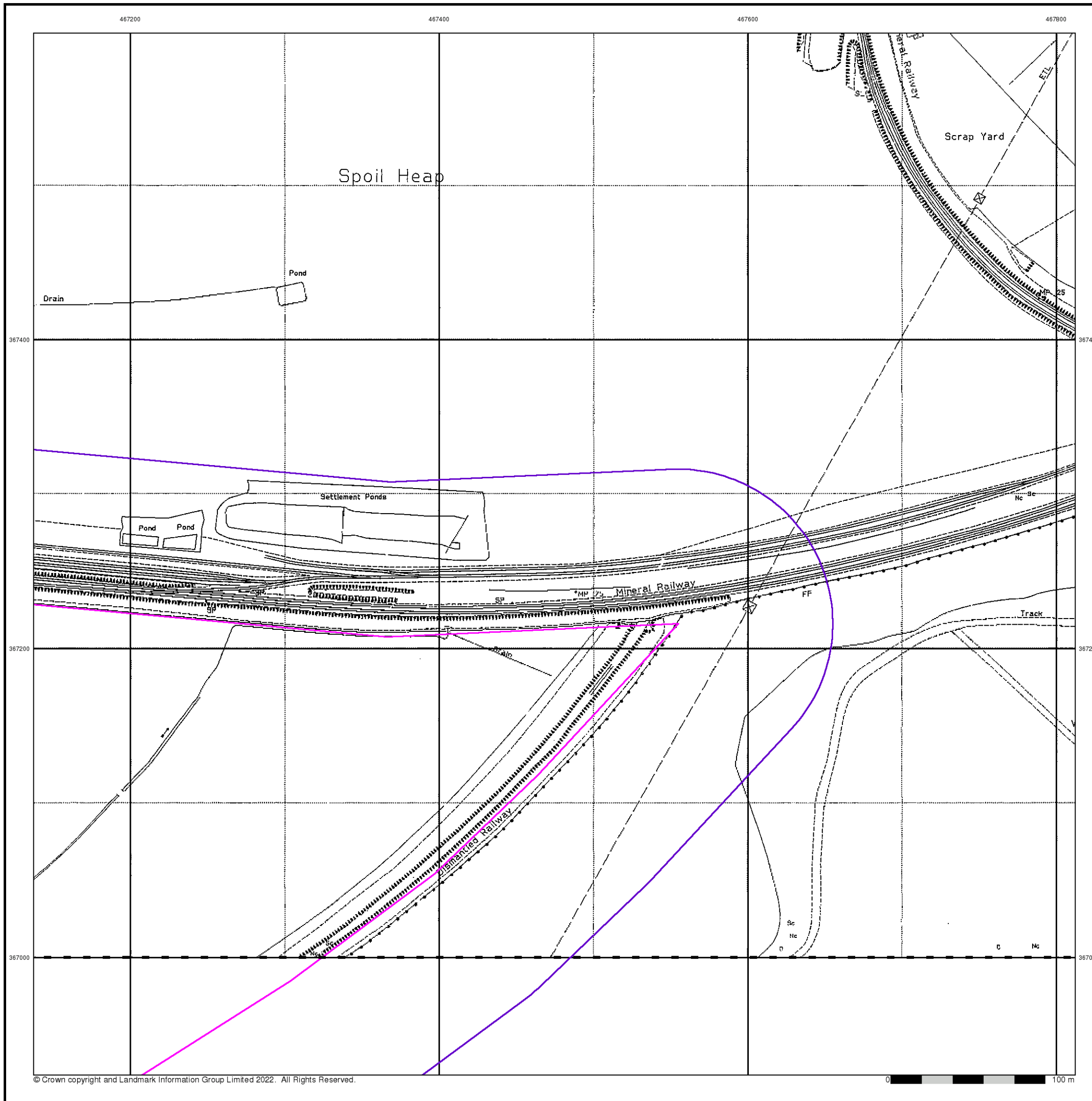

467200

467400

467600

467800



Historical Aerial Photography

Published 1999

This aerial photography was produced by Getmapping, these vertical aerial photographs provide a seamless, full colour survey of the whole of Great Britain



Historical Aerial Photography - Segment A11

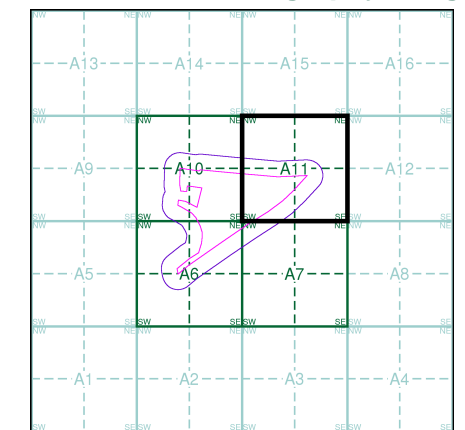

Order Details

Order Number: 303045175_1_1
 Customer Ref: DS70791
 National Grid Reference: 467040, 367010
 Slice: A
 Site Area (Ha): 23.
 Search Buffer (m): 100

Site Details

Site located at 335200,671890



Tel: 0844 844 9952
 Fax: 0844 844 9951
 Web: www.envirocheck.co.uk