

Rev	Date	Description

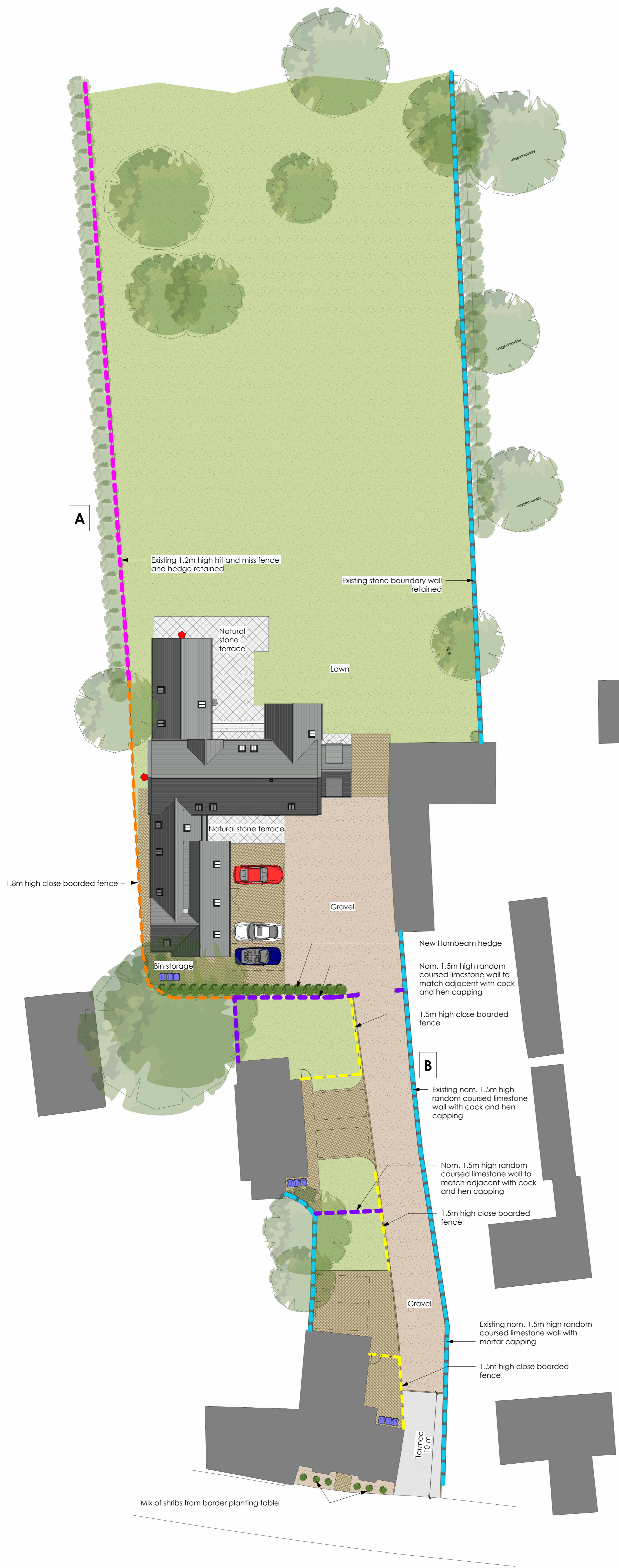

A Existing 1.2m high hit and miss fence and hedge retained



B Existing random coursed limestone wall with cock and hen capping

NEW BORDER/HEDGE PLANTING
 New borders to be planted with species as indicated. Area of border planting to be cleared of all perennial weeds before new planting. Borders to be dug to a depth of 600mm and made up with good quality topsoil with a silty loam. Soil pH to be checked and any changes to plant choice made accordingly. Plants to be positioned on site still in pots initially to confirm siting taking account of size and shape of individual plants. Planting holes to be dug for each plant approximately twice the size and depth of the root ball. Base of holes to be broken up and mixed with a suitable compost. A root builder to be added in accordance with manufacturers recommendations. On removal from the pot each plants roots are to be teased out and root ball to be placed into planting hole with top of root ball level with top of border soil. Area around the root ball to be filled with border soil. Plants to be gently firmed in by foot and well watered. Newly planted borders to be mulched with decorative gravel.

MAINTENANCE
 5 year landscaping maintenance plan to allow for the protection and establishment of new plants. Any dead, diseased or damaged plants to be replaced with similar size and species. Tree shelters to be checked monthly and repaired/replaced as required.

As an alternative to pre-planting weed control a residual herbicide may be applied after planting around trees planted into a grass sward which should give 6 months of weed free growth. Control of weed growth and competition for nutrients and moisture is essential around each newly planted tree for 2-3 seasons after planting. A one metre weed free area around each tree is recommended.

LAWNS
 Areas to be seeded to be roughly graded and topsoiled to a depth 450mm for grass. All topsoil areas to be grassed to be cleared of weeds and rubbish and rotovated to 100 deep. No ploughing, ripping etc to be carried out within spread of existing trees. Pre-germination fertiliser to be spread and wild meadow mix seeding to be carried out in accordance with best practice. Alternatively, if turf used, area to be roughly graded and topsoiled to a depth of 200mm. Apply a general fertiliser to manufacturers instructions and mix into top 50mm of soil. Turf to be laid in accordance with Best Practice and to be well watered in immediately. Watering to be continued as required for 3 weeks min to ensure turf does not dry out. Mowing to commence once roots have anchored turf to soil-nominally 3wks and height of grass to be reduced over successive cuts so that the grass is not 'shocked'

- PLANTING**
- Indicates existing tree retained
 - Indicates new planting, refer to notes

- ECOLOGY**
- Bat Box (2 No.)

- HARD LANDSCAPING**
- Permeable block paving
 - Tarmacadam - Roads & Pathways
 - Natural stone pavers
 - Concrete Kerb Edgings
 - Gravel

- BOUNDARY TREATMENT**
- Existing hit and miss fence retained, nom 1.2m high
 - Existing stone walls retained, nom 1.5m high
 - New stone wall, nom 1.5m high
 - 1800mm high close boarded fence
 - 1500mm high close boarded fence



paulbancroft architects
 The Coach House | 80 South Road | Oundle | Peterborough | PE8 4BP
 www.paulbancroftarchitects.com

PLANNING

Job Title
NEW DWELLING REAR 31 MAIN STREET WOODNEWTON

Drawing Title
PROPOSED LANDSCAPING AND BOUNDARY TREATMENTS

Scale @ A1	Date	Drwg. No.	Revision
As indicated	OCT 23	1386 - 10	

This drawing shall NOT be scaled other than for planning purposes. All dimensions to be verified on site. All working dimensions to be taken from site. All copyright reserved.

RIBA Chartered Practice

PROPOSED LANDSCAPING & BOUNDARY TREATMENTS

1 : 200
 0 2 4 6 8 10 20m

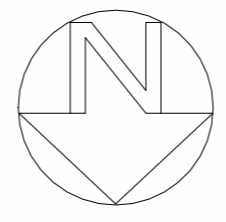

SHRUBS FOR BORDER PLANTING

REF	SPECIES	HEIGHT	POT	DENSITY
AA	Hebe rakaiensis	20-30cm	3l	2/m ²
BB	Lavandula angustifolia 'Hidcote'	10-20cm	2l	2/m ²
CC	Potentilla fruticosa 'Red Ace'	10-20cm	2l	2/m ²
DD	Vinca minor 'Gertrude Jekyll'	20-30cm	2l	2/m ²