

PROPOSED GROUND FLOOR LAYOUT  
SCALE 1:50

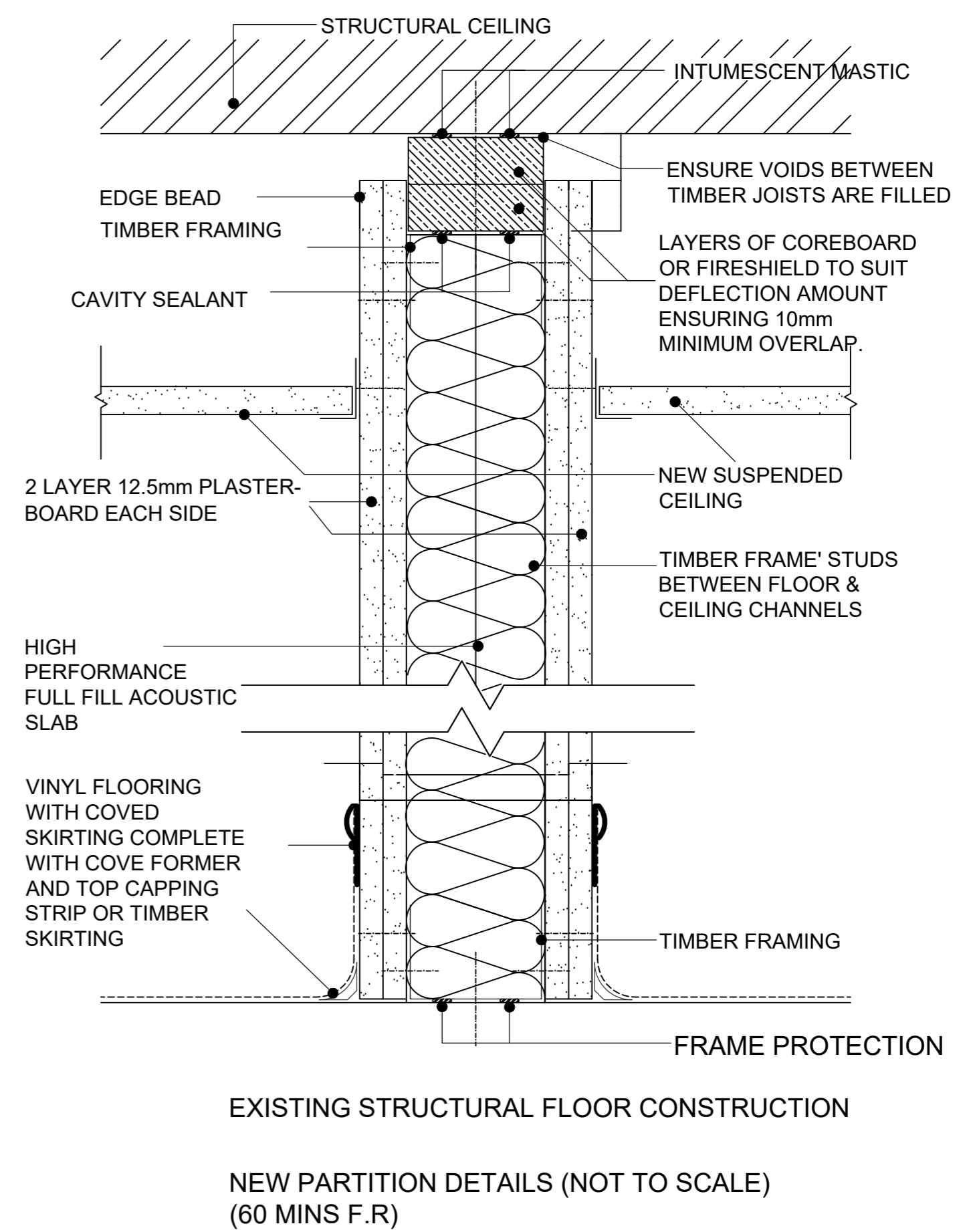
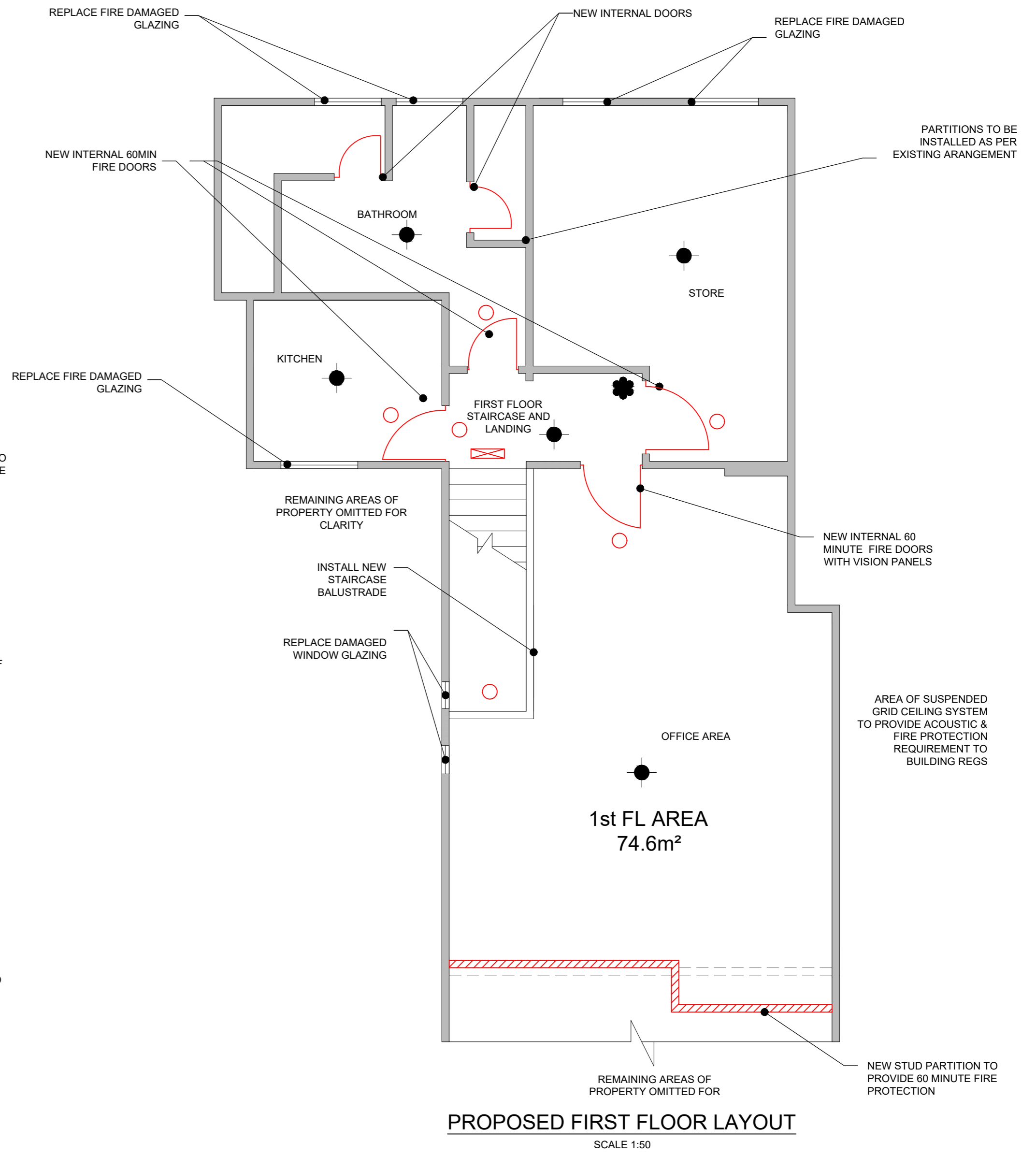

FIRE SYSTEMS	
	SOUNDER/STROBE
	SMOKE & HEAT DETECTOR
	CALL POINT
	FIRE ALARM PANEL
EMERGENCY LIGHTING	
	EMERGENCY BULKHEAD - CIRCULAR
	EMERGENCY BULKHEAD - RECTANGULAR / FINAL EXIT DIRECTION
	EMERGENCY PANEL - 600x600mm

REMOVE EXISTING SUSPENDED CEILING THROUGHOUT GROUND AND FIRST FLOOR LEVEL. PROVIDE NEW ACOUSTIC CEILING WITH 60MIN FIRE PROTECTION.

NOTES:

- THESE NOTES ARE INTENDED TO AUGMENT DRAWINGS AND SPECIFICATIONS. WHERE CONFLICT OF REQUIREMENTS EXIST THE ORDER OF PRECEDENCE SHALL BE AS SHOWN IN THE SPECIFICATION. OTHERWISE THE STRICTEST PROVISION SHALL GOVERN.
- THIS DRAWING IS TO BE READ IN CONJUNCTION WITH ALL OTHER RELEVANT ENGINEERS AND ARCHITECTS DRAWINGS.
- DRAWINGS NOT TO BE SCALED. ALL DIMENSIONS TO BE CHECKED ON SITE BY THE CONTRACTOR. ANY DISCREPANCIES TO BE NOTIFIED TO THE ENGINEER AND FURTHER INSTRUCTIONS OBTAINED BEFORE WORK IS COMMENCED.
- THE STRUCTURE IS DESIGNED TO BE SELF-SUPPORTING AND STABLE AFTER THE BUILDING IS FULLY COMPLETED. IT IS THE CONTRACTOR'S SOLE RESPONSIBILITY TO DETERMINE THE ERECTION PROCEDURE AND SEQUENCE AND ENSURE THAT THE BUILDING AND ITS COMPONENTS ARE SAFE DURING ERECTION. THIS INCLUDES THE ADDITION OF WHATEVER TEMPORARY BRACING, GUYS OR TIE-DOWNS WHICH MAY BE NECESSARY. SUCH MATERIAL REMAINING THE PROPERTY OF THE CONTRACTOR ON COMPLETION. AND FOR ENSURING THAT THE WORKS AND ANY ADJACENT PROPERTIES ARE SAFE IN THE TEMPORARY CONDITION.

Rev	Description	Date	By	Chk	App
P11	ISSUED FOR LISTED BUILDING CONSENT	24.01.24	PJW	RNT	
P10	LAYOUT AMENDMENTS	xxix	RNT	RNT	
P9	FIRE ALARM AMENDMENTS	24.07.23	RNT	RNT	
P8	LAYOUT & ANNOTATION AMENDMENTS	20.07.23	RNT	RNT	
P7	AMENDMENTS & ADDITIONS TO PROPOSED FIRE DOORS & STUD WALLS.	--	MBL	PS	
P6	LAYOUT AMENDED FOLLOWING LATEST MEASUREMENT SURVEY. FURTHER NOTATION ADDED	06.06.23	MBL	PA	
P5	EMERGENCY LIGHTING LAYOUT ADDED	06.02.23	MBL	PA	
P4	FIRE ALARM SCHEME ADDED	10.01.23	MBL	PS	
P3	DETAIL ADDED, ACCESS TO GROUND FLOOR STAIRS ALTERED.	09.01.23	MBL	PA	
P2	SCHEME OF NEW DOORS/DOOR REPAIRS NOTED.	03.01.23	MBL	PA	
P1	FIRST ISSUE	11.11.22	MBL	PA	--

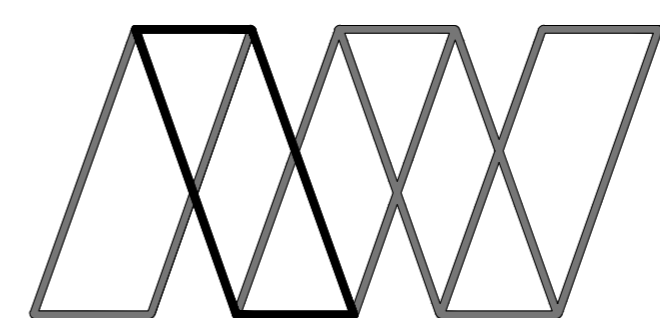

Alan Wood & Partners

Scarborough Office  
Kingsley House  
7 Pickering Road  
West Ayton  
Scarborough  
YO13 9JE

T. 01723 865484  
www.alanwood.co.uk

Consulting Civil & Structural Engineers  
Project Managers  
Building Surveyors

Hull T. 01482 442138  
Lincoln T. 01522 300210  
London T. 02071 860761  
Sheffield T. 01142 440077  
York T. 01904 611594

Project: FIRE DAMAGE REPAIR - 29 NEWBOROUGH, SCARBOROUGH, NORTH YORKSHIRE, YO11 1NA

Client: MR. J SENIOR

Drawing: PROPOSED GROUND & FIRST FLOOR PLANS

Role: S - STRUCTURAL ENGINEER

Drawing Status: PLANNING

Job no. 46984 Scale@A1: As Noted Rev P11

Project Originator Volume Level Type Role Number  
NBRG - AWP - ZZ - XX - DR - S - 7010