

The Copyright of this drawing/design is vested in Woodsyde Development Ltd and must not be copied or reproduced in part or whole without prior written consent

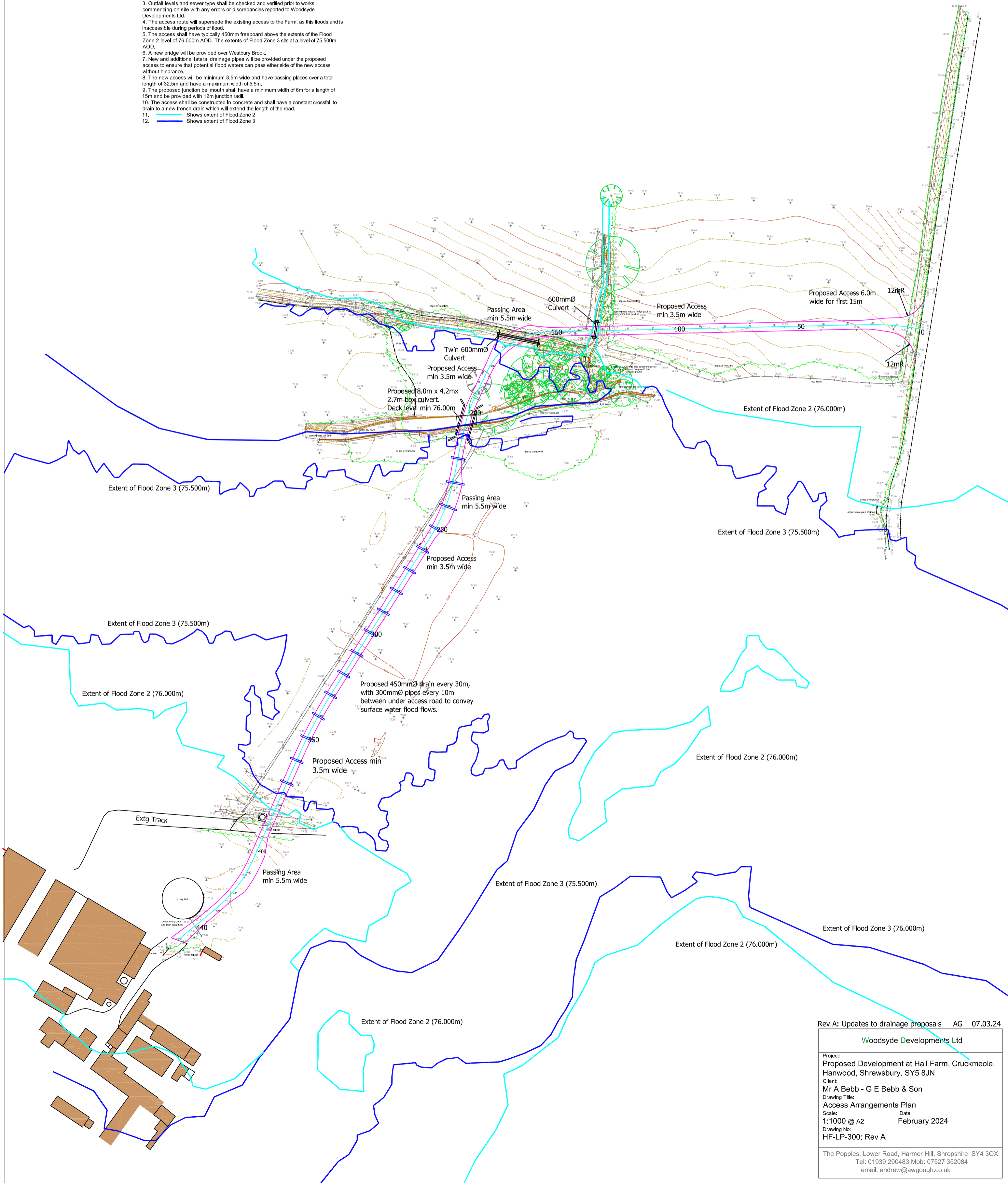

Notes:

1. The Contractor shall check all heights, sizes, dimensions, pipe diameters and drainage outfalls on site or off site before works commence and any errors should be reported to Woodsyde Developments Limited.
2. Figured dimensions shall take preference to scaling, with any errors reported to Woodsyde Developments Ltd.
3. Outfall levels and sewer type shall be checked and verified prior to works commencing on site with any errors or discrepancies reported to Woodsyde Developments Ltd.
4. The access route will supersede the existing access to the Farm, as this floods and is inaccessible during periods of flood.
5. The access shall have typically 450mm freeboard above the extents of the Flood Zone 2 level of 76.000m AOD. The extents of Flood Zone 3 sits at a level of 75.500m AOD.
6. A new bridge will be provided over Westbury Brook.
7. New and additional lateral drainage pipes will be provided under the proposed access to ensure that potential flood waters can pass either side of the new access without hindrance.
8. The new access will be minimum 3.5m wide and have passing places over a total length of 32.5m and have a maximum width of 5.5m.
9. The proposed junction bellmouth shall have a minimum width of 6m for a length of 15m and be provided with 12m junction radii.
10. The access shall be constructed in concrete and shall have a constant crosstall to drain to a new french drain which will extend the length of the road.
11. — Shows extent of Flood Zone 2
12. — Shows extent of Flood Zone 3



Rev A: Updates to drainage proposals AG 07.03.24	
Woodsyde Developments Ltd	
Project:	Proposed Development at Hall Farm, Cruckmeole, Hanwood, Shrewsbury. SY5 8JN
Client:	Mr A Bebb - G E Bebb & Son
Drawing Title:	Access Arrangements Plan
Scale:	1:1000 @ A2
Date:	February 2024
Drawing No:	HF-LP-300: Rev A
The Popples, Lower Road, Harmer Hill, Shropshire, SY4 3QX. Tel: 01939 290483 Mob: 07527 352084 email: andrew@awgough.co.uk	