

WC SEA CONTAINER: PLAN

STORE SEA CONTAINER: PLAN

02- WC & STORE SEA CONTAINERS 1:50

DESIGN INTENT

The existing Old Pavilion was partially demolished when the New Pavilion was built. The existing roof slab is failing, with water ingress into the structure. As a result it is beyond economic repair.

The proposal is to demolish the existing structure to make way for a new Events Marquee.

A new security fence is to be installed along the west and north boundary. Fence is to match the fence around the existing outdoor training nets.

PLAN KEY

- ① EVENTS MARQUEE (15M X 9M - 135 SQ M)
- ② WC BLOCK
- ③ STORAGE CONTAINER
- ④ EVENTS BAR
- ⑤ GRASS PATIO VIEWING AREA
- ⑥ SECURITY FENCE

NB: Shaded areas of plan comprise concrete paving slabs to match existing.

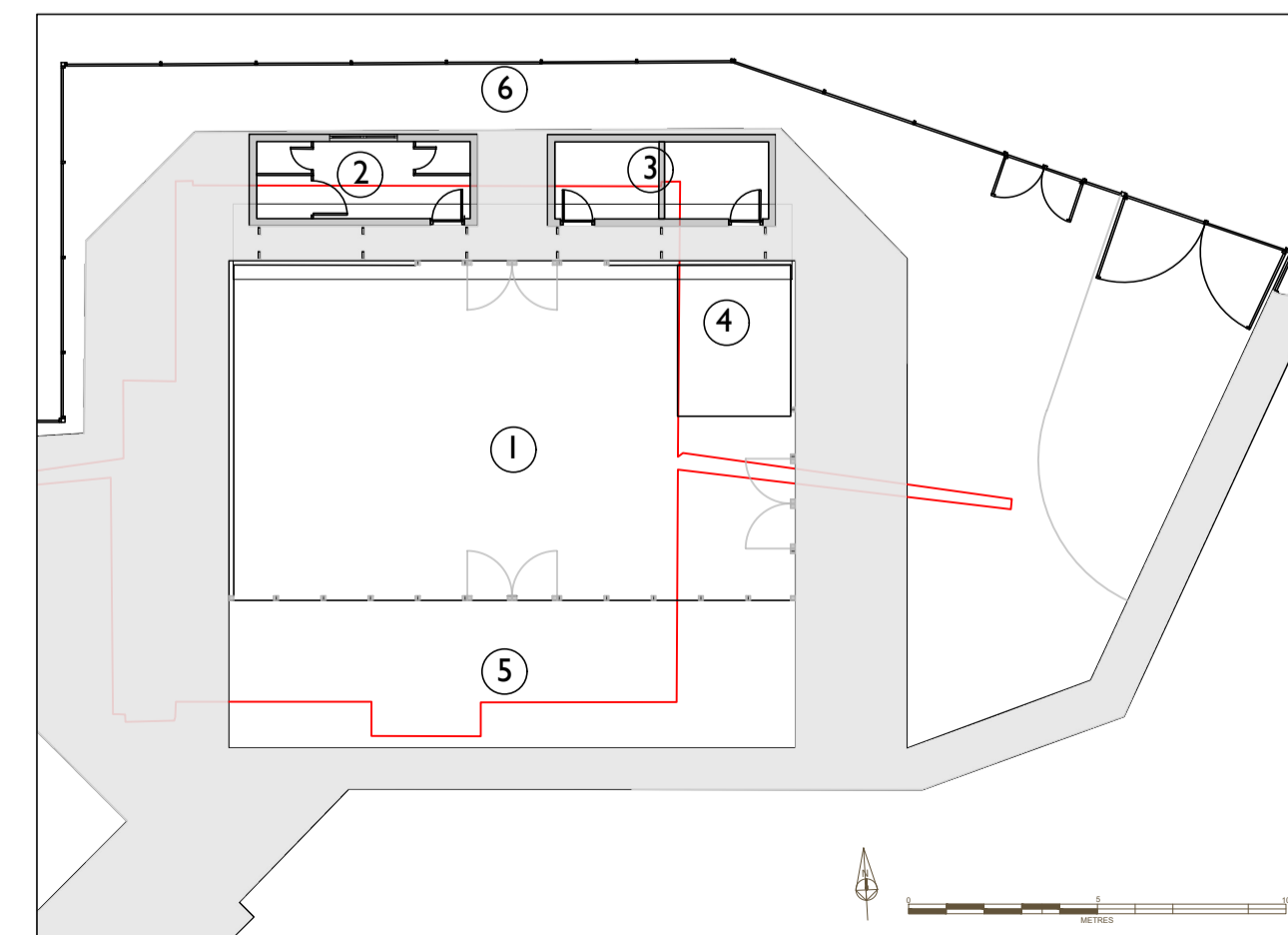

01- EVENTS MARQUEE GR FLOOR 1:200

notes:

1. This drawing is the copyright of the Architects and may not be reproduced without licence.
2. The Contractor shall not scale off this drawing for construction purposes, only figured dimensions shall be worked from.
3. All dimensions and levels are to be checked on site by the Contractor before the commencement of any work and any discrepancies reported to the Architect.
4. No responsibility can be accepted for errors arising on site due to unauthorized variations from the Architects drawings.
5. The Contractor is recommended to visit the site before tendering to ascertain all local conditions and restrictions likely to affect the works. No claims arising from failure to do so will be considered.
6. Tenders must include for all the works described or being apparent on the drawings or can reasonably be inferred as being necessary for the proper execution of the works.
7. This drawing is for town planning and building regulations only and is not a complete working drawing.
8. Depth, size and design of foundations shown are preliminary only, actual foundation, depth, size and design may differ depending on site conditions.
9. On completion of the works, if a National Home Energy Rating Certificate is required by the client, contact the Local Authority Building Control Department.
10. L1 and L2 requirements for limiting thermal bridging & air leakage workmanship shall be executed by the Contractor in accordance with the appropriate sections and DEFRA/DTLR guidance document "Limiting Thermal Bridging & Air Leakage : Robust Construction Details for Dwellings and Similar Buildings" available from The Stationery Office Ltd.

revisions

Number	Date	Title	By
00	14/03/2024	Additional Info Requested re: Containers	KB

LOG:architecture, 27 Richmond Street, Penzance TR18 2PP
(e-mail: kelt@bell.ms) (mobile: 07733227146)

Client: PENZANCE CRICKET CLUB
PENZANCE TR18 2SU

Project: DEMOLITION OF OLD STAND
APARTMENT & STORE
NEW MARQUEE AND FENCE

Title: PROPOSED
WC AND STORE CONTAINERS
PLANS & ELEVATIONS

Scale/s: 1 : 200 / 50 @A1

Date: MAR 2024

Drawn: KB Checked: KB

Project No. Drawing No. Rev.

LA-179 LA-179-013 01