

**NOTES:**

DO NOT SCALE THIS DRAWING. WORK ONLY TO FIGURED DIMENSIONS.

FOR ALL RELEVANT NOTES, REFER TO STRUCTURAL AND CIVIL ENGINEERING PERFORMANCE SPECIFICATION ANY DISCREPANCIES ARE TO BE REPORTED TO SUBTENO ENGINEERING CONSULTANTS IMMEDIATELY.

THIS DRAWING IS TO BE READ IN CONJUNCTION WITH ALL OTHER RELEVANT ENGINEERS, ARCHITECTS AND SUB-CONTRACTORS DRAWINGS AND DETAILS.



HATCHED AREA INDICATES EXTENT OF EXISTING SCREED AND PAMMENTS TO BE REMOVED AND REINSTATE NEW 150MM THICK SLAB REINFORCED WITH 1 LAYER A252 MESH IN TOP (30MM COVER)

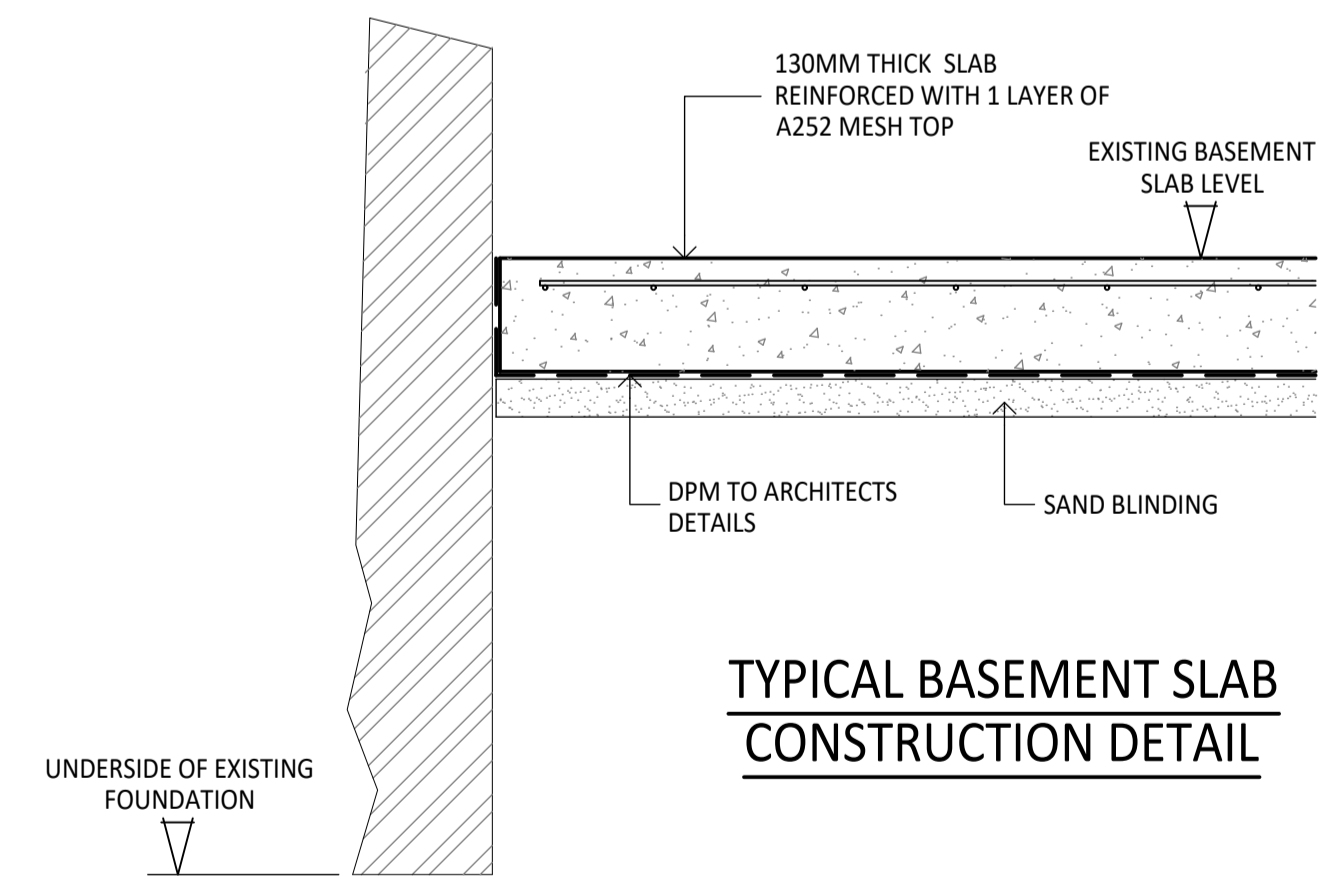

**TYPICAL BASEMENT SLAB CONSTRUCTION DETAIL**

P02	SLAB LAYOUT UPDATED	AJD	ZX	15.12.23
P01	PRELIMINARY ISSUE	AJD	-	08.12.23
REV	DESCRIPTION	BY	CKD	DATE

<b>INFORMATION</b>				
CLIENT				
<b>WILLIAMS SOUTHERN LIMITED CONSTRUCTION</b>				
PROJECT				
SAINSBURYS LOCAL HOVE, BN3 2EB				
DRAWING TITLE				
BASEMENT LAYOUT				

DRG No. S230725-SUB-XX-XX-DR-S-00100-S2- P02

SCALE @ A1	DRAWN	CHECKED	DATE
1:50	A J DYE	ZX	DEC 23

CRAFTON HOUSE, ROSEBERRY BUSINESS PARK MENTMORE WAY, PORINGLAND, NORWICH NR14 7XP  
EMAIL SOLUTIONS@SUBTENO.CO.UK

