

The following risks are identified as unusual or unfamiliar to a competent contractor

CONSTRUCTION RISKS
There are no significant or unfamiliar risks

DEMOLITION RISKS (FUTURE)
There are no significant or unfamiliar risks

It is assumed that all work will be carried out by a competent contractor working, where appropriate, to an approved method statement

Notes:

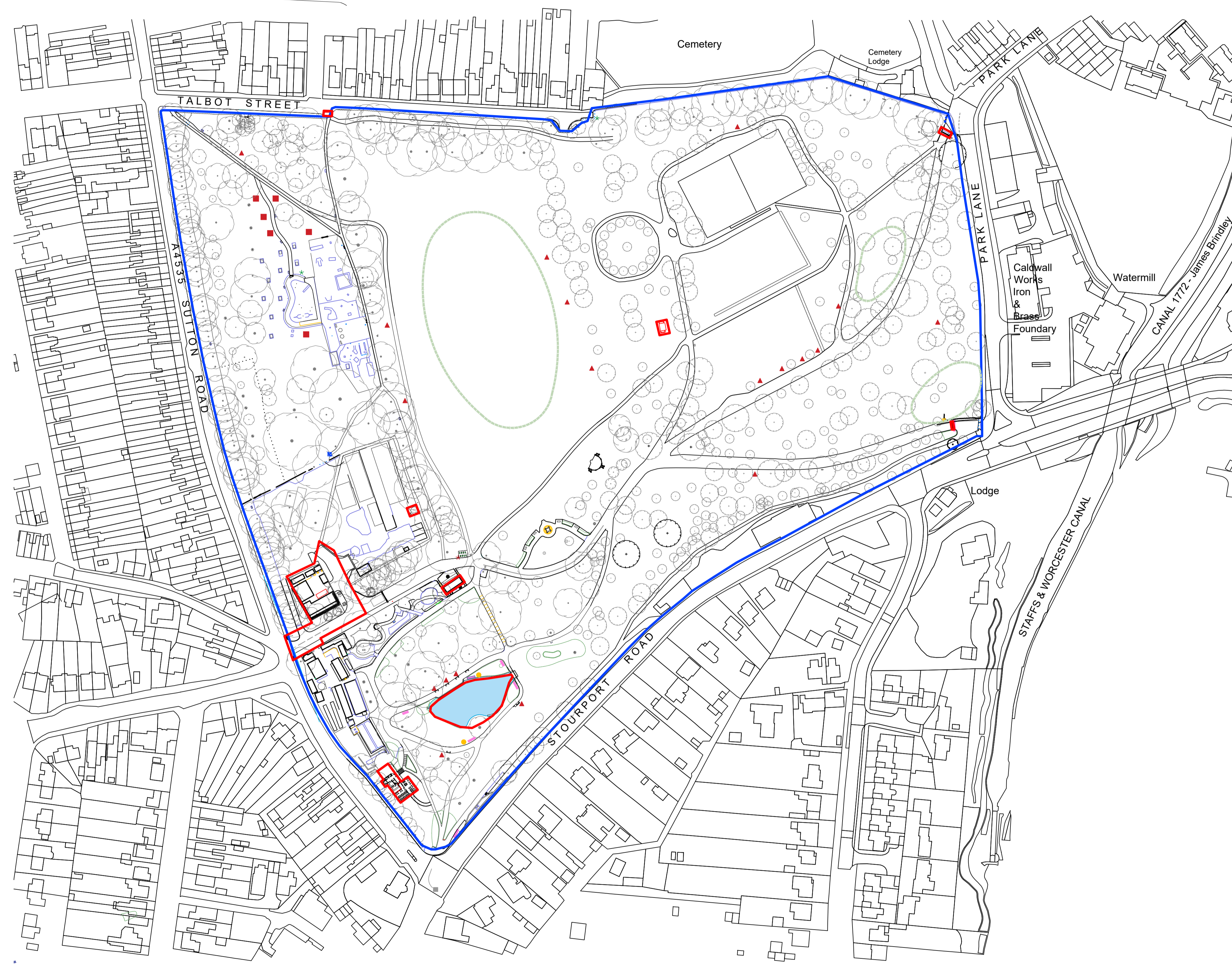
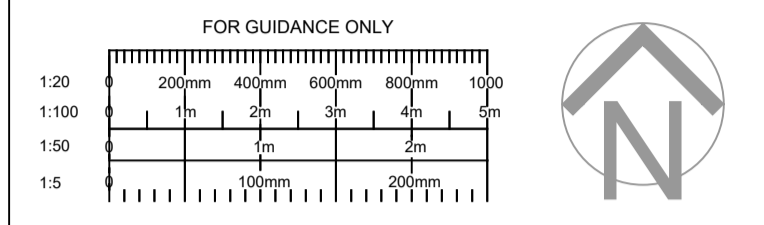

KEY

- ▲ Park Bench (x18)
- Picnic Benches (x4 new, x2 relocated)
- ★ Litter Bins (x1)
- ★ Recycling Bins (x1 new, x 1 relocated)
- 🐦 Bird Sculpture (x1)
- Signage posts (x5)
- ||| Cycle hoops (x8)
- Bollards (x2)
- Life Buoy (x2)

A	PLANNING ISSUE	Jan '24	AM
REV	DETAILS	DATE	CHECKED



Brinton Park, Kidderminster		DRAWING NO	
Proposed Park Furniture Plan		3482 - 085	
Wyre Forest District Council	PLANNING	REV	DATE
		A	Jan '24

PLANNING	DRAWN	CHECKED	SCALE
	JK	AM	1:1250 @ A1