



BED 12 - POOL NORTH

- DA 18 DRYOPTERIS AFFINIS
2L POT @3/m2
- DE 54 DRYOPTERIS ERYTHROSORA
2L POT @3/m2
- E Ar 72 EUPHORBIA AMYGDALOIDES VAR. ROBBIAE
2L POT @4/m2
- HH Gr 55 HEDERA HELIX 'GREEN RIPPLE'
2L POT @4/m2
- H MA 83 HAKONECHLOA MACRA 'AUREOLA'
2L POT @4/m2
- H Rs 33 HOSTA 'ROYAL STANDARD'
2L POT @3/m2
- Pse 21 POLYSTICHUM SETIFERUM
2L POT @3/m2
- Sb S 38 STACHYS BYZANTINA 'SILVER CARPET'
2L POT @4/m2

POOL

- CP 42.02 40 COIR PALLETS - Pre-established. 80Lm total
2.0 X 1.0m
- AD 30 APONOGETON DISTACHYOS
- NSP 30 NYMPHAEA 'SNOW PRINCESS'
- RA 40 RANUNCULUS AQUATILIS
- SA 20 STRATIOTES ALOIDES
- BU 30 BOTOMUS UMBRELLATUS
- CP 30 CALTHA PALUSTRIS
- IVP 50 IRIS VERSICOLOUR PURPLE
- MSM 50 MYOSOTIS SCORPIOIDES 'MERMAID'
- OAR 30 ORONTIUM AQUATICUM RED STEM
- PA 30 PERSICARIA AMPHIBIA
- RFM 50 RANUNCULUS FLAMMULA SUBSP. MINIMUS
- SS 30 SAGITTARIA SAGITTIFOLIA

BED 11

BED 11 - POOL WEST

- A aA 11 AGAPANTHUS AFRICANUS 'ALBUS'
3L POT @4/m2
- As 48 ASPLENIDIUM SCOLOPENDRIUM
2L POT @4/m2
- BC 50 BERGENIA CORDIFOLIA
2L POT @4/m2
- BS 21 BLECHNUM SPICANT
2L POT @4/m2
- CT 400 CROCUS TOMMASINIANUS
SIZE 5 @40/m2
- DA 31 DRYOPTERIS AFFINIS
2L POT @3/m2
- GM 27 GERANIUM MACRORRHIZUM
2L POT @4/m2
- GN 140 GALANTHUS NIVALIS
SIZE 4/5 @40/m2
- HA 25 HEBE ALICANS
2L POT @4/m2
- HH Gr 23 HEDERA HELIX
2L POT @4/m2
- HP 24 HOSTA 'PATRIOT'
2L POT @4/m2
- P Df 17 PERSICARIA 'DIKKE FLOSKE'
2L POT @4/m2
- SB 11 SANGUISORBA 'BLACKTHORN'
2L POT @4/m2
- SM 39 SEDUM MATRONA
2L POT @4/m2
- ST 32 STIPA TENUISSIMA
2L POT @3/m2

BED 12

BED 13

BED 13 - POOL EAST

- AM 23 ASTRANTIA MAJOR
2L POT @4/m2
- DE 23 DRYOPTERIS ERYTHROSORA
2L POT @3/m2
- E Ar 33 EUPHORBIA AMYGDALOIDES VAR. ROBBIAE
2L POT @4/m2
- GN 40 GALANTHUS NIVALIS
SIZE 4/5 @40/m2
- Gc K 21 GERANIUM CLARKEI 'KASHMIR WHITE'
2L POT @4/m2
- H MA 15 HAKONECHLOA MACRA 'AUREOLA'
2L POT @4/m2
- NP 360 NARCISSUS PSEUDONARCISSUS
SIZE 6up @12/m2
- P Df 32 PERSICARIA 'DIKKE FLOSKE'
2L POT @4/m2
- RF 19 RUDBECKIA FULGIDA VAR. SULLIVANTII 'GOLDSTRUM'
2L POT @4/m2
- SS I 8 SEDUM SPECTABILE 'ICEBERG'
2L POT @4/m2
- ST 15 STIPA TENUISSIMA
2L POT @3/m2
- V Ma 30 VINCA MAJOR 'VARIEGATA'
1L POT @8/m2

DRAWING NOTES:

GENERAL:

- COPYRIGHT OF THIS DRAWING IS VESTED IN PLINCKE AND IT MUST NOT BE COPIED OR REPRODUCED WITHOUT CONSENT.
- DO NOT SCALE FROM THIS DRAWING - DIMENSIONS GOVERN. IF IN DOUBT ASK!
- ALL DIMENSIONS ARE IN MILLIMETRES UNLESS NOTED OTHERWISE. ONLY FIGURED DIMENSIONS ARE TO BE TAKEN FROM THIS DRAWING.
- ALL DIMENSIONS SHALL BE VERIFIED ON SITE BEFORE PROCEEDING WITH THE WORK. ALL CONTRACTORS MUST VISIT SITE AND BE RESPONSIBLE FOR TAKING AND CHECKING ALL DIMENSIONS RELATIVE TO THEIR WORK.
- PLINCKE SHALL BE NOTIFIED IMMEDIATELY BY EMAIL, OF ANY DISCREPANCIES.
- PLINCKE ACCEPTS NO LIABILITY FOR ANY EXPENSE, LOSS OR DAMAGE OF WHATSOEVER NATURE AND HOWEVER ARISING FROM ANY VARIATION MADE TO THIS DRAWING OR IN THE EXECUTION OF THE WORK TO WHICH IT RELATES WHICH HAS NOT BEEN REFERRED TO THEM AND PRIOR APPROVAL OBTAINED.
- ALL PLINCKE DRAWINGS TO BE READ IN CONJUNCTION WITH ALL RELEVANT ARCHITECTURAL, CIVIL ENGINEERS AND M&E ENGINEERS DRAWINGS AND SPECIFICATIONS.

REFERENCE FILES:

THIS DRAWING IS BASED ON THE FOLLOWING EXTERNAL CONSULTANTS DRAWINGS:

CONSULTANT	REFERENCE FILE	DATE RECEIVED

HEALTH, SAFETY & ENVIRONMENTAL INFORMATION:

- IT IS ASSUMED THAT ALL WORKS ON THIS DRAWING WILL BE CARRIED OUT BY A COMPETENT CONTRACTOR AND, WHERE APPROPRIATE, WORKING TO AN APPROVED METHOD STATEMENT.
- THIS DRAWING IS TO BE READ IN CONJUNCTION WITH ALL OTHER HAZARDS / RISKS WHICH HAVE BEEN IDENTIFIED AND RECORDED WITHIN THE PRE-CONSTRUCTION INFORMATION PACK AND / OR THE CONSTRUCTION PHASE HSS PLAN.
- IN ADDITION TO THE HAZARDS / RISKS NORMALLY ASSOCIATED WITH THE TYPES OF WORK DETAILED ON THIS DRAWING, NOTE THE FOLLOWING:

ITEM N°	RISK REGISTER DETAILS

NOTES:

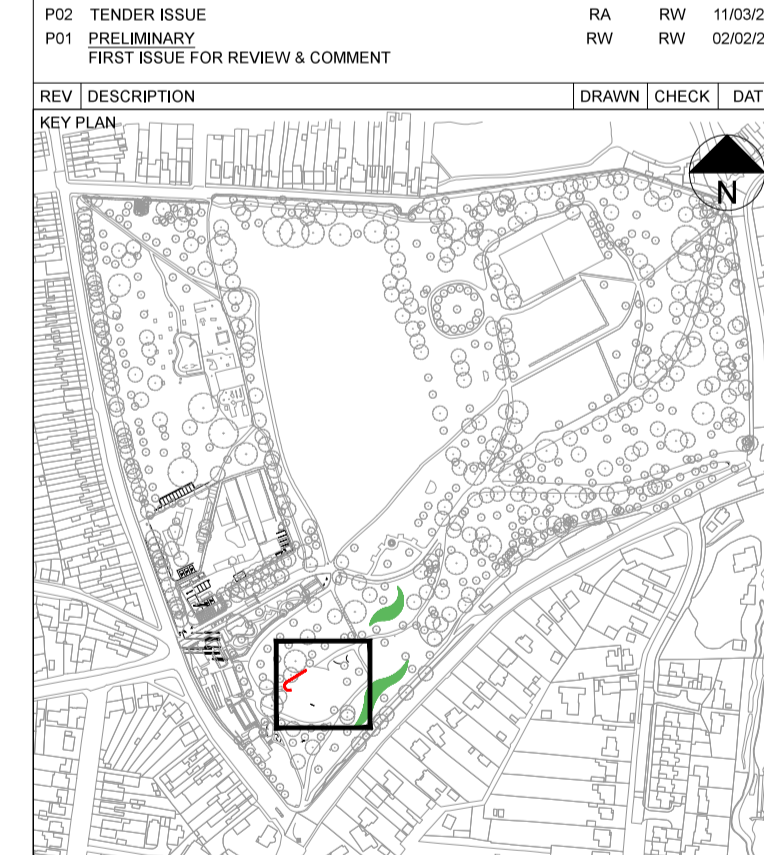

plincke.

MANCHESTER 0161 237 9223 north@plincke.com
RUGBY 0178 881 7886 midlands@plincke.com
LONDON 0207 739 3330 london@plincke.com

www.plincke.com

PROJECT TITLE BRINTON PARK RESTORATION & RENEWAL	STATUS
DRAWING TITLE PLANTING - SHEET 03	SCALE @ A1 1:100
PROJECT No. 0588	DATE 02/02/22
DRAWING No. PLI_C1_SW_DR_L_0313	REVISION P02

SCALE BAR @ 1:100