

This drawing has been produced for the Client, Project and Site as stated and is not intended for use by any other person or for any other purpose than that stated and dated and is the copyright © of ACD Projects Ltd 2021.

Only labelled dimensions and original issue drawings are to be relied upon for accuracy and content. All dimensions and datums given are subject to verification by the main contractor, via site survey, prior to commencing of works. Please report any errors/omissions to the Architect. This drawing is to be read in conjunction with all other project Architect / Engineers drawings and other relevant information. **If in doubt, ASK!**

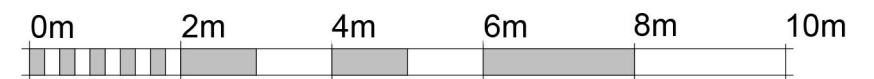
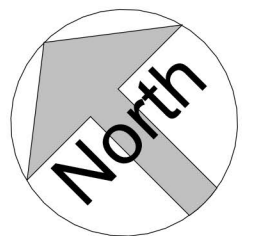
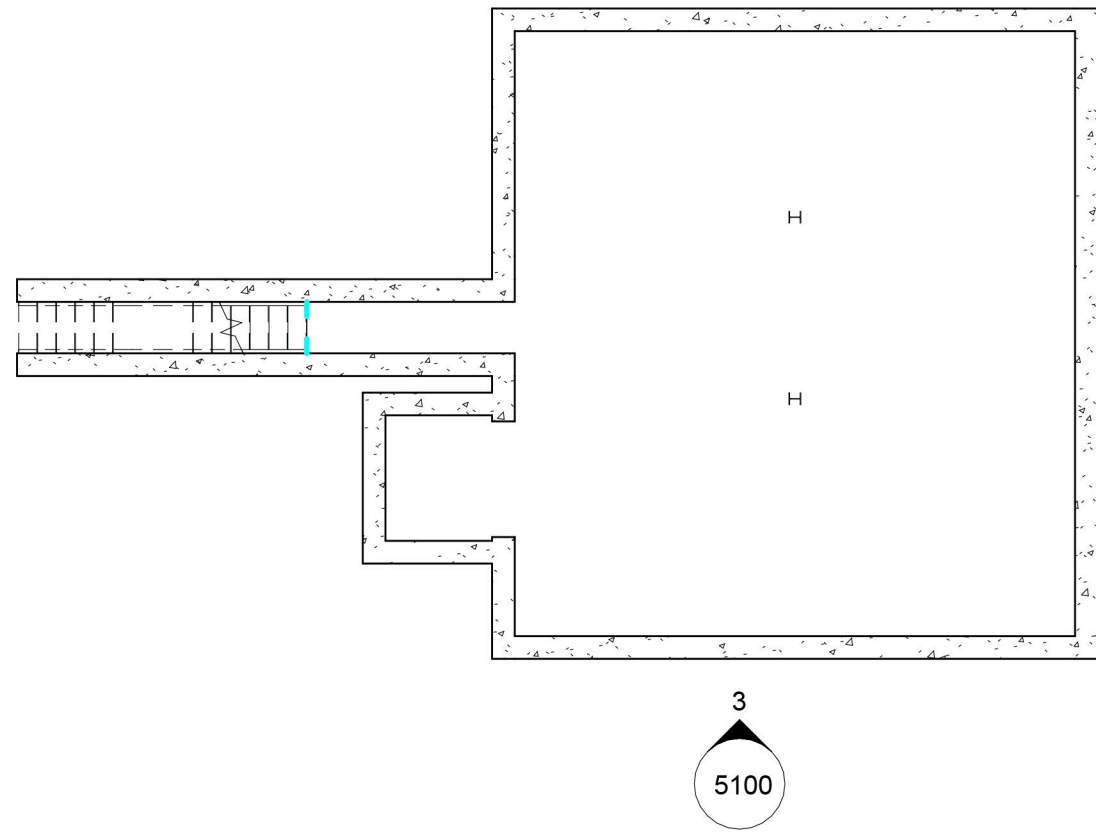

VISUAL SCALE 1:100 @ A3

rev	date	name	chk	note
P2	13/03/2024	JE	-	Updated following Landlord comments
P1	04/01/2024			Preliminary

A3

Original Sheet Size

STATUS

Feasibility

PROJECT

Project Rafiki

CLIENT

Linnaeus

DRAWING TITLE

Existing Basement Floor Plan

SCALE	DATE	DRAWN	CHK
1 : 100	27/02/2024	TH	AR

DRAWING NUMBER	REVISION
1441 / 0301	P2

1 0.0 Basement Floor - Existing
1 : 100



11 King Court
Willie Snaith Road
Newmarket, Suffolk
CB8 7SG, England

T. +44(0)1638 560343
W. www.acdprojects.com
E. enquiries@acdprojects.com

© COPYRIGHT