

EXISTING SITE/ROOF PLAN
1:500

A2

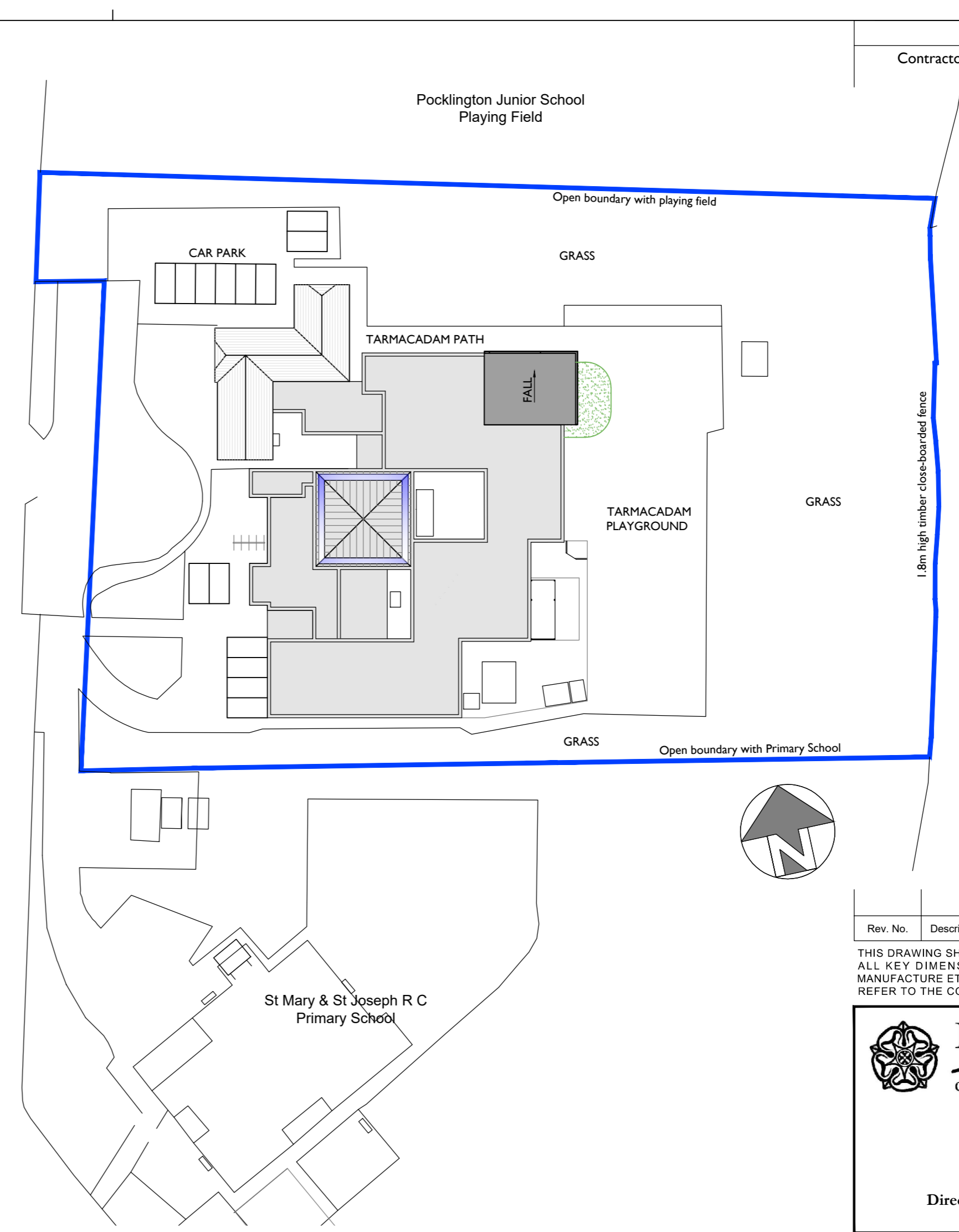

PROPOSED SITE/ROOF PLAN
1:500



NOTES

Contractor to check all dimensions prior to manufacture

Rev. No.	Description	Rev. By	Date

THIS DRAWING SHOULD NOT BE SCALED. USE FIGURED DIMENSIONS ONLY. ALL KEY DIMENSIONS ARE TO BE VERIFIED ON SITE PRIOR TO ANY MANUFACTURE ETC. IN THE CASE OF ANY DOUBT OR DISCREPANCY PLEASE REFER TO THE CONTRACT ADMINISTRATOR FOR FURTHER INSTRUCTIONS.

EAST RIDING
OF YORKSHIRE COUNCIL

East Riding of Yorkshire Council
County Hall, Beverley,
East Riding of Yorkshire HU17 9BA
Tel: 01482 395990 Fax: 01482 395063
www.eastriding.gov.uk

Director of Communities and Environment
PAUL BELLOTTI

Project:
**CLASSROOM EXTENSION
POCKLINGTON INFANTS, MAXWELL ROAD,
POCKLINGTON, YO42 2HE**

Drawing Title:
**EXISTING & PROPOSED
SITE & ROOF PLANS**

Drawing Reference			
Property Code:	Drawn:	Date:	Scale:
	MEM	05.03.2024	As Shown
Project No:	Drawing No:	Rev:	
54825	54825.05		
Drawing Status: PLANNING			