

Existing electric cupboard doors to be stripped and replaced.

Existing run of windows & glazing to be stripped out and infilled with brick & blockwork to match existing.

Existing means of escape to be stripped out and replaced with new external grade galvanised steel security door with powder coated finish.

Existing run of windows & glazing to be stripped out and infilled with brick & blockwork to match existing.

Existing means of escape to be stripped out and replaced with new external grade galvanised steel security door with powder coated finish.

Existing run of windows & glazing to be stripped out and infilled with brick & blockwork to match existing.

Contractor to board top of racking.

High level racking to be cleared to window level

High level racking to be cleared to window level

DRAWINGS TO BE READ IN CONJUNCTION WITH COGENT'S SPECIFICATION

SEE ALSO M&E & STRUCTURAL ENGINEERS DRAWINGS

CONTRACTOR TO CHECK SUITABILITY OF FITTINGS PRIOR TO PROCUREMENT.

STRUCTURAL ENGINEER TO ASSESS SITE PRIOR TO ANY DEMOLITION WORK TAKING PLACE.

KEY	
	STRIP OUT/ DEMOLITION
	STRIP OUT/ DEMOLITION

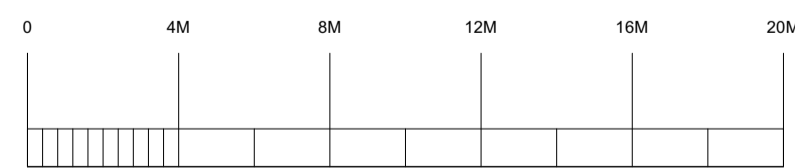
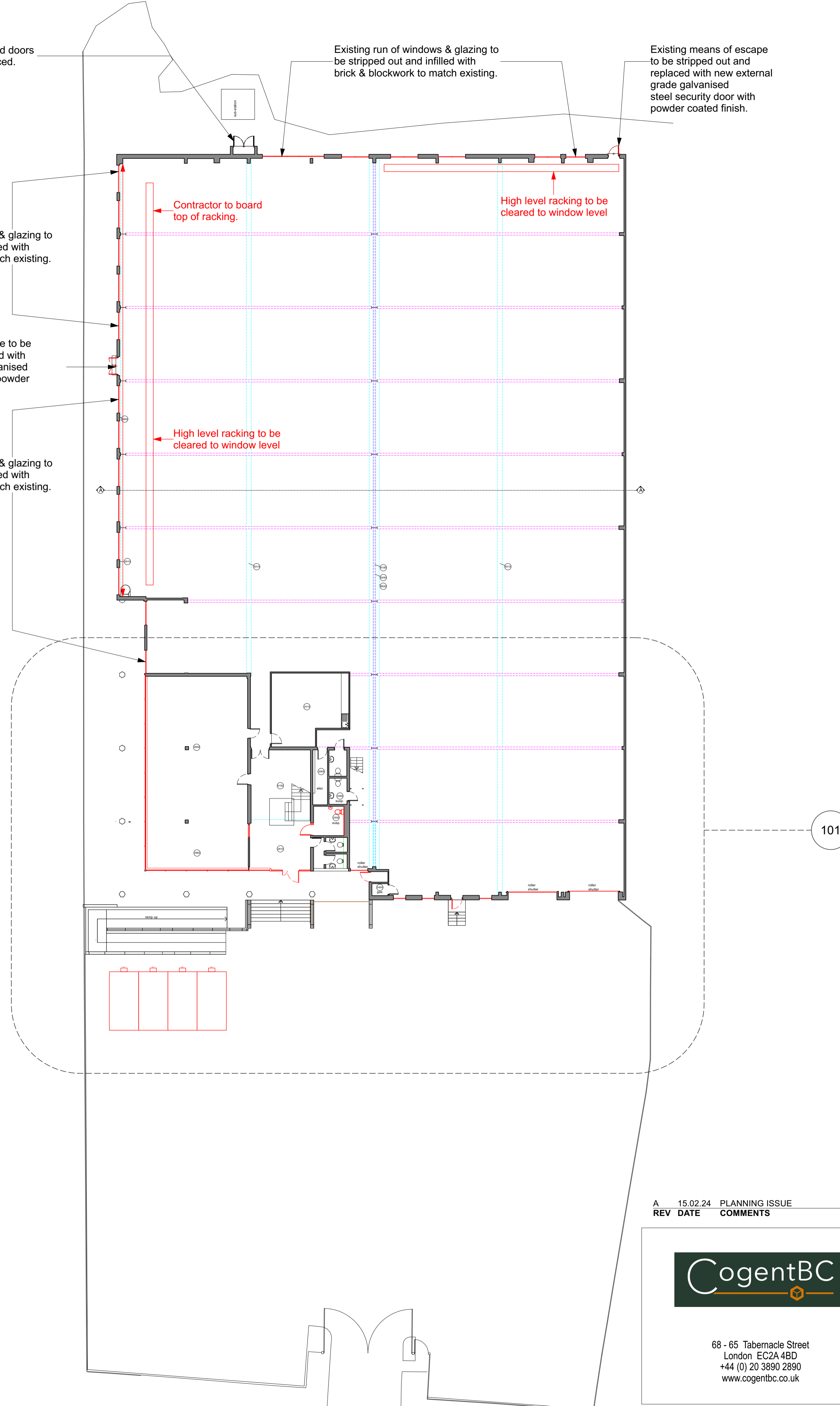

### SCALE BAR

This drawing is Copyright © of Cogent Building Consultancy LLP.

Do not scale this drawing.  
All dimensions to be checked on site.  
Drawing to be read in conjunction with any specifications, schedules and Consultants drawings and details.

REV	DATE	COMMENTS
A	15.02.24	PLANNING ISSUE



68 - 65 Tabernacle Street  
London EC2A 4BD  
+44 (0) 20 3890 2890  
www.cogentbc.co.uk

# PLANNING ISSUE

Project Name Unit 1-2, Willoughby Road, Bracknell, RG12 8FB	Scale 1:200 @A1 1:400 @ A3	Drawn MS	Checked LNB	Date 06.02.24
Client Duff Investment Holdings Limited acting as a general partner of Argo DFI Logistics Partnership LP				Status REV - A
Drawing Title Existing & Demolition Site Plan				Drawing No. 100