

MATERIALS
 A. RED BRICK (TME)
 C. SINGLE PLY ROOF

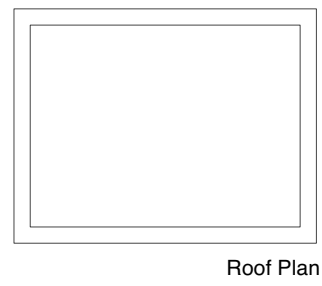
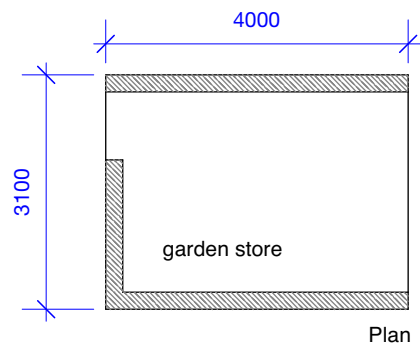

E14 Existing Garden Store

Miller Partnership Architects

101 OUSEBURN ROAD, NEWCASTLE UPON TYNE, NE6 5AF | Tel : +44 (0) 191 228 6243 | info@millerpartnershiparchitects.co.uk | www.millerpartnershiparchitects.co.uk

Drawing Number	Rev	Drawing Content	Scale	Date	Project
E14		Existing Garden Store	1: 100@A3	March 2024	101.235 2 Dene Crescent, Whitley Bay. NE26 3AL