

studio gb

43/45 PARK ROAD

DRAFT Landscape Statement

December 2023

1.0 Landscape Concept

1.2 Illustrative Landscape Plan

The development offers excellent opportunities for a large new family back garden that is separated into various activity zones, filled with trees, mixed shrubs, and perennials that enhance the setting of the listed building, and improve biodiversity.

The front garden will feature a horseshoe drive that follows the existing entrances to the property. To minimize the drive's impact on existing trees, we propose a porous gravel surface that maintains the existing ground level.

Additionally, we propose to replace the existing rotting wooden fence to a cast iron railing, more fitting for a property within the conservation area.

Key

- 01 Existing trees
- 02 Proposed multistem trees
- 03 Proposed fruit trees
- 04 Proposed single stem trees
- 05 Mixed groundcover planting
- 06 Enhanced existing shrubs, perennials and climbers
- 07 Boundary hedge or climbing plants
- 08 External terrace
- 09 Vegetable garden
- 10 Paved thresholds
- 11 Permeable drive
- 12 Gravel path
- 13 Secret garden
- 14 Proposed mixed shrubs, perennials, climbers
- 15 Existing lawn
- 16 Existing entrance
- 17 New railing



Illustrative plan, not to scale

1.0 Landscape Concept

1.2 Tree Strategy

Key

-  Hedges and trees proposed for removal:
T15, H01, T19, T20, T21
-  Existing trees to be retained
-  Root protection areas
-  Proposed trees

Refer to the arboricultural statement for details about proposed works within the RPAs, tree protection and removal drawings.

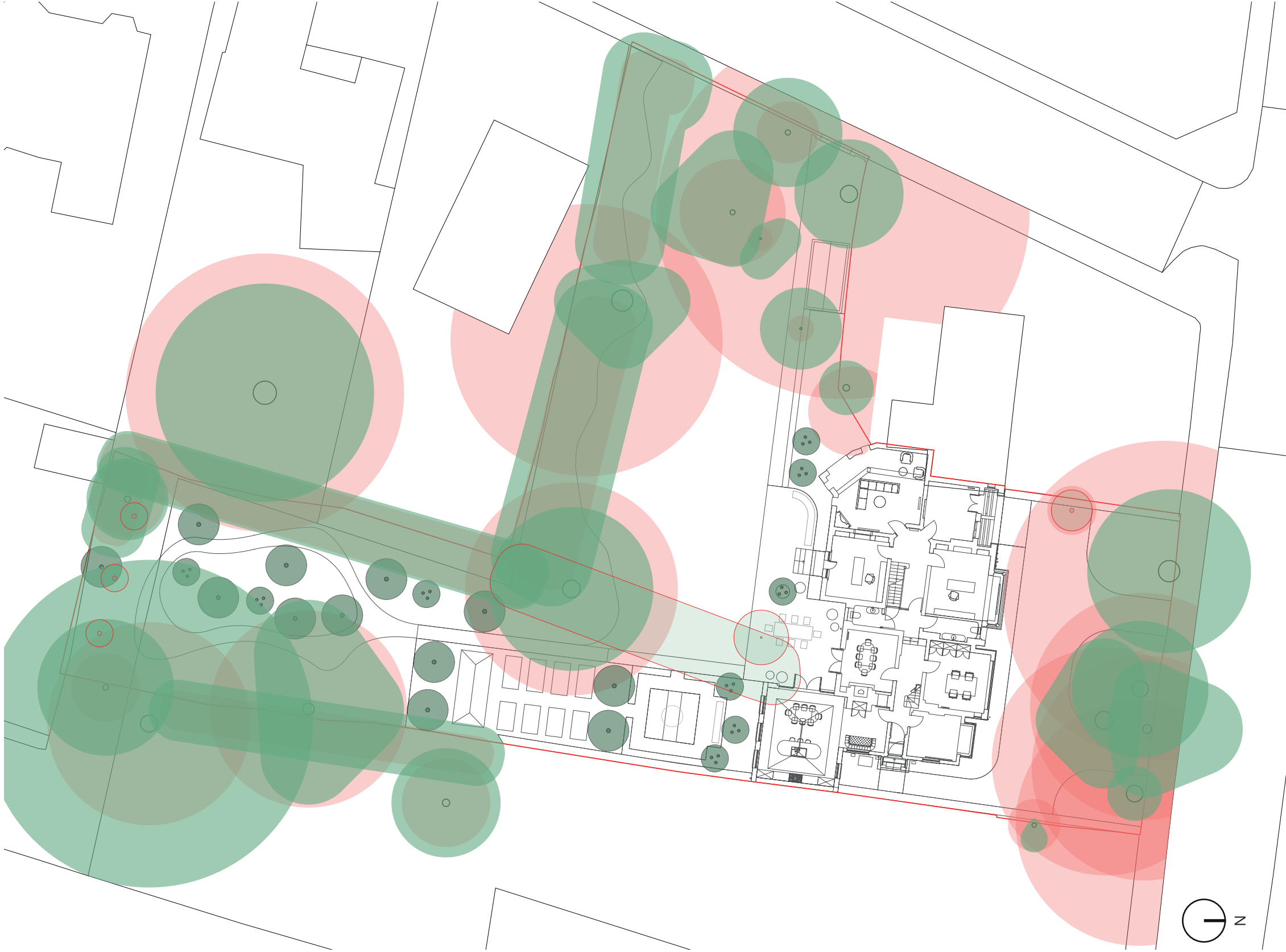

Tree planting plan, not to scale

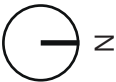

1.0 Landscape Concept

1.3 Planting strategy

We aim to maintain the natural charm of the garden, support local biodiversity, and create a great setting for various family activities. By keeping most of the existing trees, and enhancing their setting with new planting and trees, the garden will not only look mature from day one, but will ensure continuity and health of the current ecosystem.

For the planting beds, we propose a mixture of perennials and shrubs to increase biodiversity and create a variety of habitats for pollinators and invertebrates. For colour, form and extending blooming periods, we propose a mixture of native and non-native species to increase the resilience of the garden, as non-native species will have different tolerances to diseases, pests, or extreme weather conditions. Additionally, a blend of native and non-native plants will extend ensure continuous colour and beauty throughout the year.

We also propose porous hard surfaces in the garden to prevent water pooling, reduce flooding risk, promote groundwater recharge, improve soil health, and reduce the need for artificial drainage systems.



External seating areas surrounded by planting



Mixed shrubs, perennials, climbers against the building facade



Mixed perennials, shrubs and multistem trees

1.0 Landscape Concept

1.4 Reference Images



Stone paved terrace



Vegetable garden



Mixed layered vegetation



Informal gravel paths



Fire pit area



Building surrounded by mixed planting



Natural playground