

CROWN STREET

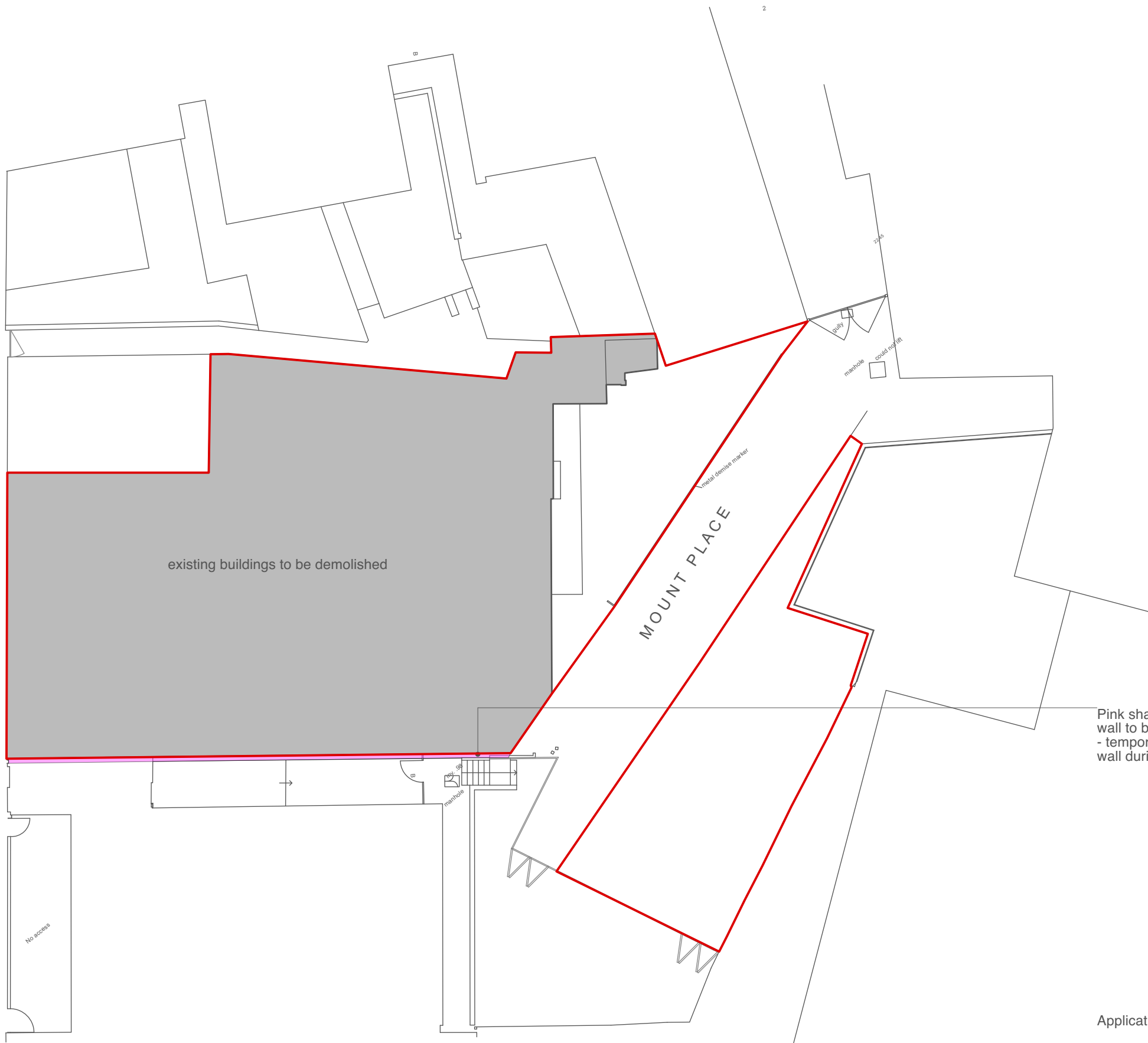

existing buildings to be demolished

MOUNT PLACE

Pink shaded wall indicates existing party wall to be retained.
- temporary works required to stabilise wall during construction.

Application site area: 586sqm as defined by redline

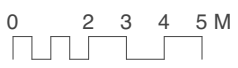
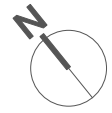

7394
1 Mount Place and 6-8 Crown Street, W3

Notes	No.	Date	Revision Notes
This drawing is for planning purposes only. Do not scale off the drawing. Use figured dimensions only.			

existing site plan
P002
1:200 @ A3
23/07/2021

rbstudio architects
studio 01, 11 Crawshaw Road, Poole BH14 8QZ
01202 700032
rbstudio.co.uk | office.rbstudio@mac.com