

Section through Sensory Bridging Room, Wetroom and Store

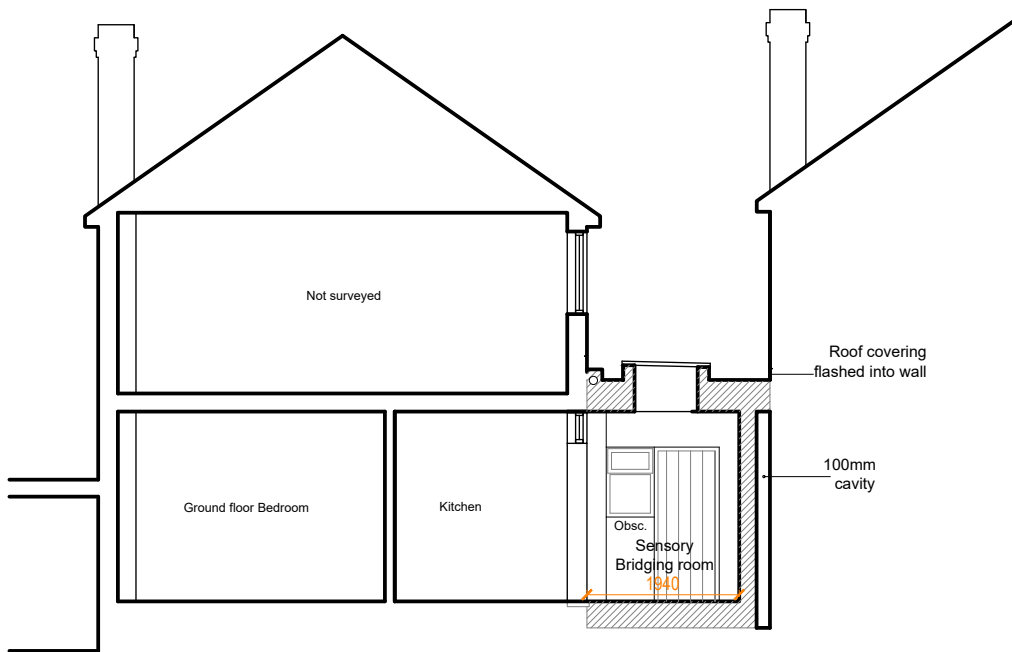

Section through Bedroom, Kitchen and Sensory Bridging Room

Revisions
 A - 21/02/24 - Rooflights revised



<p>JULIAN OWEN ASSOCIATES ARCHITECTS 276 Queens Road Beeston, Nottingham NG9 2BD</p> <p>t 0115 922 9831 f 0115 922 4616 e enquiries@julianowen.co.uk www.julianowen.co.uk</p>		<p>All Dimensions are Approximate Do Not Scale Directly From the Drawing All Dimensions to be Checked and Confirmed on Site Read In Conjunction with the Specification</p>
		<p>Job: Greensmith / Woodthorpe</p> <p>Title: Proposed Sections</p> <p>Date: Feb 2024 Scale: 1:100</p> <p>Drawing Size: A4</p> <p>Drawing No: 2494/07_A</p>