

Westhorpe Road
Existing Block Plan 1:200

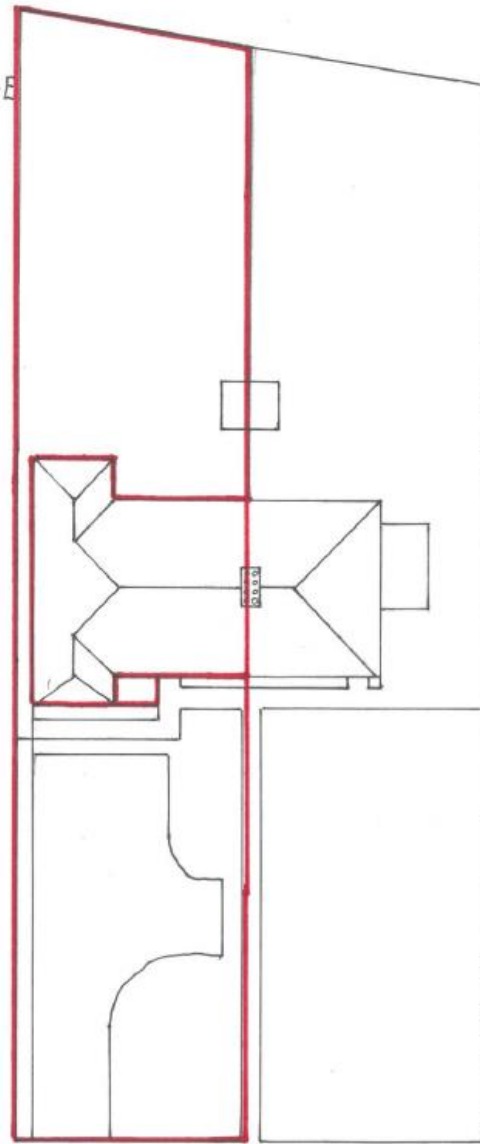

Westhorpe Road
Proposed Block Plan 1:200

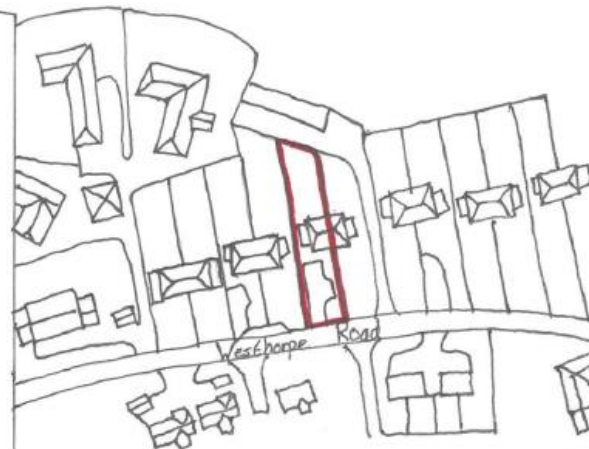

Existing Location Plan 1:1250

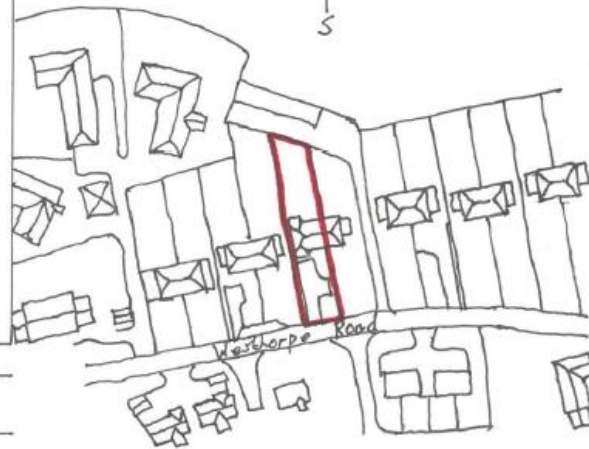
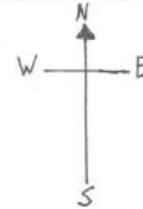

Proposed Location Plan 1:1250

Client and Agent

Mr and Mrs Lummis
7 Council houses
Westhorpe Road
Finningham
Stowmarket
Suffolk
IP14 4TN

Mobile: 07956343579

Email:
broadfieldcarpentry@gmail.
com

Job Title

Proposed two story side
extension

- Elevations 1:100
- Floor plans 1:50
- Block plans 1:200
- Location plan 1:1250

Drawn: SAL

Date: 21/08/2023

Drawing no. STL 001