

The contractor is responsible for checking dimensions, tolerances and references. Any discrepancy to be verified with the Architect before proceeding with the works. Where an item is covered by drawings to different scales the larger scale drawing is to be worked to.

Do not scale drawing. Figured dimensions to be worked to in all cases.

CDM REGULATIONS 2015. All current drawings and specifications for the project must be read in conjunction with the Designer's Hazard and Environment Assessment Record

All intellectual property rights reserved.

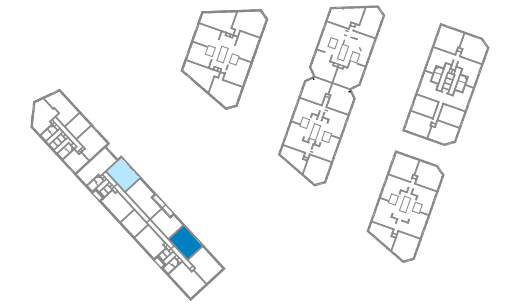

<b>Dwelling Type</b>	<b>23009 - Accessible dwelling</b>
<b>Total Area:</b>	<b>74.8 sqm</b>
<b>Tenure:</b>	<b>TARGET RENT</b>
<b>Storage:</b>	<b>2.0 sqm</b>

Min. AREA required for ALL dwellings (1 storey only)		Min. GENERAL STORAGE required for ALL dwellings	
NDSS / BH		NDSS	/ BH
1B1P	39 sqm - bath 37 sqm - shower	1B1P	1.0 sqm
1B2P	50 sqm	1B2P	1.5 sqm
2B3P	61 sqm	2B3P	2.0 sqm
	66 sqm + shower		
2B4P	70 sqm	2B4P	2.0 sqm
3B4P	74 sqm	3B4P	2.5 sqm
3B5P	86 sqm	3B5P	2.5 sqm

P00 2024-03	Issued for Planning	CC	CF
Rev	Date	Description	Dwn Ckd

**BA10030 RAR D&K Blocks**  
Proposed Dwelling Type 23009 WCH

**Z429- PRP01- STW- ZZ- DR- A-880-152**  
**FOR PLANNING** **REV P00**

Drawn CC Checked CF Date 2024-03 Scale @ A3 1:50