

USE FIGURED DIMENSIONS ONLY. DO NOT SCALE FROM THIS DRAWING EXCEPT FOR PLANNING PURPOSES. ALL DIMENSIONS MUST BE CHECKED ON SITE. ANY INCONSISTENCIES MUST BE REPORTED BACK TO THE ARCHITECT. THIS DRAWING AND ANY DESIGNS INDICATED THEREON ARE THE COPYRIGHT OF BROOKS MURRAY ARCHITECTS. ALL RIGHTS ARE RESERVED. NO PART OF THIS WORK MAY BE PRODUCED WITHOUT PRIOR PERMISSION IN WRITING FROM BROOKS MURRAY ARCHITECTS. THESE DRAWINGS ARE INTENDED FOR PLANNING PURPOSES ONLY. THEY ARE NOT TO BE USED FOR BUILDING, AND IF THEY ARE, THIS WILL BE IN BREACH OF BROOKS MURRAY'S COPYRIGHT.

REV.	AMENDMENT	BY:	DATE
-			



Brooks Murray Architects
 41 Tabernacle Street, London, EC2A 4AA
 +44 (0)2077399955 architects@brooksmurray.com



CLIENT:
 Grovebury Southgate LTD
 JOB:
 Grovebury Court
 London
 N14 4JR
 DRAWING TITLE:
 Existing West Elevation

SCALE:
 1:100@A3
 DATE:
 February 2024
 STATUS:
 Permitted Development

DRAWING NUMBER: 1357.01.021
 REV: TS
 ISSUED BY: TS

Existing West Elevation
 1:100 @ A3

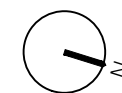
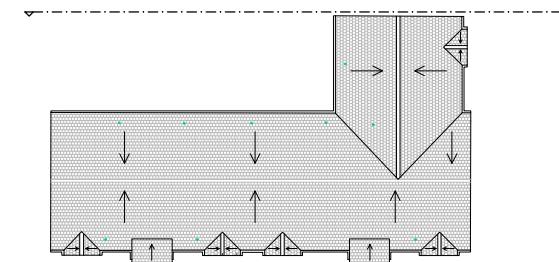
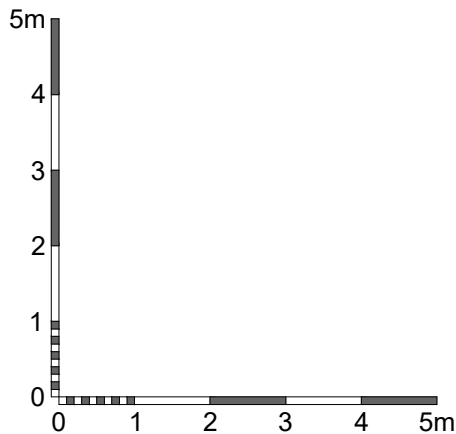

Reference Plan
 1:500 @ A3