

CONSTRUCTION

Notes
All dimensions to be checked on site prior to commencement of any works.
Refer any discrepancies to the architect.

See drawing nos. 22_404 C 031 - 035 for stair and balustrade construction details

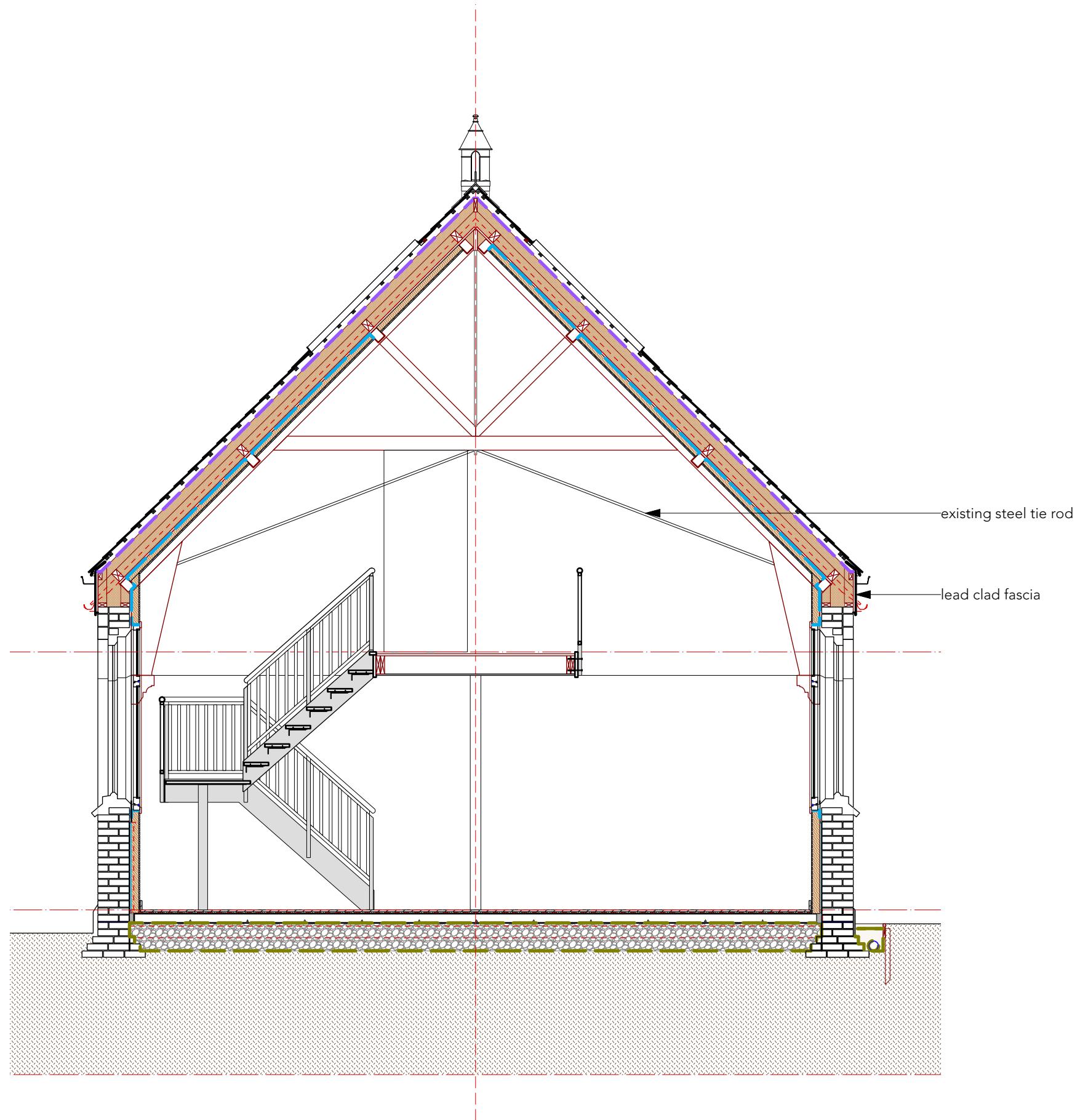

C3	17.02.24	Solitex membrane replaced by Powerlon UltraPerm breathable roofing underlay	AG
C2	14.08.23	Stair design amended	AG
C1	29.05.23	Initial construction issue	AG
Rev	Date	Amendment	By Chkd

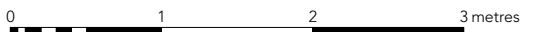

Proposed section C

Proposed conversion to dwelling
Former Methodist Chapel, The Street, Braughing, Herts SG11 6RD

Scale 1:50 @ A3 Date May 2023 Drawing no. 22_404 | L | 021_C3

Good Architecture
 90 Ware Road, Hertford SG13 7HN
 T: +44 (0)1992 501073
 contact@goodarchitecture.co.uk
 www.goodarchitecture.co.uk