

MASSING STUDY (NTS)

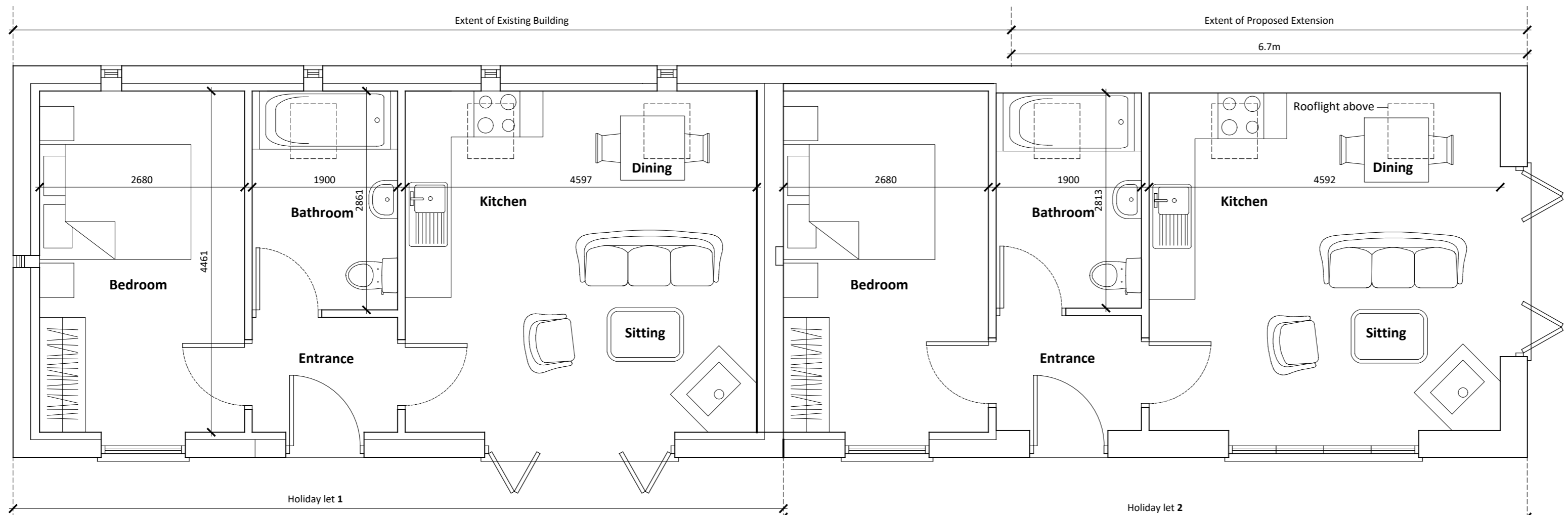

FLOOR PLAN 1:50

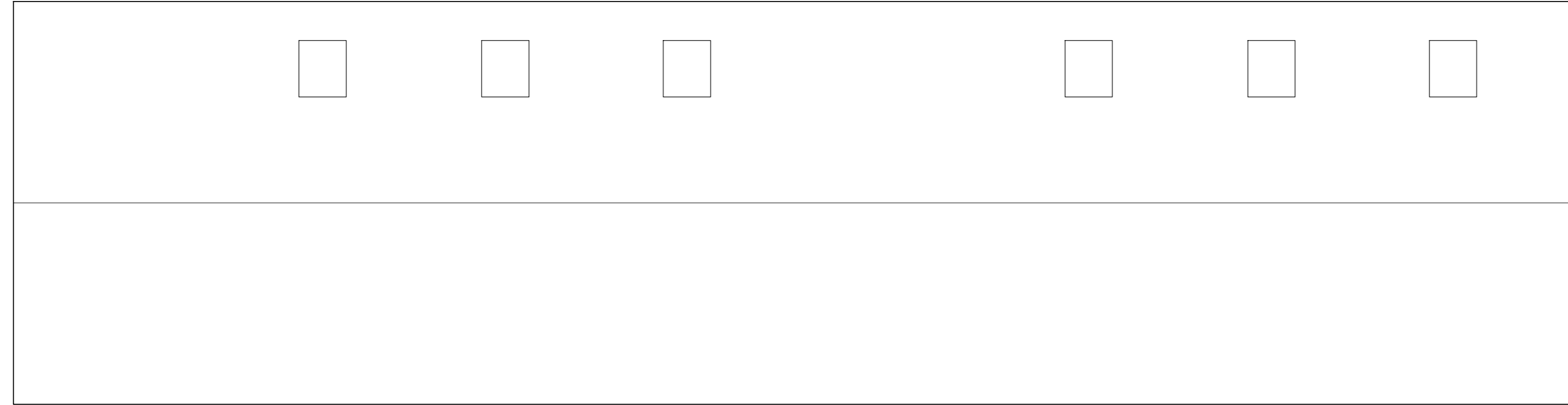

ROOF PLAN 1:50

PROPOSED BUILDING FABRIC

Existing solid ground floor to be upgraded to achieve a minimum **U-value of 0.10W/m²K**.

New ground floor to achieve a minimum **U-value of 0.10W/m²K**.

Existing solid external walls to be upgraded to achieve a minimum **U-value of 0.15W/m²K**.

New external walls to achieve a minimum **U-value of 0.13W/m²K**.

Existing pitched roof to be upgraded to achieve a minimum **U-value of 0.11W/m²K**.

New pitched roof to achieve a minimum **U-value of 0.10W/m²K**.

Window and door openings to incorporate approved high-performance triple glazed units and to achieve a minimum **U-value of 0.80W/m²K**.

The proposed buildings have an **air tightness target of 4.99**.

Extract ventilation to Bathrooms to be provided by a mechanical vent ducted to external air to provide **minimum 15 l/s extraction**.

Extract ventilation to Kitchen to be provided by mechanical ventilation with an **extract rating of 60 l/s, or 30 l/s if hob adjacent to external opening window**.

Internal doors to be provided with a 10mm gap below the door to aid circulation.

Purge Ventilation to be provided. Hinged / pivot windows with an opening angle of 15-30° to have an openable area in excess 1/10 of the floor area of the room.

external doors and sash/hinged/pivot windows with an opening angle of equal to or greater than 30° to have an openable area in excess of 1/20 of the floor area of the room.

Purge ventilation to be capable of extracting at least 4 air changes per hour per room directly to the outside.

Controllable **background ventilation** to be provided to all habitable rooms and Kitchens at a rate of **minimum 10,000mm²**, and to Bathrooms at a rate of **minimum 4000mm²**.

CONTINUITY OF INSULATION AND THERMAL BRIDGING

Care shall be taken to limit the occurrence of thermal bridging in the insulation layers caused by gaps within the thermal element, i.e. around windows and door openings. The building fabric to be constructed so that the insulation is reasonably continuous across newly built elements.

Before elements are concealed, photographs of the details and an on-site audit to be undertaken to confirm that the designed details have been constructed in line with the guidance in Appendix B of Approved Document L.

Notes

Copyright
© Robert Doughty Consultancy Limited.
All rights described in the Copyright, Designs and Patents Act 1988 have been asserted.

Ordnance Survey Map
© Crown Copyright. OS Licence No: AR 100010613.

Dimensions
All dimensions shown are for the purposes of obtaining the relevant planning permission only.

CDM 2015
This drawing is for illustrative purposes and/or obtaining the relevant planning permission only. It should not be used for construction and accordingly, risk identification under the Construction (Design & Management) Regulations 2015 has not been undertaken.

- B ASHP & PV panels removed building 28.02.24 fabric note included
- A Solar PV @ 26% roof coverage 20.11.23 indicated, also ASHP indicated

Rev	Description	Date

rdc
Robert Doughty Consultancy

32 High Street, Helpringham
Sleaford, Lincolnshire, NG34 0RA

Tel: 01529 421646
Email: admin@rdc-landplan.co.uk
Web: www.rdc-landplan.co.uk

Client
Mr Paul Pocklington

Project
2 Fen Road,
Little Hale

Drawing
Proposed Plans

Scale @ A2 1: 50	Date 21/07/23
----------------------------	-------------------------

Drawn By JG/ WW	Checked By -
---------------------------	------------------------

Job Number 1576-1	Status PL	Purpose of Issue Planning
-----------------------------	---------------------	-------------------------------------

Drawing No. 1576-1_PL_PL01	Rev B
--------------------------------------	-----------------