

GROUND FLOOR PLAN

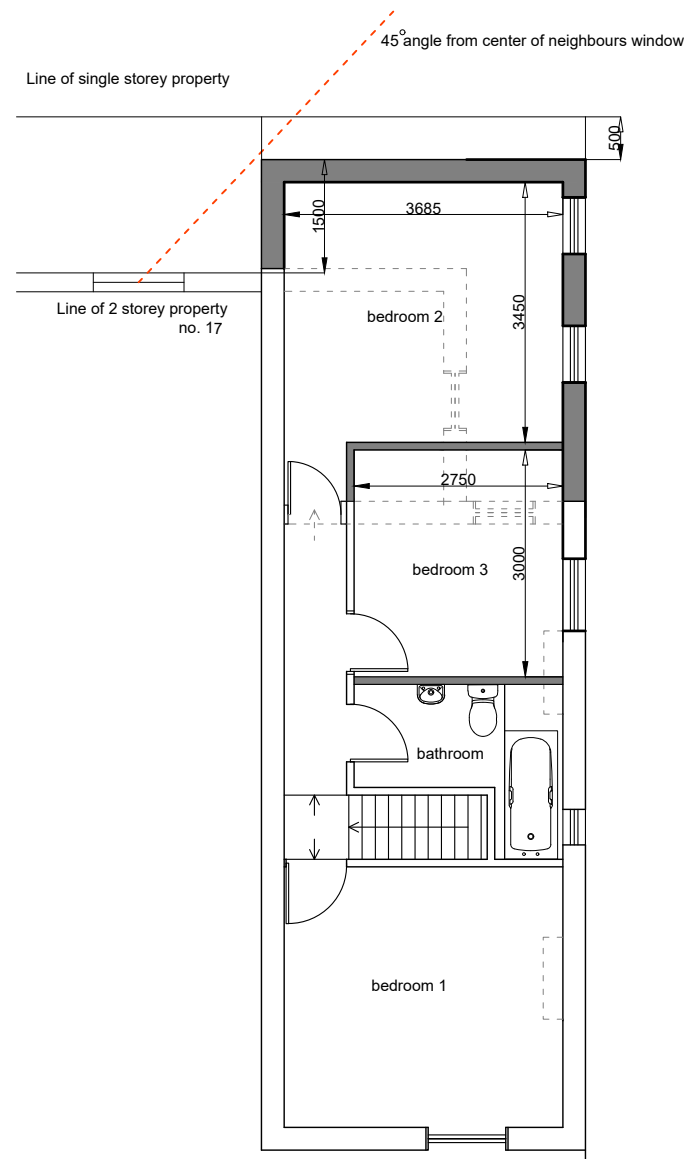

FIRST FLOOR PLAN

Disclaimer:
This drawing's copyright belongs to Norwich Architects
It cannot be used or copied by any other consultant

All dimensions are to be checked and confirmed on site prior to commencing work.
Only use indicated dimensions, do not scale from this drawing

Ensure all pre-commencement Planning Conditions are discharged prior to commencing work on site.

Ensure any CIL Payments are completed prior to commencing work on site.

Ensure CDM 2015 Requirements have been fulfilled prior to commencing work on site.

- E. Minor amendments to LPA's request.
 - D. 45° angle of neighbours window added
 - C. Additional information added
 - B. Additional information added
 - A. Minor amendments to Client's request.
- Rev.



Dragon House
22 Unthank Road
Norwich
NR2 2RA
mob: 07810332098
email: nigel.cooper@norwicharchitects.com

Client :
Mr J. Ewles

Project :
19 Low Road, Drayton, Norwich

Drawing Title:
Proposed Floor Plans

Project No. NA-0051	Scale 1:100
Drawing No. LRD-N-03 E	Date August 2020