



P :: PROPOSED REAR ELEVATION

8 scale: 1:50

0 1m 5m

PROPOSED AMENDMENT TO
 WARRANT FOR
 MR AND MRS N. BROADHURST
 4 ST ANDREWS DRIVE
 LAW
 ML8 5GB

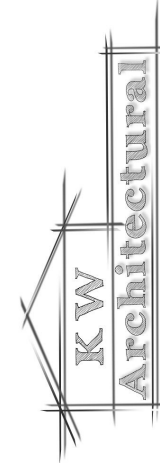

NOTE: THESE DRAWINGS IN FULL ARE TO BE USED FOR THE PURPOSE OF OBTAINMENT OF LOCAL AUTHORITY APPROVALS I.E. PLANNING PERMISSION AND BUILDING WARRANTS ONLY WHERE APPLICABLE AND TO BE USED FOR GUIDANCE ONLY. IT IS THE CONTRACTORS RESPONSIBILITY FOR FINAL MEASUREMENTS OF ALL NECESSARY SIZES AND RESPONSIBILITY FOR CORRECTNESS AND COMPLETENESS OF HIS OWN MEASUREMENTS NOT WITHSTANDING THE APPROVAL OF THE DESIGNER AND OR BUILDING STANDARDS SURVEYOR. LEVELS AND SPECIFICATIONS ARE TO BE VERIFIED PRIOR TO COMMENCEMENT OF WORKS AND PURCHASING OF GOODS. DRAWINGS HAVE BEEN DONE IN ACCORDANCE WITH SITE SURVEY. NO RESPONSIBILITY SHALL BE HELD FOR GAS, WATER SUPPLY AND DISCHARGE SERVICES WHICH ARE WITHIN FOOTPRINT OF PROPOSED WORKS AND ANY SPECIALIST FOUNDATIONS REQUIREMENTS, LEVELS AND MEASUREMENTS TAKEN AND ALSO POSITIONING OF BOUNDARY LINES. IT IS THE CLIENTS RESPONSIBILITY TO ENSURE THAT BOUNDARY LINES NOTED ON DRAWINGS ARE CORRECT BEFORE WORK COMMENCEMENT DO NOT SCALE OFF DRAWINGS

revisions:
 door to front elevation of extension replaced with window, additional glass installed to roof, opening between extension and kitchen relocated to extension to lounge. wall insulation altered