

Notes

Figured dimensions are to be used in all cases.
Dimensions should not be scaled from drawing unless for planning application purposes.

Land Registry and ownership boundaries are produced by Studio KMA using all reasonable endeavors. Studio KMA cannot be held responsible for scale discrepancies in plans supplied by others.

Any discrepancies in dimensions should be clarified with the Architect at the address below prior to commencement of the works.

No deviation from this drawing will be permitted without the prior written consent of the Architect.

This drawing is to be read in conjunction with all the relevant Mechanical and Electrical drawings.

This drawing is to be read in conjunction with the relevant Structural Engineer's drawings, structural calculations and recommendations.

This drawing is to be read in conjunction with the relevant Fire Safety Strategy drawings.

Please note that the use of any quantification data is done so at the users own risk.

This drawing is the copyright of Studio KMA and to be returned to the Architect on completion of the contract. The drawing should not be reproduced without the written permission of Studio KMA.

Revision Notes			
Rev	Date	Revision Description	Drawn / Checked
P1	14.02.24	Initial Issue	CB / RH

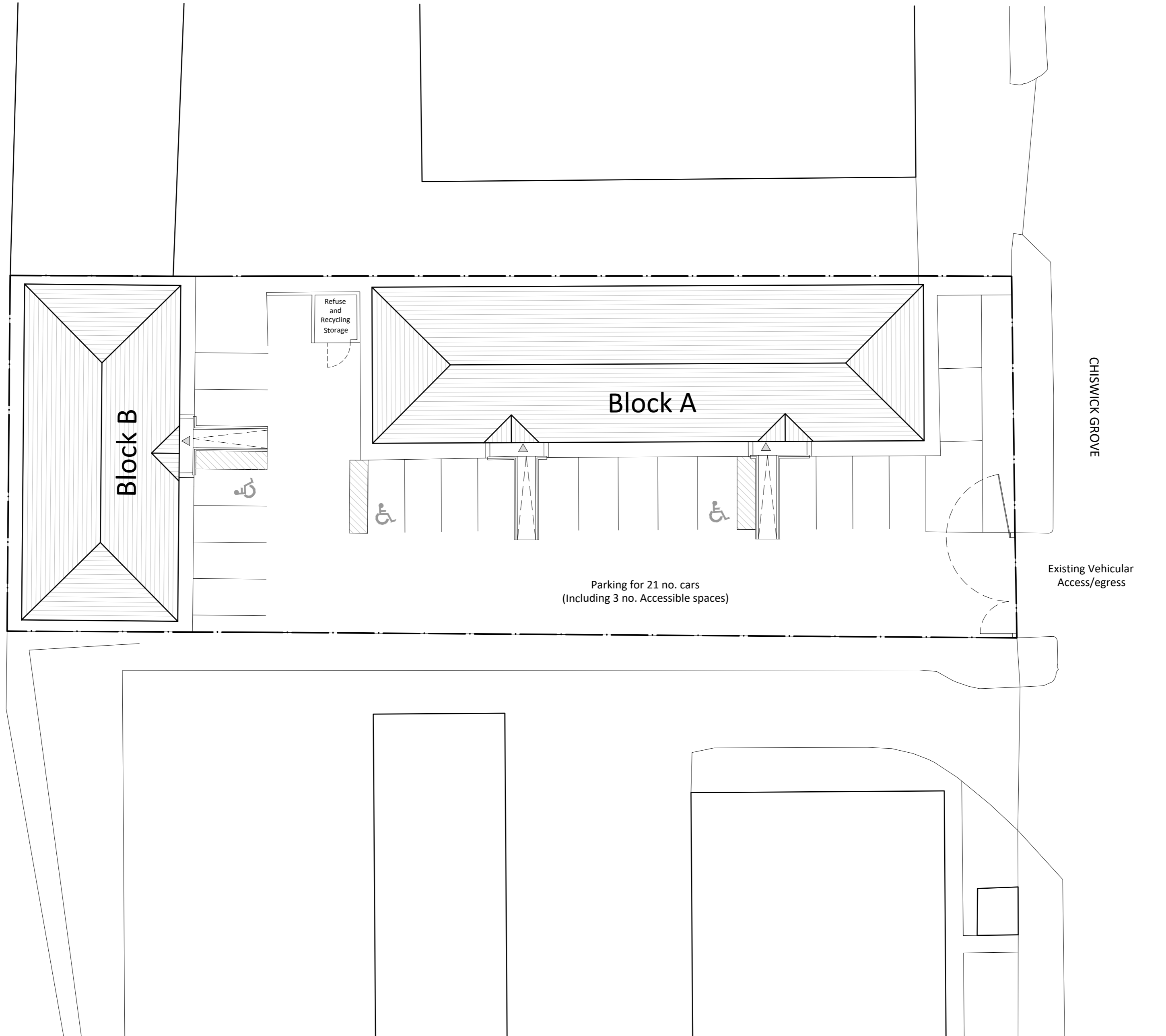

Project Name
**Blackpool
Chiswick Grove**

Drawing Title
**Existing
Site Plan**

Drawing Number
BCG-KMA-XX-XX-DR-A-7002

Project Number T1195	Status A1 Planning	Revision P1
--------------------------------	----------------------------------	-----------------------

Drawn by CB	Authorised by RH	Date 14.02.24
-----------------------	----------------------------	-------------------------

Studio KMA
Clarence Arcade | Stamford Street | Ashton-under-Lyne | OL6 7PT
T: 01457 873165
E: info@studiokma.co.uk www.studiokma.co.uk