

This drawing is purely for discussion purposes only. It is not to be taken as a proposal for construction detailing, and instead it is primarily intended to convey the overall spatial layout of the building or parts of it. Please refer to the developed production information drawings for detail, construction and measurement purposes.

Do not scale from this drawing for construction or acquisition purposes. Responsibility is not accepted for errors made by others in scaling from this drawing. All construction information must be taken from figured dimensions only. All dimensions and levels must be checked on site and discrepancies between drawings and specification must be reported to GSSArchitecture. © Copyright GSSArchitecture. Ordnance Survey © Crown Copyright 2022. All rights reserved. Licence number GSS 100017356. Map Data Copyright 2022 Google. Registered Office: 35 Headlands, Kettering, Northants, NN15 7ES. Tel: 01536 513 165. Email: gss@gotch.co.uk.

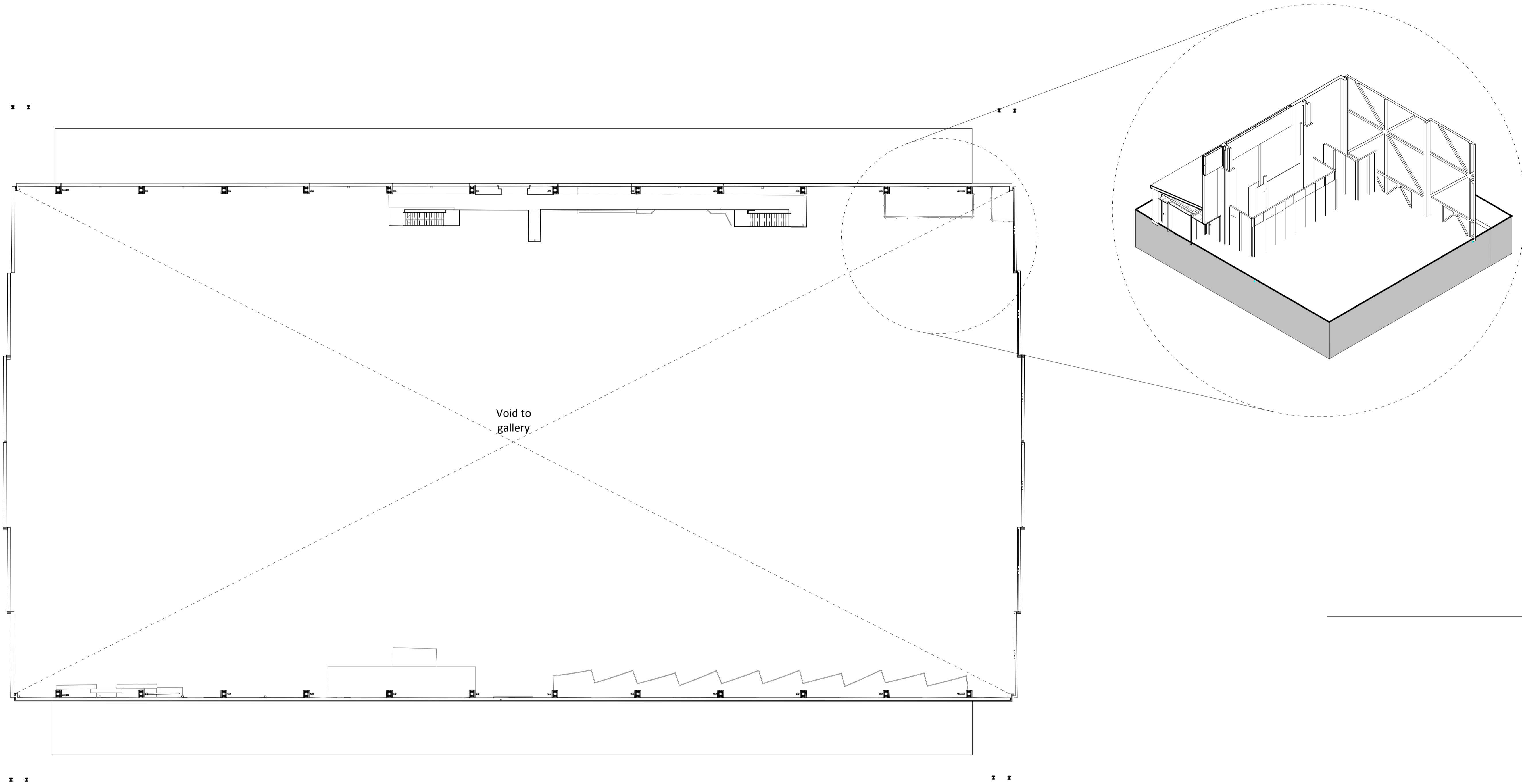

**1. Existing Mezzanine Floor Plan**  
**SCALE - 1 : 200@A1**

1:200 Scale 0 2m 4m 10m 20m

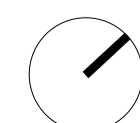

Rev	Date	Dwn	Chk	Description
-----	------	-----	-----	-------------

**GSSarchitecture**  
 KETTERING | HARRGATE | GLOUCESTER | MILTON KEYNES | NEWCASTLE

Project Title:  
 RAF Museum Midlands Development Programme

Client:  
 RAF Museum

Drawing Title:  
 Hangar 1 - Existing Mezzanine Floor Plan

Drawn By: WRLC    Checked By: TEJ    Scale @A1: 1 : 200    Date: 31/07/23

Status: Preliminary Issue    File No: R117A

Draw No: (S)002    Rev: