

Existing internal wall finishes to north east road facing wall to be carefully removed and taken back to stone walling face. Stone wall face to then receive traditional lime render finish in hope of allowing wall to 'breathe' and hopefully mitigate the existing damp issues that are present to this side of the property.

New stair construction to consist of painted softwood including newel posts, spindles, handrail using traditional mouldings.

Existing lightweight cupboard to be removed and new stud wall / shower enclosure built to cover existing WC to a shower room.

New non-load bearing timber stud lining to be applied internally with acoustic insulation filled between and acoustic plasterboard applied over to create an acoustic room for the purposes of playing musical instruments - final specification of acoustic makeup to be coordinated with specialist manufacturers.

**WINDOW REPLACEMENT WORKS**  
All windows indicated with an associated window reference number [format wx.x] are to be carefully removed and replaced with new painted timber flush casement double glazed windows and all to match the existing window design in terms of glazed panel sizes.  
Note 1: Conservation double glazed units to be used.  
Note 2: Refer to window drawing W\_10 for typical details.

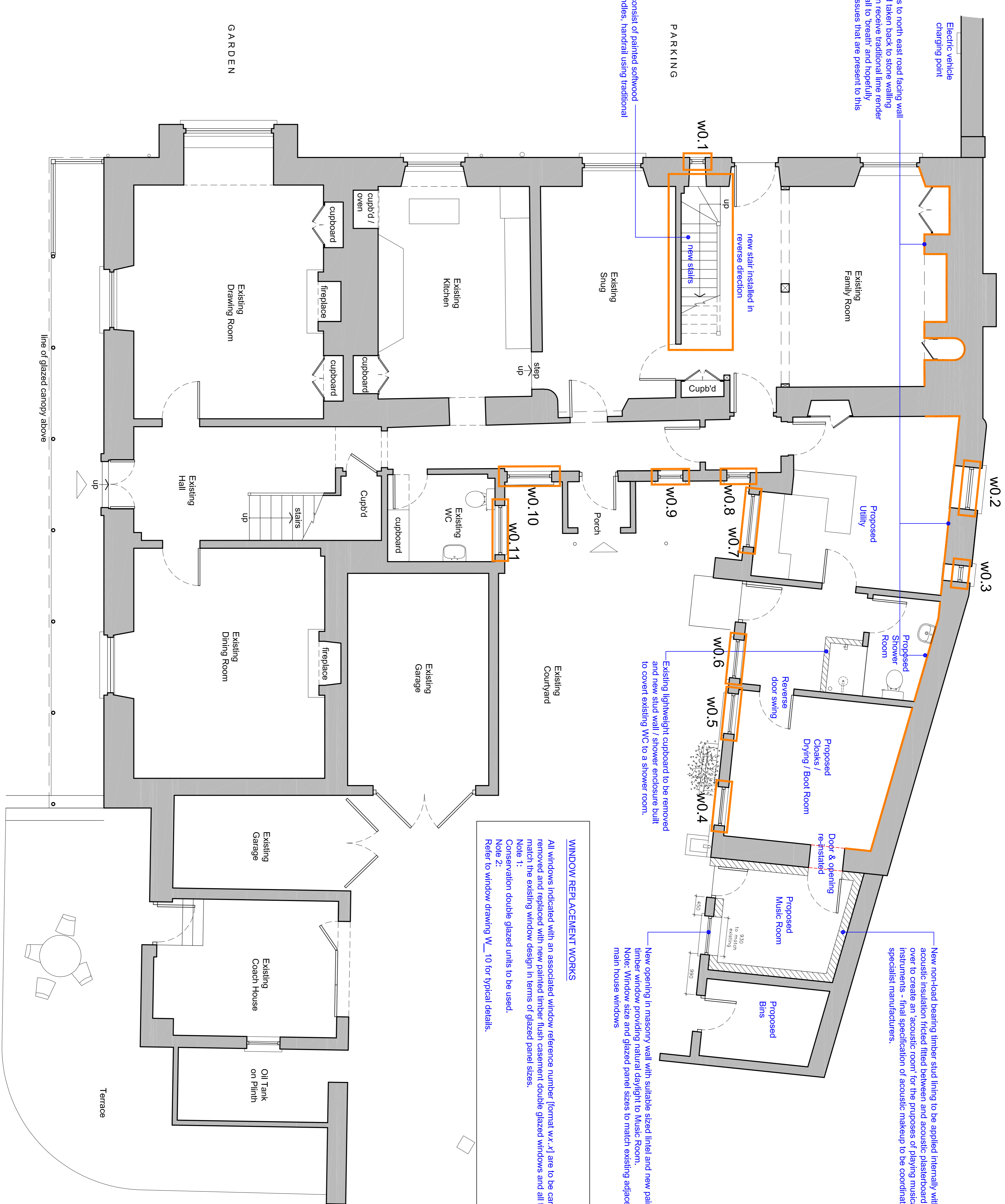

Location / Project	Craddock Lodge, Craddock, Devon, EX15 3LL. Listed Building Renovations to Grade II Listed County House.		
Drawn by	DH	Checked by	RA
Scale	1:50 at A1		
Date	Mar 2024		



Drawing Title: **PLANNING & LISTED BUILDING**  
Proposed Ground Floor Plan

Revision	Date	Note	Author
24.41			
Project Number	Drawing number		Revision
24.41	P_00		



www.atkinsonarchitects.co.uk  
5 Aze Rice, Plymouth, Devon, PL4 4QP  
01752 312 06  
RIBA Accredited Practice &  
RIBA Accredited Conservation Architects  
Copyright AA Ltd. All Rights Reserved.