

NOTE:
All glazing to be sealed using Hodgson Sealants Professional Sifix
U9 low modulus neutral cure silicone sealant

New painted Iroko traditional solid hardwood timber framed casement window with lambs tongue frame detailing with conservation double glazed low e units

Painted plaster internal window reveal

Internal frame, mullion and transom mouldings to be lambs tongue frame detailing

Linseed oil based glaziers putty

12mm overall conservation double glazed low e units consisting of:
4mm inner pane low emissivity glass (Pilkington I) X
4mm argon filled void with matt white coated aluminium perimeter spacing frame
4mm outer pane of clear glass.

Painted render finish to walls and reveals

Linseed oil based glaziers putty

Conservation glazing bars

Internal frame, mullion and transom mouldings to be lambs tongue frame detailing

External frame, mullion and transom traditional bevelled edge hardwood glazing piece set with linseed oil based glaziers putty.

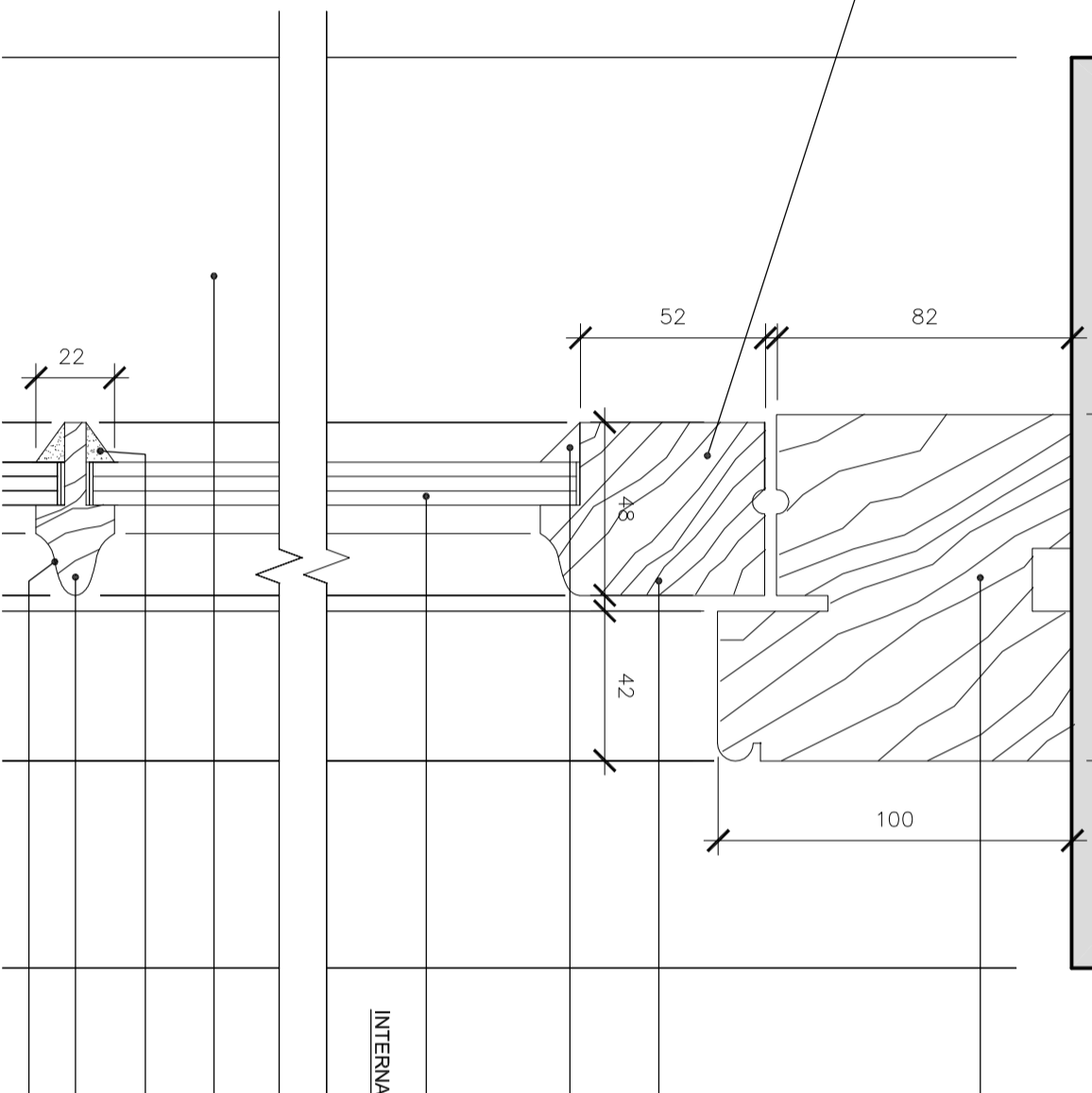

EXTERNAL

INTERNAL

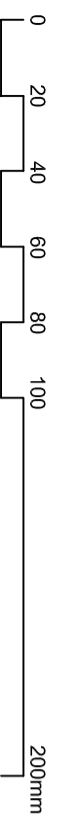

Location / Project

Craddock Lodge, Craddock, Devon, EX15 3LL.
Listed Building Renovations to Grade II Listed
Country House.

Date

Mar 2024

Drawn by

DH

Checked by

RA

Scale

1:2 at A3

Drawing Title

Replacement Windows - Timber Casement Head Detail (window w0.4)

PLANNING & LISTED BUILDING

Revision | Date | Note

Author

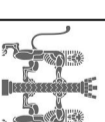

www.atkinsonarchitects.co.uk
5 Acce Place, Plymouth, Devon, PL1 4QP
01752 312 616
RIBA Chartered Practice &
RIBA Accredited Conservation Architects
Copyright AA Ltd. All Rights Reserved.



Project Number

24.41

Drawing number

W_12

Revision

.