

GROUND FLOOR PLAN
Sc.1:100

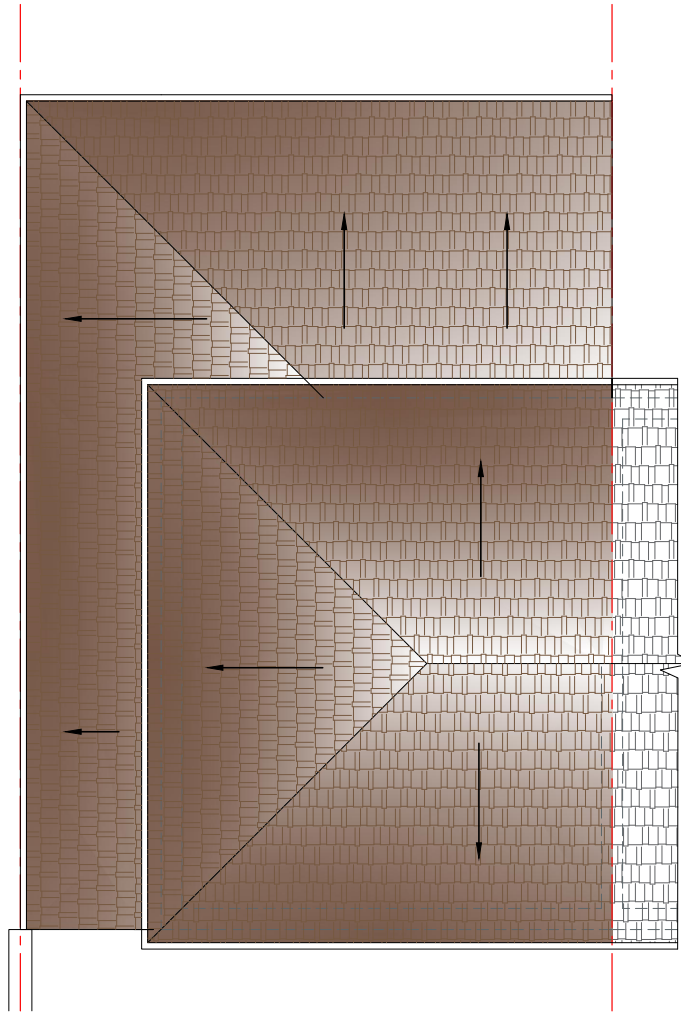

ROOF PLAN
Sc.1:100

NOTES:

- EXISTING DEVELOPMENT CLOAKROOM WINDOW TO BE FROSTED

NOTES:

- THE CONTRACTOR IS TO CHECK AND VERIFY ALL DIMENSIONS AND LEVELS PRIOR WORK COMMENCING
- THE CONTRACTOR IS TO COMPLY WITH ALL CURRENT BUILDING LEGISLATION WHETHER OR NOT SPECIFICALLY STATED ON THIS DRAWING.
- PLANNING PROPOSALS ARE FOR ILLUSTRATIVE PURPOSES ONLY AND AS SUCH ARE SUBJECT TO DETAILED SITE INVESTIGATION.

This drawing is not for CONSTRUCTION purposes. If no dimension is given, we take no responsibility for any dimension obtained by measuring or scaling from this drawing. This drawing is the property of Maplin Studio Limited. It is copyright protected and is not to be reproduced, disclosed or copied without written permission.

Reference drawings					
Drawing No.	Rev	Drawing title			
0	PROPOSED PLANS	AP	OM	TA	20/02/2024
Rev	Description	Drawn by	Checked by	Appd by	Date
Please check scale bar before scaling this drawing				A3	Scale (at full size)
0	1	2	3		

Project		GROUND FLOOR EXTENSION	
Location		153 LIMESIDE ROAD, OLDHAM OL8 3LT	
Title		PROPOSED PLANS	
<small>Office 203b, Us&Co Stratford, 11 Burford Rd, London E15 2ST Tel. +44(0)203 475544 projects@maplinworld.com</small>			
Dwg No.	Phase:	Sheet	Rev.
MS13603	PLANNING	1 of 1	0