

1 | 1:100  
Section AA

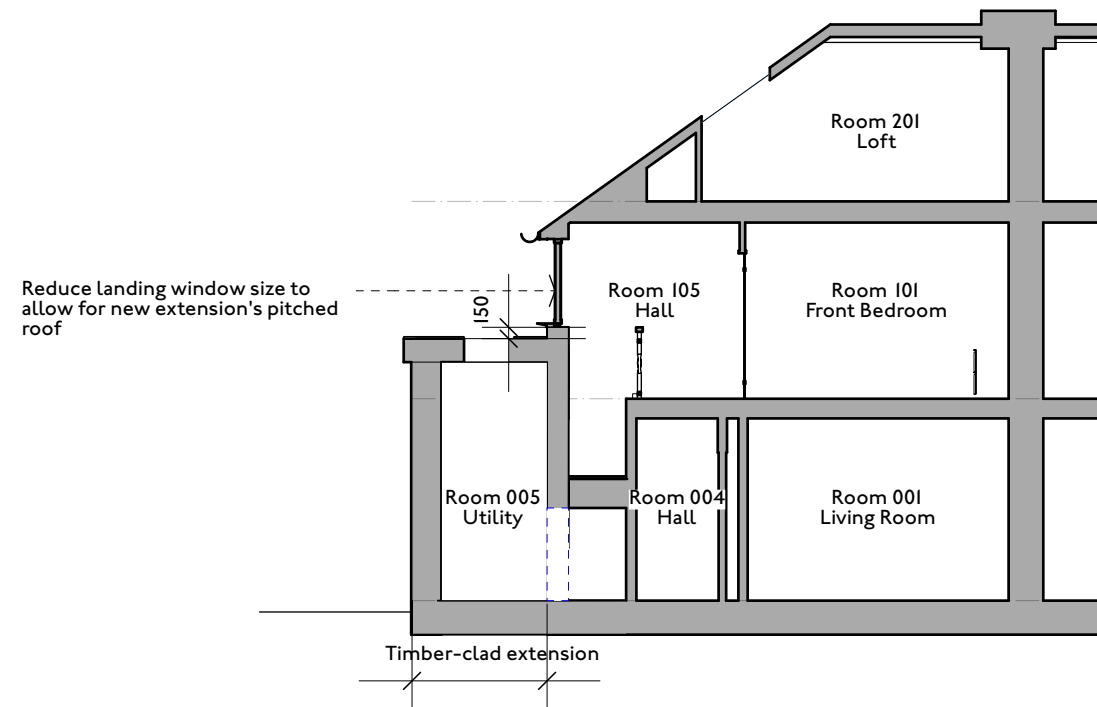

2 | 1:100  
Section BB

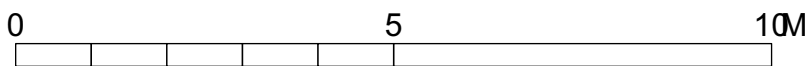

**HEM**  
ARCHITECTS

Parkhead House, Carver Street,  
 Sheffield, S1 4FS  
 0114 442 0123  
 hemarchitects.co.uk  
 hello@hemarchitects.co.uk

Scale @ A3: 1:100

Purpose: For Information

Status: S2 Revision: P5

Drawn: GR Checked: HM

P5 01/03/24 GR Finish between bay window updated  
 P4 28/02/24 GR Rooflights, PV and ASHP added

**Melville Grove**  
Proposed Sections

Client: Brian Ford & Sally Holmes

Drawing No: H2343-HEM-00-ZZ-DR-A-00110