

1 | 1:100
Section AA

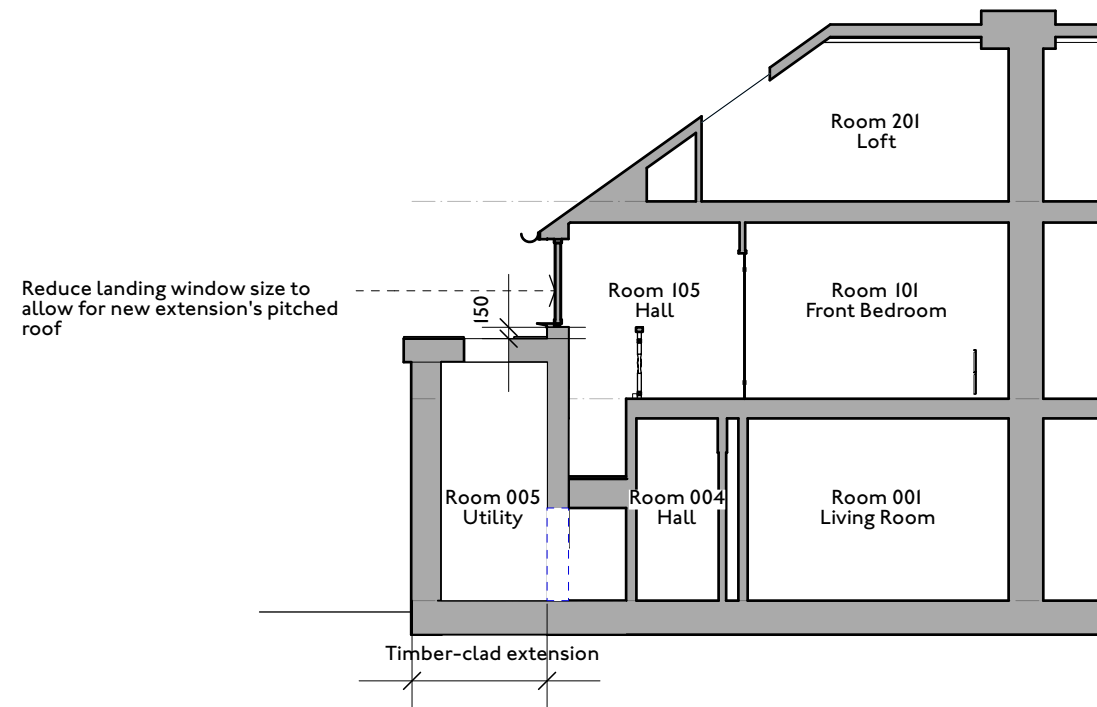

2 | 1:100
Section BB

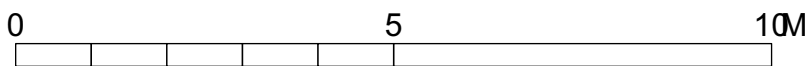

HEM
ARCHITECTS

Parkhead House, Carver Street,
 Sheffield, S1 4FS
 0114 442 0123
 hemarchitects.co.uk
 hello@hemarchitects.co.uk

Scale @ A3: 1:100

Purpose: For Information

Status: S1 Revision: P4

Drawn: GR Checked: HM

P4 28/02/24 GR
 P3 26/02/24 GR

Rooflights, PV and ASHP added
 Initial planning set update

Melville Grove
Proposed Sections

Client: Brian Ford & Sally Holmes

Drawing No: H2343-HEM-00-ZZ-DR-A-00110