

Materials to match existing:  
 Roof: Concrete roof tiles  
 Walls: Clay bricks  
 Doors: White Aluminium  
 Windows: White UPVC

Any dismantling of any portion of the existing structure should follow Construction Design Management (CDM2015) and Health and Safety regulations. Any works to/near footings should take care not to damage any underground services possibly existing and new footings formed to S.Eng's specification. Lintels as specified by S.E. to take new openings.

NOTE: Office finished floor level is higher than the main house, therefore a Building Regulation compliant step is to be formed at the point indicated on this drawing.

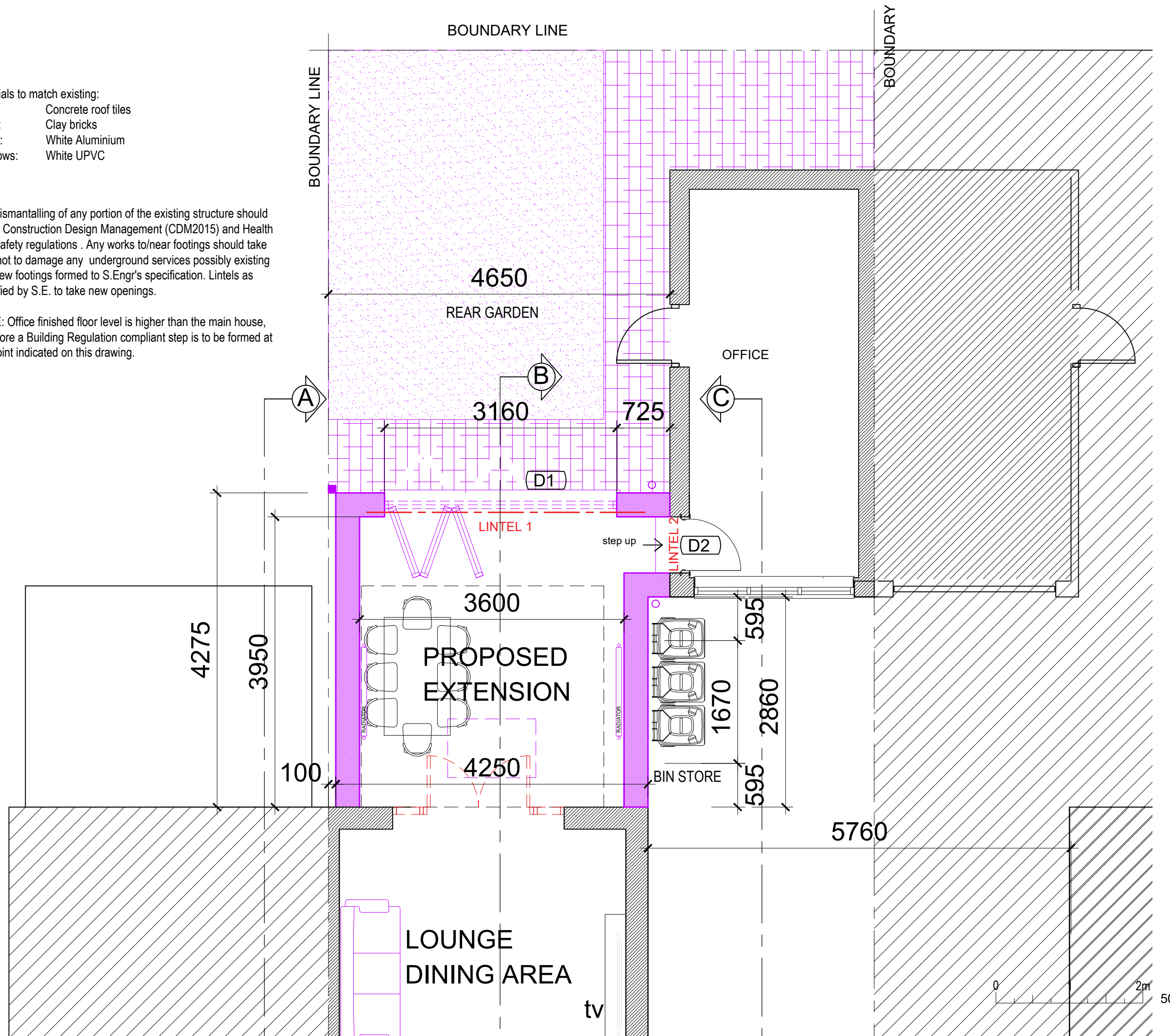

- NOTES :
- This drawing is copyright.
  - All dimensions must be checked on site before any works commence.
  - All discrepancies are to be reported to the CA before works proceed.
  - Only figured dimensions are to be used.

© COPYRIGHT E Badu A & D Ltd  
 NOT TO BE REPRODUCED WITHOUT WRITTEN PERMISSION.  
 BECAUSE OF POSSIBLE SCALING ERRORS IN ELECTRONIC AND HARD COPY REPRODUCTION DO NOT SCALE FOR CONSTRUCTION PURPOSES. ALL DIMENSIONS TO BE CHECKED & VERIFIED ON SITE PRIOR TO CONSTRUCTION.

Rev	By	Description	Date	CHKD
				
<b>ERNEST BADU</b> Bsc. (Hons) Dip. (Hons) ARB 11 Northfield Rd, Borehamwood, Hertfordshire, WD6 5AE M: 07564 692080 ebaduarchitectanddesigner@gmail.com				
CLIENT				
Mr & Mrs Anthony & Jennifer Solomon				
PROJECT ADDRESS				
5 BENNINGTON DRIVE BOREHAMWOOD WD6 4QN				
PROJECT				
SINGLE STOREY REAR EXTENSION.				
DRAWING TITLE				
PROPOSED GROUND FLOOR PLAN, 1:50.				
DRAWN BY: EB		DATE: 15/03/24		
CHECKED: EB		SCALE: 1:50 @ A3		
PROJECT No.	SHEET No.	Applic. Type	REV.	
2311	8	P	A	
PROJECT STAGE: PLANNING				
CLIENT SIGN OFF SIGNATURE:			DATE:	