

PROPOSED DOORS - SECTION SCALE 1:10

PROPOSED DOORS - NORTH ELEVATION SCALE 1:10

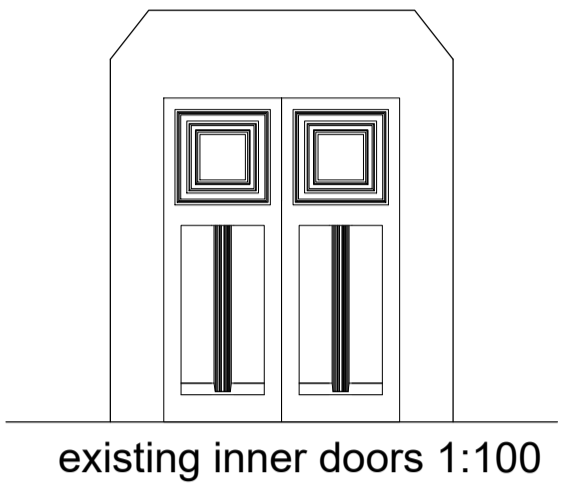

existing inner doors 1:100

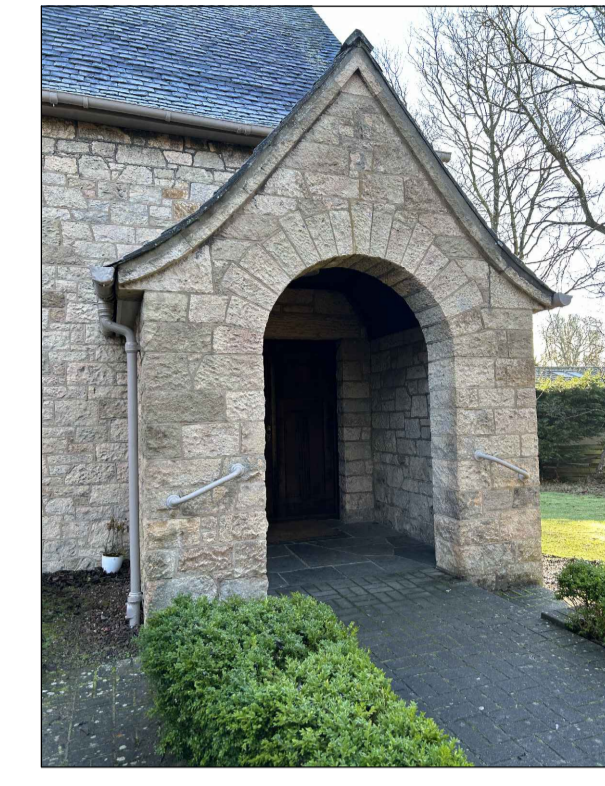
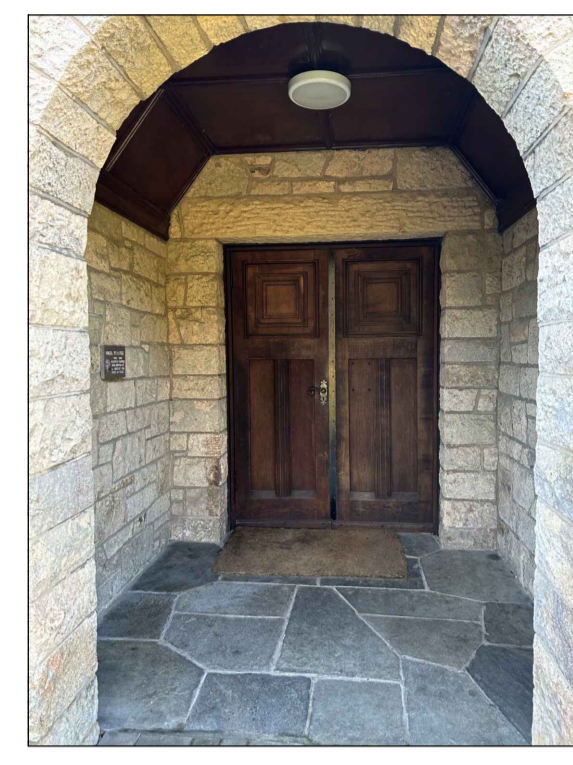

proposed new half rebated double outer doors:  
FSC Certified oak; clear finish;  
60mm thick with fielded panels  
all to match existing

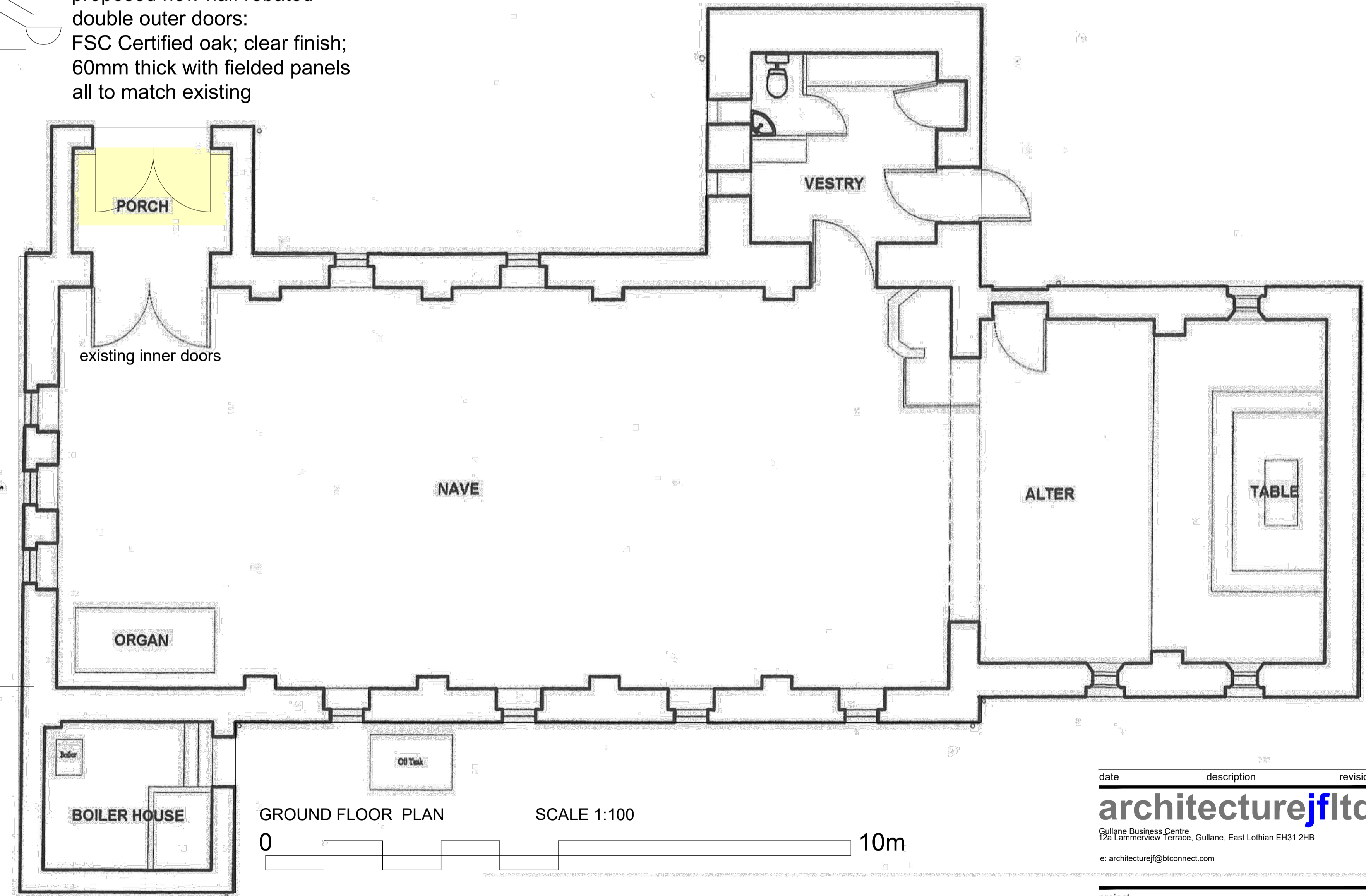

PORCH

existing inner doors

NAVE

VESTRY

ALTER

TABLE

ORGAN

BOILER HOUSE

GROUND FLOOR PLAN

SCALE 1:100

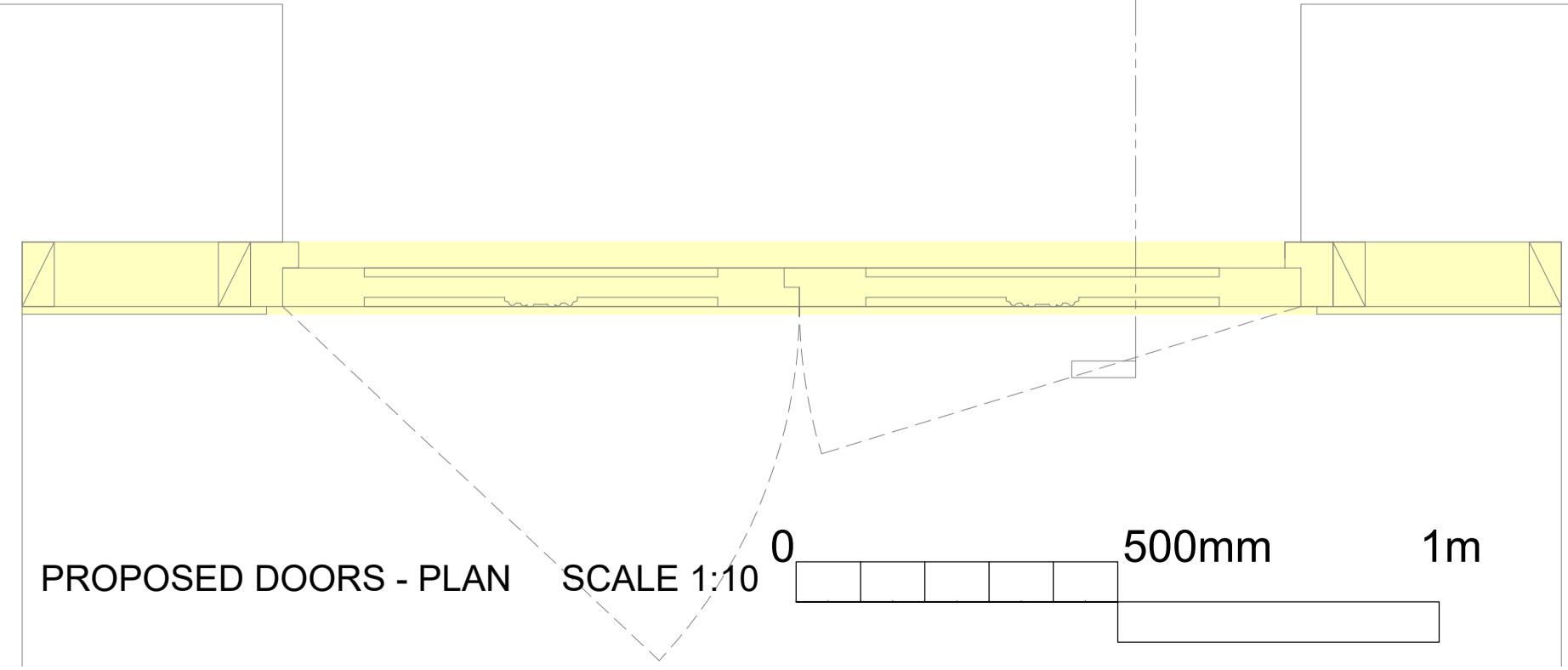
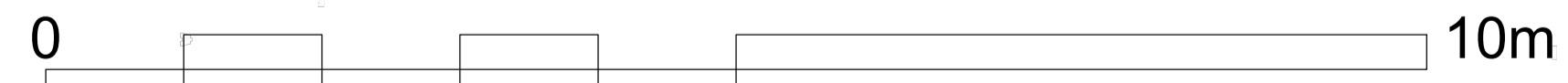

PROPOSED DOORS - PLAN SCALE 1:10

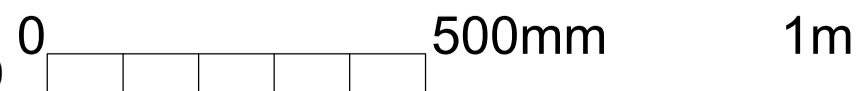

date	description	revision

**architecturejftd**

Gullane Business Centre  
12a Lammervue Terrace, Gullane, East Lothian EH31 2HB  
e: architecturejftd@btconnect.com

project	date	drawn	approved
proposed new doors St. Adrians Church Gullane			
drawing Plans, Elevations, photos			
scale 1:100 & 1:10 @A1	date Mar 24	drawn jf	approved
project no. 21:38	drawing no. AL(0)01	revision	